

# VARIOSUB D-SUB 25

## Contact Inserts, Sleeve Housings

---

### Introduction

VARIOSUB is a range of plug connectors specially designed for signal and data technology in an industrial environment with high degrees of protection, temperatures and mechanical stress. The range is characterized by the simple Push-Pull locking mechanism, use of conventional D-SUB contact inserts, IP 67 protection and EMC protection.

The VARIOSUB housings offer the space and time-saving Push-Pull locking, which snaps in with a noticeable click. Two integrated lamellar cable screw connections for cable diameters of 5 - 13 mm provide high cable strain relief.

When locked, the housings fulfill the requirements of IP 67 protection, and require only little operating force thanks to a special profile gasket.

Red snap-in profiles offer up to 16 coding possibilities to avoid incorrect plugging. Marker labeling is also provided for. An internal metal sleeve and shroud on the panel mounting base provide optional EMC protection. Simple logistics due to the small number of individual components and high functionality of the housings help to save costs and increase availability. Mounting flanges on the panel mounting base accept the contact inserts. This allows internal and external wall mounting of the contact inserts.

The male and female inserts in D-SUB 25 format enable 25 data lines up to  $0.35 \text{ mm}^2$  conductor cross section or 15 lines with  $0.5 \text{ mm}^2$  conductor cross section to be connected. The connection points are clearly numbered. This facilitates any start-up under field conditions.

Industrial connectors are available for the sleeve and mounting side. They are made with screw connection, for soldering onto printed circuit boards, with a flat-ribbon cable connection and for crimp contacts. For currents up to 40 A or in combination with signal lines, two versions are available as male and female connectors. The use of these plug connectors saves space on the inside of the device. The contacts are equipped with U-grooves for manual solder connection and cover the maximum possible cross section range.



**VARIOSUB D-SUB 25**  
**Contact Inserts**  
**Screw Connection**

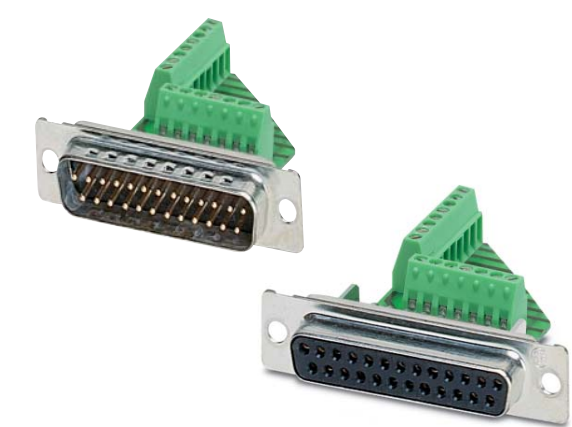

Description	Type	Order No.	Pcs./Pkt.
<b>Male contact inserts,</b> with PCB and 25 x MPT 0,5 screw connections	VS-25-ST-DSUB/25-MPT-0,5	16 89 78 9	10
<b>Female contact inserts,</b> with PCB and 25 x MPT 0,5 screw connections	VS-25-BU-DSUB/25-MPT-0,5	16 89 77 6	10
<b>Technical data</b>			
<b>Mechanical data</b>			
Insertion force per signal contact	[N]	≤ 3.3	
Extraction force per signal contact	[N]	≤ 2.2	
Insertion/withdrawal cycles		≥ 200	
<b>Material and surfaces</b>			
Insulating body		PBTP	
Contact material		Cu alloy	
Contact surface		Ni/Au	
<b>Electrical data</b>			
Max. amperage	[A]	1	
Operating voltage	[V]	63	
Contact resistance per contact pair	[mΩ]	≤ 2.5	
Insulation resistance	[MΩ]	≥ 5000	
<b>Thermal and climatic data</b>			
Temperature range	[°C]	- 20 to + 70	

# **VARIOSUB D-SUB 25** **Contact Inserts** **Solder Connection**



Description	Type	Order No.	Pcs./Pkt.
<b>Male contact inserts,</b> solder connection, 25-pos., with straight solder pins, with hole	VS-25-ST-DSUB-EG	16 89 89 9	10
<b>Female contact inserts,</b> solder connection, 25-pos., with straight solder pins, with hole	VS-25-BU-DSUB-EG	16 89 90 9	10
<b>Male contact inserts,</b> solder connection, 25-pos., with angled solder pins, with thread	VS-25-ST-DSUB-ER	16 89 87 3	10
<b>Female contact inserts,</b> solder connection, 25-pos., with angled solder pins, with thread	VS-25-BU-DSUB-ER	16 89 88 6	10
<b>Technical data</b>			
<b>Mechanical data</b>			
Insertion force per signal contact	[N]	≤ 3.3	
Extraction force per signal contact	[N]	≤ 2.2	
Insertion/withdrawal cycles		≥ 200	
<b>Material and surfaces</b>			
Insulating body		PBTP	
Contact material		Cu alloy	
Contact surface		Ni/Au	
<b>Electrical data</b>			
Max. amperage	[A]	1	
Operating voltage	[V]	63	
Contact resistance per contact pair	[mΩ]	≤ 2.5	
Insulation resistance	[MΩ]	≥ 5000	
<b>Thermal and climatic data</b>			
Temperature range	[°C]	- 55 to + 125	

# **VARIOSUB D-SUB 25** **Contact Inserts** **Flat-Ribbon Cable Connection**



Description	Type	Order No.	Pcs./Pkt.
<b>Male contact inserts,</b> flat-ribbon cable connection, 25-pos., with holes	<b>VS-25-ST-DSUB-FK</b>	<b>16 89 91 2</b>	10
<b>Female contact inserts,</b> flat-ribbon cable connection, 25-pos., with holes	<b>VS-25-BU-DSUB-FK</b>	<b>16 89 92 5</b>	10
<b>Technical data</b>			
<b>Mechanical data</b>			
Insertion force per signal contact	[N]	≤ 3.3	
Extraction force per signal contact	[N]	≤ 2.2	
Insertion/withdrawal cycles		≥ 200	
<b>Material and surfaces</b>			
Insulating body		PBTP	
Contact material		Cu alloy	
Contact surface		Ni/Au	
<b>Electrical data</b>			
Max. amperage	[A]	1	
Operating voltage	[V]	63	
Contact resistance per contact pair	[mΩ]	≤ 2.5	
Insulation resistance	[MΩ]	≥ 5000	
<b>Thermal and climatic data</b>			
Temperature range	[°C]	- 55 to + 125	

# **VARIOSUB D-SUB 25** **Contact Inserts** **Crimp Connection**



Description		Type	Order No.	Pcs./Pkt.
<b>Male contact carrier,</b> crimp contact carriers, 25-pos., with thread		VS-25-ST-DSUB-CD-G	16 89 93 8	10
<b>Female contact carrier,</b> crimp contact carriers, 25-pos., with thread		VS-25-BU-DSUB-CD-G	16 89 94 1	10
<b>Male contact carrier,</b> crimp contact carriers, 25-pos., with holes		VS-25-ST-DSUB-CD-B	16 89 95 4	10
<b>Female contact carrier,</b> crimp contact carriers, 25-pos., with holes		VS-25-BU-DSUB-CD-B	16 89 96 7	10
<b>Accessories</b>				
<b>Turned male crimp contacts,</b> surface gold-plated	AWG 24-20 AWG 28-24	VS-ST-CD-1,0/14,8/0,5 VS-ST-CD-1,0/14,8/0,2	16 88 96 8 16 88 97 1	30
<b>Turned female crimp contacts,</b> surface gold-plated	AWG 24-20 AWG 28-24	VS-BU-CD-1,0/14,4/0,5 VS-BU-CD-1,0/14,4/0,2	16 88 98 4 16 88 99 7	30
<b>Technical data</b>				
<b>Mechanical data</b>				
Insertion force per signal contact	[N]	≤ 3.3		
Extraction force per signal contact	[N]	≤ 2.2		
Insertion/withdrawal cycles		≥ 200		
<b>Electrical data</b>				
Max. amperage	[A]	1		
Operating voltage	[V]	63		
Insulation resistance	[MΩ]	≥ 5000		
<b>Thermal and climatic data</b>				
Temperature range	[°C]	- 55 to + 125		

# **VARIOSUB D-SUB 25** **Contact Inserts with** **High Current Contacts** **Solder Connection**



Description	Type	Order No.	Pcs./Pkt.
<b>Male contact carrier,</b> for power contacts, 5-pos.	VS-25-ST-DSUB-5P	16 89 97 0	10
<b>Female contact carrier,</b> for power contacts, 5-pos.	VS-25-BU-DSUB-5P	16 89 98 3	10
<b>Accessories</b>			
<b>Male power contact for 20 A,</b> with U-groove solder connection	VS-ST-LK-3,6/22,4/2,6	16 88 24 3	30
<b>Female power contact for 20 A,</b> with U-groove solder connection	VS-BU-LK-3,6/22,8/2,6	16 88 25 6	30
<b>Male power contact for 40 A,</b> with U-groove solder connection	VS-ST-LK-3,6/22,4/4,6	16 88 26 9	30
<b>Female power contact for 40 A,</b> with U-groove solder connection	VS-BU-LK-3,6/22,8/4,6	16 88 27 2	30
<b>Technical data</b>			
<b>Mechanical data</b>			
Insertion/withdrawal cycles	≥ 500		
<b>Material and surfaces</b>			
Insulating body	PBTP GV (UL 94 V0)		
Housing	Steel		
Housing surface	Tin-plated		
Contact material	Cu alloy		
Contact surface	0.8 µm gold over nickel		
<b>Electrical data</b>			
Max. amperage, power contacts	[A]	20 or 40	
Operating voltage	[V]	125	
Contact resistance per contact pair	[mΩ]	≤ 2.5	
Insulation resistance	[MΩ]	≥ 5000	
Specific contact resistance	[Ωcm]	10 <sup>16</sup>	
Specific internal insulation resistance	[KV/mm]	50	
<b>Thermal and climatic data</b>			
Temperature range	[°C]	- 20 to + 80	

**Note:**  
The power contacts must be ordered separately since they are not included in the scope of supply of the contact carriers of combi contact inserts.

# **VARIOSUB D-SUB 25** **Contact Inserts with High Current** **and Signal Contacts** **Solder Connection**



Description	Type	Order No.	Pcs./Pkt.
<b>Male contact carrier,</b> for 3 power contacts, with 10 signal contacts, U-groove solder connection	VS-25-ST-DSUB-3P-10S	16 89 99 6	10
<b>Female contact carrier,</b> for 3 power contacts, with 10 signal contacts, U-groove solder connection	VS-25-BU-DSUB-3P-10S	16 90 00 8	10
<b>Accessories</b>			
<b>Male power contact for 20 A,</b> with U-groove solder connection	VS-ST-LK-3,6/22,4/2,6	16 88 24 3	30
<b>Female power contact for 20 A,</b> with U-groove solder connection	VS-BU-LK-3,6/22,8/2,6	16 88 25 6	30
<b>Male power contact for 40 A,</b> with U-groove solder connection	VS-ST-LK-3,6/22,4/4,6	16 88 26 9	30
<b>Female power contact for 40 A,</b> with U-groove solder connection	VS-BU-LK-3,6/22,8/4,6	16 88 27 2	30
<b>Technical data</b>			
<b>Mechanical data</b>			
Insertion/withdrawal cycles		≥ 500	
<b>Material and surfaces</b>			
Insulating body		PBTP GV (UL 94 V0)	
Housing		Steel	
Housing surface		Tin-plated	
Contact material		Cu alloy	
Contact surface		0.8 µm gold over nickel	
<b>Electrical data</b>			
Max. amperage, signal contacts	[A]	5	
Max. amperage, power contacts	[A]	20 or 40	
Operating voltage	[V]	125	
<b>Thermal and climatic data</b>			
Temperature range	[°C]	- 20 to + 80	

**Note:**  
The power contacts must be ordered separately since they are not included in the scope of supply of the contact carriers of combi contact inserts.

# **VARIOSUB D-SUB 25** **Sleeve Housings**



Description	Type	Order No.	Pcs./Pkt.
<b>Plastic sleeve housing,</b> with Push-Pull locking for panel mounting base, with 2 inclined M 20 lamellar screw connections, with 2 screws for fastening the contact inserts	<b>VS-25-T-2 M20</b>	<b>16 89 79 2</b>	5
<b>Accessories</b>  <b>M 20 cap nut</b> with seal for conductor diameters from 5-13 mm  <b>Cover cap,</b> for vacant M 20 screw connections  <b>Coding profile,</b> made of red plastic, mounted in the panel mounting base and sleeve housing (4 profiles for each plug connector) see Fig. 1  <b>Marker labels,</b> for snapping in  <b>EMC internal sleeve,</b> with connection clamp and screw for contacting 2 conductor screens  <b>Protective cover,</b> for covering the contact insert in the panel mounting frame or sleeve housing	<b>VS-M20 (5-13)</b>  <b>VC-PG 11 BS</b>  <b>CP-HCC 4</b>  <b>ZBN 18: UNBEDRUCKT</b>  <b>VS-25-TI-2EMV</b>  <b>VS-25-SD</b>	<b>16 52 12 7</b>  <b>16 88 14 6</b>  <b>16 00 02 7</b>  <b>28 09 12 8</b>  <b>16 89 80 2</b>  <b>16 52 21 1</b>	5  10  100  10  5  5
<b>Technical data</b> Insulation material Inflammability class acc. to UL 94 Degree of protection Temperature range	PA V0 IP 67 - 20 to + 80		

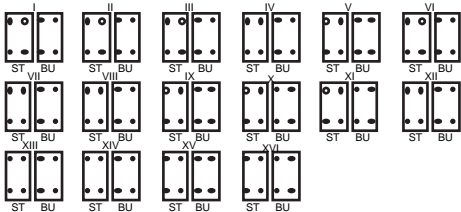
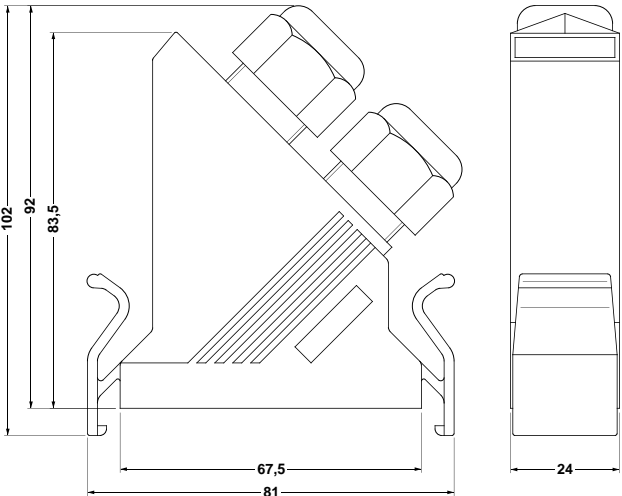

Figure 1: Coding for housings with one contact insert



VS-25-T-2 M20



# **VARIOSUB D-SUB 25** **Panel Mounting Frames**



Description	Type	Order No.	Pcs./Pkt.
<b>Plastic panel mounting frame,</b> with radially-acting profile gasket mounted, with enclosed self-adhesive flat gasket (without mounting screws on the device side)	<b>VS-25-A</b>	<b>16 89 75 0</b>	5
<b>Accessories</b> <b>EMC shroud,</b> for contacting a D-SUB contact insert on the mounting side with the outer wall of the housing <b>Protective cover,</b> for covering the contact insert in the panel mounting frame or sleeve housing	<b>VS-25-A-EMV-S</b>  <b>VS-25-SD</b>	<b>16 89 76 3</b>  <b>16 52 21 1</b>	5  5
<b>Technical data</b> Insulation material Inflammability class acc. to UL 94 Degree of protection Temperature range	PA V0 IP 67 - 20 to + 80		

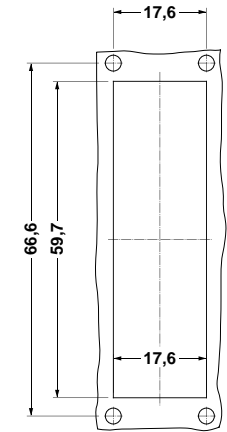

Panel cutout: VS-25-A

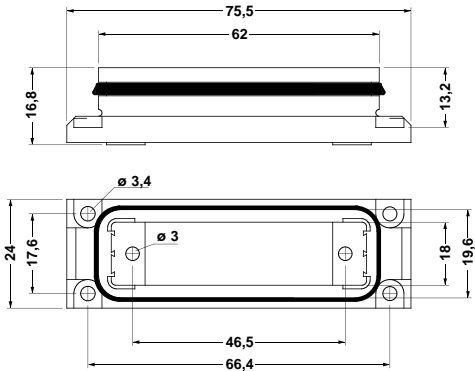

Dimensional drawing: VS-25-A

# **VARIOSUB D-SUB 25** **Panel Mounting Frames with** **Gender Changer**



The illustration shows the 9-pos. version

Description		Type	Order No.	Pcs./Pkt.
Panel mounting frame, with gender changer	Female / Female	VS-25-A-GC-BU/BU	16 89 73 4	5
Panel mounting frame, with gender changer	Male / Male	VS-25-A-GC-ST/ST	16 89 74 7	5
<b>Technical data</b>				
Insulation material		PA		
Inflammability class acc. to UL 94		V0		
Degree of protection		IP 67		
Temperature range	[°C]	- 20 to + 80		

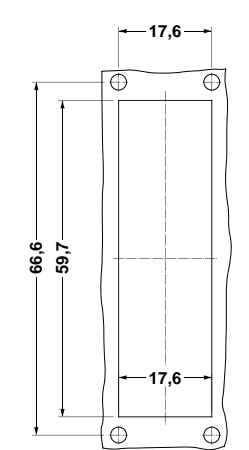

Panel cutout: VS-25-A-GC...

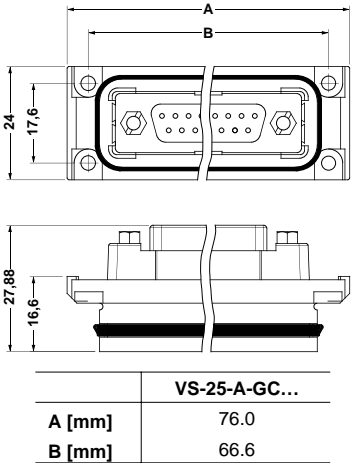

	VS-25-A-GC...
A [mm]	76.0
B [mm]	66.6

Dimensional drawing: VS-25-A-GC...

# **VARIOSUB D-SUB 25** **Couplings**



The illustration shows the 9-pos. version

Description		Type	Order No.	Pcs./Pkt.
<b>Coupling,</b> 25-pos.,	Female / Female	VS-25-KU-BU/BU	16 89 67 9	5
<b>Coupling,</b> 25-pos.	Male / Male	VS-25-KU-ST/ST	16 89 68 2	5
<b>Technical data</b>				
Insulation material		PA		
Inflammability class acc. to UL 94		V0		
Degree of protection		IP 67		
Temperature range	[°C]	- 20 to + 80		

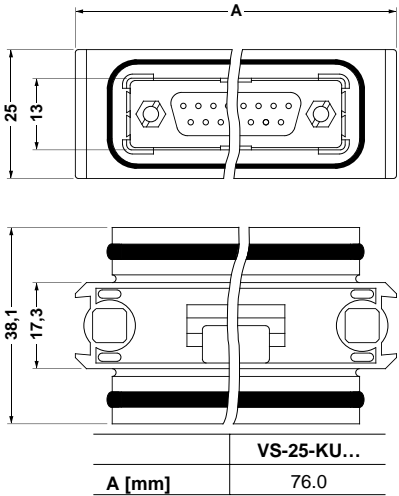

Dimensional drawing: VS-25-KU...

# **VARIOSUB D-SUB 25** **Plug Connector Sets**



Description	Type	Order No.	Pcs./Pkt.
<b>Set VARIOSUB D-SUB 25, standard version</b> for D-SUB 25 contact inserts, with Push-Pull locking, IP 67	VS-25-SET-STD	16 52 19 8	1
<b>Set VARIOSUB D-SUB 25, EMC version</b> for D-SUB 25 contact inserts, with Push-Pull locking, IP 67	VS-25-SET-EMV	16 52 20 8	1
<b>Accessories</b> <b>Protective cover,</b> for covering the contact insert in the panel mounting frame or sleeve housing	VS-25-SD	16 52 21 1	5
<b>Technical data</b> Insulation material Flammability class acc. to UL 94 Degree of protection Temperature range	PA V0 IP 67 - 20 to + 80		

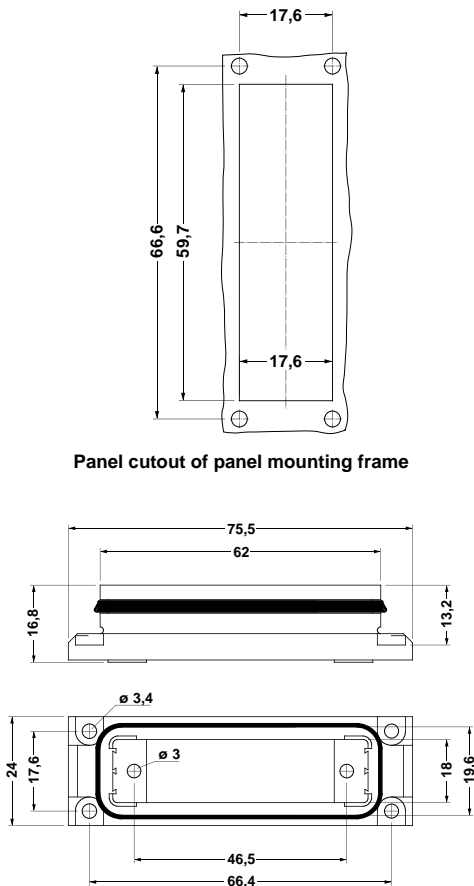

Panel cutout of panel mounting frame

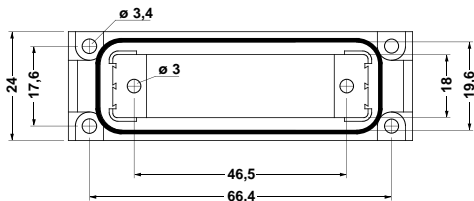
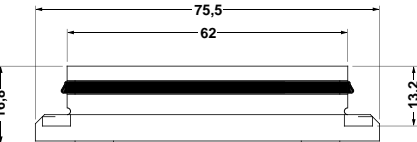

Dimensional drawing of panel mounting frame

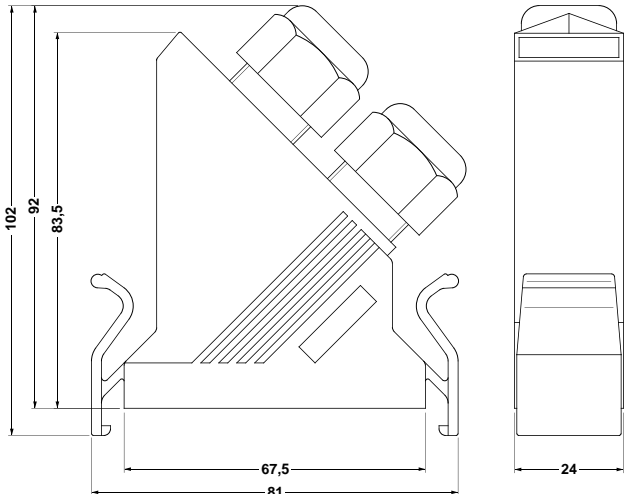

Dimensional drawing of sleeve