

Ceramic Monoblock Bandpass Filter

CTS

WIRELESS COMPONENTS

Model KFF6357A Technical Data

Features:

- Small Size
- High Performance
- SMD

Description and Applications:

This monoblock filter is designed for US PCS base station RX applications at 1880 MHz.



Electrical Specifications

| Parameters | Frequency | Specifications @ 25° C |
|---------------------|----------------------|------------------------|
| Insertion Loss | 1850 MHz to 1910 MHz | 2.4 dB max. |
| Forward Return Loss | | 10.0 dB min. |
| Attenuation | 1770 MHz | 5.0 dB min. |
| Attenuation | 1830 MHz | 5.0 dB min. |
| Attenuation | 1930 MHz | 20.0 dB min. |
| Attenuation | 1990 MHz | 20.0 dB min. |
| | | |
| Power Rating | | 1 W |
| Impedance | | 50 Ω |

NOTE: Supplier shall test each filter to the critical electrical specifications listed above or better. Any subsequent audits may deviate due to measurement repeatability among different test systems. Such deviations shall not exceed the following limits:

| Specification | Typical Allowance |
|----------------|-------------------|
| Insertion Loss | 0.1 dB |
| Return Loss | 1.0 dB |
| Stopbands | 1.0 dB |

Rev. 1

Typical Response Curve

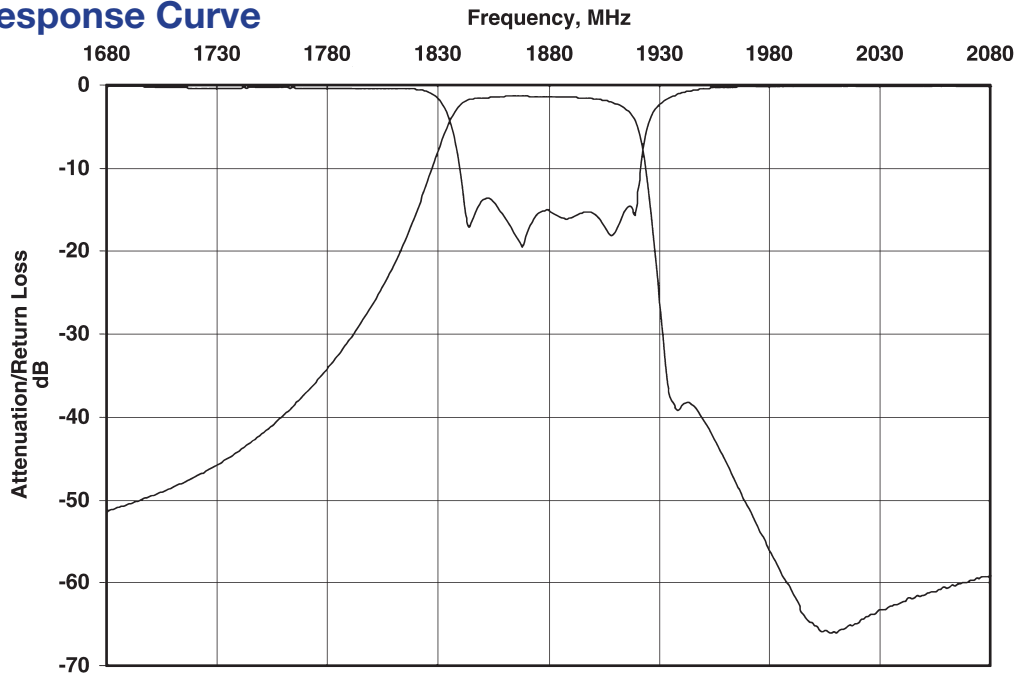

Mechanical Dimensions

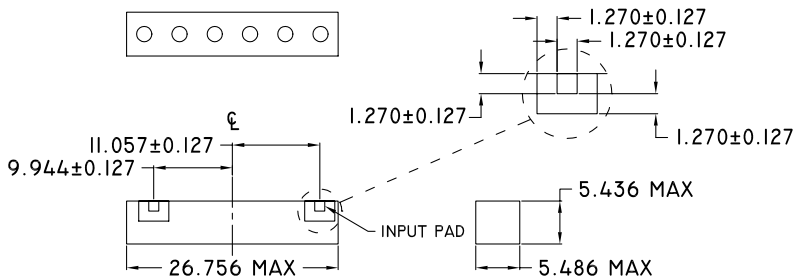

PC Board Layout

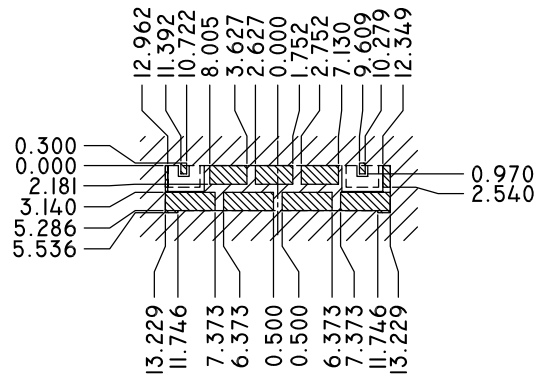

- FILTER OUTLINE
- EXPOSED CONDUCTOR
- SOLDER RESIST OVER DIELECTRIC
- SOLDER RESIST OVER CONDUCTOR
- NOTES:
1. No conductor beneath I/O gap.
 2. I/O pads 0.3 mm smaller than filter pads.
 3. I/O gaps 0.5 mm larger than filter gaps.
 4. Exposed conductor pads align to edge of filter.

Part Marking

Y = LAST DIGIT OF YEAR
WW = SEQUENTIAL WEEK NUMBER

KFF6357A
CTS

YWW

Packaging

This product is shipped in pre-formed foam trays.

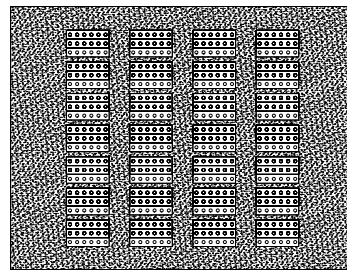

Contact Information:

CTS WIRELESS COMPONENTS INC. / 171 Covington Drive / Bloomingdale, IL 60108
PHONE: (800) 757-6686 / FAX: (630) 924-6610 / www.ctscorp.com

Document Control #6287049Y01 Rev 1

Date of Origin 03/26/01

Date of Revision 03/26/01

THIS DATA SHEET IS NOT AN OFFER FOR SALE AND SHALL NOT OBLIGATE CTS TO SELL THE PRODUCTS DESCRIBED HEREIN OR ANY OTHER PRODUCTS. CTS MAY, IN ITS SOLE DISCRETION, MODIFY OR DISCONTINUE THE SALE OF ITS PRODUCTS AT ANY TIME WITHOUT NOTICE. CTS MAKES NO WARRANTY, INCLUDING WARRANTIES OF MERCHANTABILITY OR FITNESS FOR A PARTICULAR PURPOSE, WITH RESPECT TO THE PRODUCTS REFERENCED OR INFORMATION PROVIDED HEREIN.

CTS® is a registered trademark of CTS Corporation.