

**CRSH3 SERIES**  
**SILICON SCHOTTKY RECTIFIER**  
**3 AMP, 20 THRU 100 VOLTS**



**DO-201AD CASE**



[www.centralemi.com](http://www.centralemi.com)

**DESCRIPTION:**

The CENTRAL SEMICONDUCTOR CRSH3 series types are 3.0 amp glass passivated silicon Schottky rectifiers mounted in an axial-lead epoxy case using a metal-to-silicon junction to yield low forward voltage drops and instantaneous reverse recovery time.

**MARKING: FULL PART NUMBER**

**MAXIMUM RATINGS:** ( $T_A=25^{\circ}\text{C}$  unless otherwise noted)

		<b>CRSH3</b>							
	<b>SYMBOL</b>	<b>-2</b>	<b>-3</b>	<b>-4</b>	<b>-5</b>	<b>-6</b>	<b>-8</b>	<b>-10</b>	<b>UNITS</b>
Peak Repetitive Reverse Voltage	$V_{RRM}$	20	30	40	50	60	80	100	V
DC Blocking Voltage	$V_R$	20	30	40	50	60	80	100	V
RMS Reverse Voltage	$V_{R(RMS)}$	14	21	28	35	42	56	70	V
Average Forward Current	$I_O$				3.0				A
Peak Forward Surge Current ( $t_p=8.3\text{ms}$ )	$I_{FSM}$				80				A
Operating Junction Temperature	$T_J$				-65 to +125				$^{\circ}\text{C}$
Storage Temperature	$T_{stg}$				-65 to +150				$^{\circ}\text{C}$
Thermal Resistance	$\Theta_{JL}$				20				$^{\circ}\text{C/W}$

**ELECTRICAL CHARACTERISTICS:** ( $T_A=25^{\circ}\text{C}$  unless otherwise noted)

<b>SYMBOL</b>	<b>TEST CONDITIONS</b>	<b>TYP</b>	<b>MAX</b>	<b>UNITS</b>
$I_R$	$V_R=\text{Rated } V_{RRM}$		0.5	mA
$I_R$	$V_R=\text{Rated } V_{RRM}, T_A=100^{\circ}\text{C}$		30	mA
$V_F$	$I_F=3.0\text{A}$ (20V, 30V, 40V)		0.55	V
$V_F$	$I_F=3.0\text{A}$ (50V, 60V)		0.75	V
$V_F$	$I_F=3.0\text{A}$ (80V, 100V)		0.85	V
$C_J$	$V_R=4.0\text{V}, f=1.0\text{MHz}$	250		pF

R2 (18-June 2012)

**CRSH3 SERIES**  
**SILICON SCHOTTKY RECTIFIER**  
**3 AMP, 20 THRU 100 VOLTS**



**DO-201AD CASE - MECHANICAL OUTLINE**

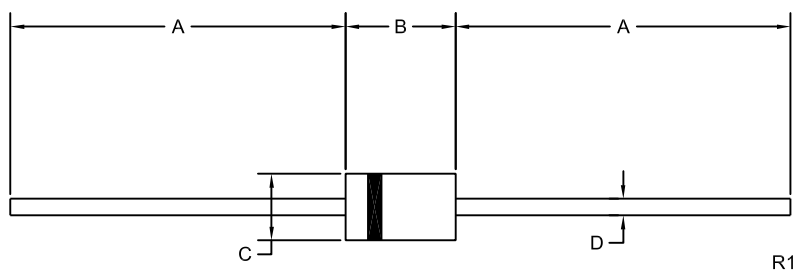

DIMENSIONS				
SYMBOL	INCHES		MILLIMETERS	
	MIN	MAX	MIN	MAX
A	1.000	-	25.40	-
B	0.283	0.375	7.20	9.53
C	0.189	0.210	4.80	5.33
D	0.047	0.052	1.20	1.32

DO-201AD (REV: R1)

**MARKING: FULL PART NUMBER**

R2 (18-June 2012)

## OUTSTANDING SUPPORT AND SUPERIOR SERVICES



---

### PRODUCT SUPPORT

Central's operations team provides the highest level of support to insure product is delivered on-time.

- Supply management (Customer portals)
- Inventory bonding
- Consolidated shipping options
- Custom bar coding for shipments
- Custom product packing

---

### DESIGNER SUPPORT/SERVICES

Central's applications engineering team is ready to discuss your design challenges. Just ask.

- Free quick ship samples (2<sup>nd</sup> day air)
- Online technical data and parametric search
- SPICE models
- Custom electrical curves
- Environmental regulation compliance
- Customer specific screening
- Up-screening capabilities
- Special wafer diffusions
- PbSn plating options
- Package details
- Application notes
- Application and design sample kits
- Custom product and package development

---

### REQUESTING PRODUCT PLATING

1. If requesting Tin/Lead plated devices, add the suffix "TIN/LEAD" to the part number when ordering (example: 2N2222A TIN/LEAD).
2. If requesting Lead (Pb) Free plated devices, add the suffix "PBFREE" to the part number when ordering (example: 2N2222A PBFREE).

---

### CONTACT US

#### Corporate Headquarters & Customer Support Team

Central Semiconductor Corp.  
145 Adams Avenue  
Hauppauge, NY 11788 USA  
Main Tel: (631) 435-1110  
Main Fax: (631) 435-1824  
Support Team Fax: (631) 435-3388  
[www.centrasemi.com](http://www.centrasemi.com)

**Worldwide Field Representatives:**  
[www.centrasemi.com/wwreps](http://www.centrasemi.com/wwreps)

**Worldwide Distributors:**  
[www.centrasemi.com/wwdistributors](http://www.centrasemi.com/wwdistributors)

---

For the latest version of Central Semiconductor's **LIMITATIONS AND DAMAGES DISCLAIMER**, which is part of Central's Standard Terms and Conditions of sale, visit: [www.centrasemi.com/terms](http://www.centrasemi.com/terms)