

FEATURES:

- These screws are specifically designed for securing the covers on our phenolic, die cast aluminum and extruded aluminum boxes.
- Each screw is designed to fit a specific application.
- All are made of high quality carbon steel with zinc plating for the best corrosion resistance.

Figure 1: Model 4864, #2-32 Self-Tapping Phillips

Replaces cover screws used in all die cast aluminum size A, size B and Miniature boxes. Carbon steel with blue zinc plating.

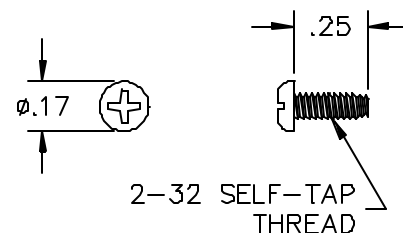

FIGURE 1 MODEL 4864

Figure 2: Model 4862, #4-40 UNC Flat Head Phillips

Replaces cover screws used in all extruded aluminum alloy size F, G & H boxes. Carbon steel with blue zinc plating.

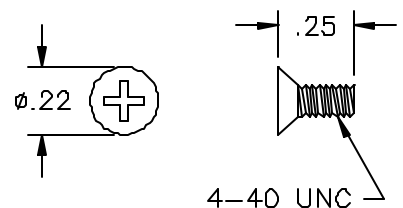

FIGURE 2 MODEL 4862

Figure 3: Model 6268, #4-40 UNC Binding Head Phillips

Replaces cover screws used in die cast aluminum alloy, size C Boxes. Carbon steel with blue zinc plating.

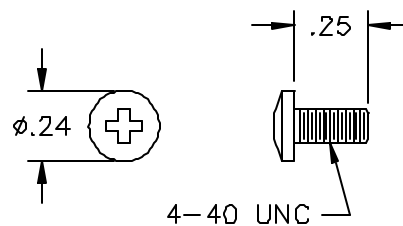

FIGURE 3 MODEL 6268

Figure 4: Model 6269, #2-56 UNC Pan Head Phillips

Replaces cover screws used in phenolic molded boxes. Carbon steel with blue zinc plating.

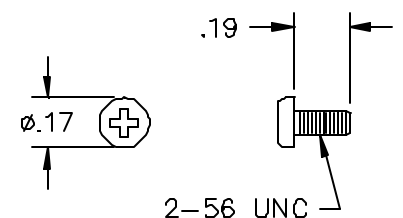

FIGURE 4 MODEL 6269

All dimensions are in inches. Tolerances (except noted): .xx = ± 0.02 " (.51 mm), .xxx = ± 0.005 " (.127 mm).
All specifications are to the latest revisions. Specifications are subject to change without notice.
Registered trademarks are the property of their respective companies. Made in USA

Mouser Electronics

Authorized Distributor

Click to View Pricing, Inventory, Delivery & Lifecycle Information:

Pomona:

4862 4864