

STANDARD BLANK BRACKETS



These computer brackets have been designed to accommodate a large variety of board sizes and heights. Available with tabs located properly for ESA/EISA or PCI formats. Blanks can be machined or stamped for prototype or low volume production. All brackets are nickel plated for a clean look and a protective finish. Standard cut-outs can be added to these blanks to suit your specific production needs. See page 118-119 for standard cut-outs and design worksheet.

- Premium quality
- Designed to fit all PC computers height brackets available
- Blanks available for "fillers"
- Fast delivery and cost effective tooling for special designs

MATERIAL: .032 (.81) Steel, Matte Nickel Plate.

EISA/ISA

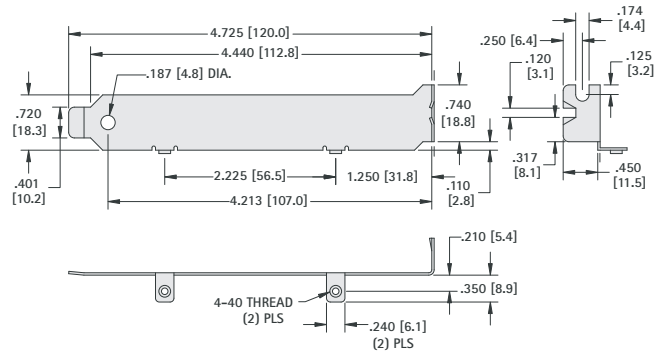

CAT. NO. 9202

PCI

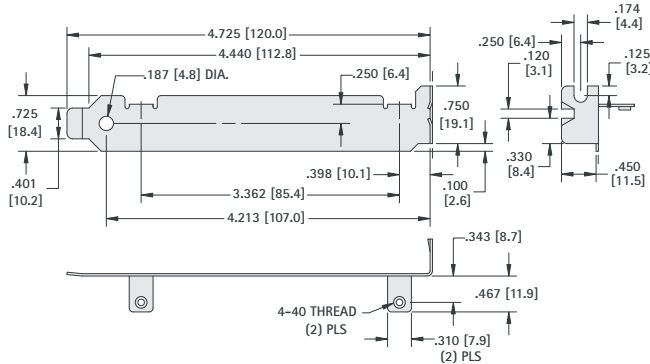

CAT. NO. 9203

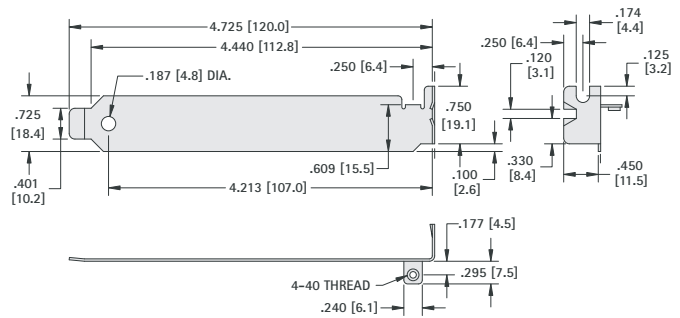

CAT. NO. 9204

EISA/ISA or PCI

- Reinforced with rib for extra strength

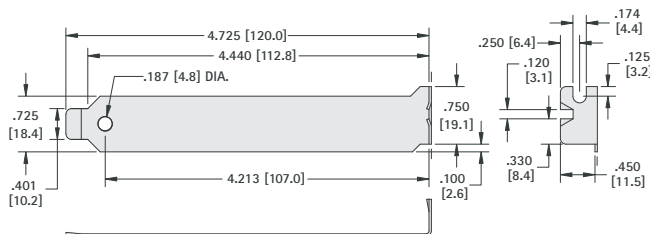

CAT. NO. 9200

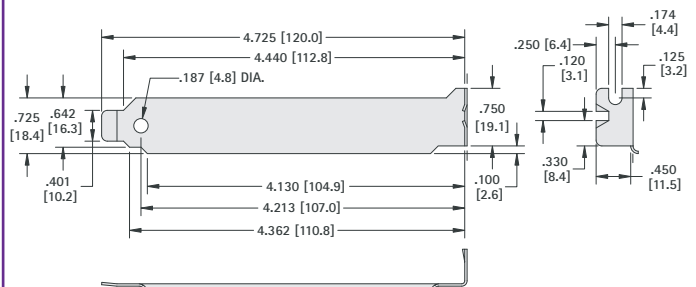

CAT. NO. 9201

Mouser Electronics

Authorized Distributor

Click to View Pricing, Inventory, Delivery & Lifecycle Information:

[Keystone Electronics:](#)

[9200](#) [9202](#) [9204](#) [9203](#) [9201](#)