

LOC	DIST	REVISIONS				
CE	00	P	LTR	DESCRIPTION	DATE	APVD
			A	RELEASED. ECO-12-018280	23OCT2012	JM

⚠ MATERIAL:  
CONNECTOR ASSEMBLY:  
CONNECTOR HOUSING: PPSU, COLOR: SEE -NO'S\*  
REAR BODY: METAL  
COMPRESSION SPRING: METAL  
FERRULE SUB ASSEMBLY: ZIRCONIA/ METAL  
INTERNAL SPLICE: PEI\*  
PLUNGER: METAL  
BOOTS: TPE, COLOR: BEIGE  
BUILD-UP TUBE: TPE  
TERMINATION COVER PBT, COLOR: BLACK  
PROTECTIVE CAP: VINYL, COLOR: RED

\*UL 94 V-0 RATED AT QUALIFYING THICKNESS.

2. INSTRUCTION SHEETS: 408-10103 OR 408-8925

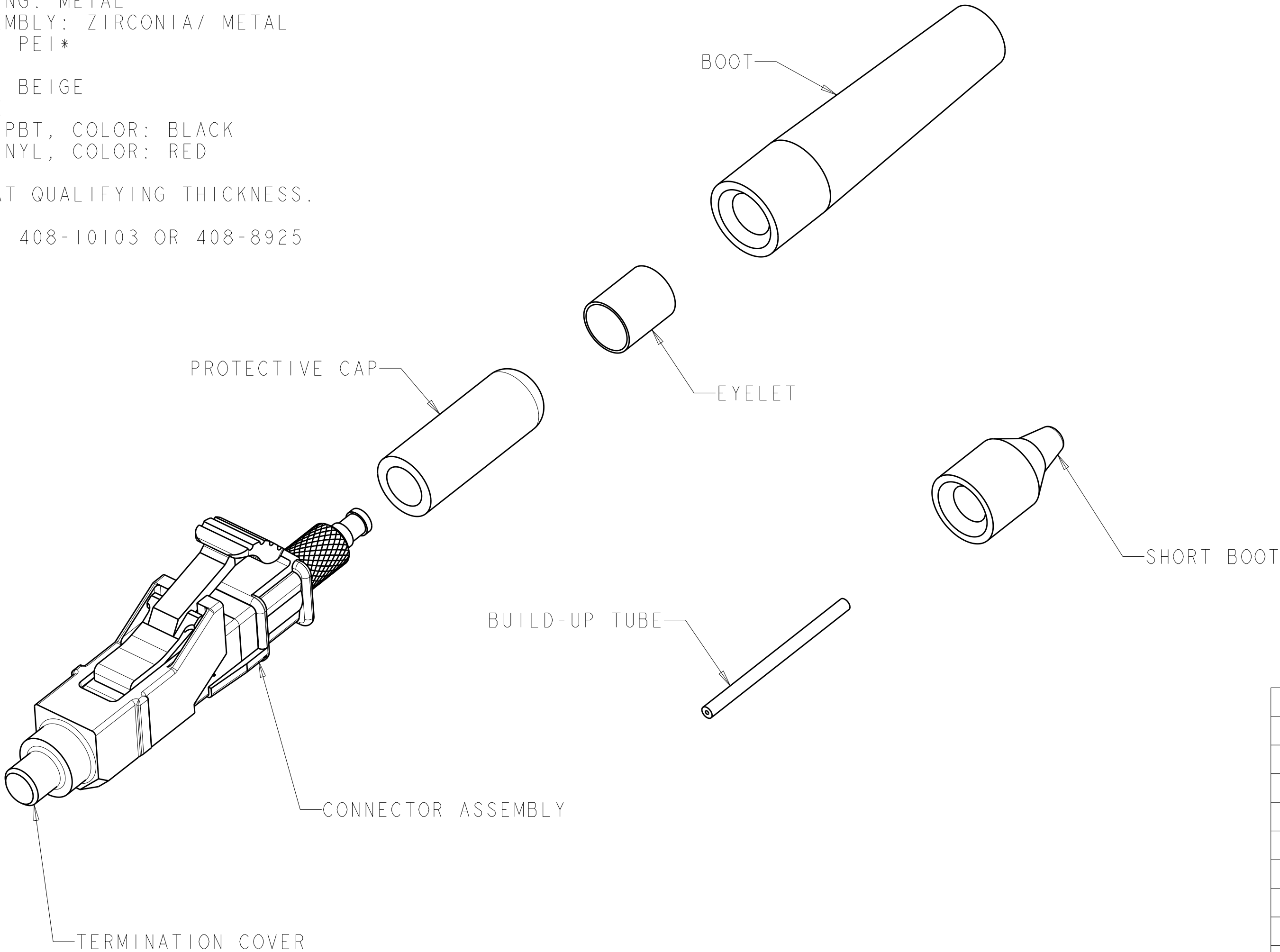

SLATE	1-1985961-0
ORANGE	1985961-9
VIOLET	1985961-8
BROWN	1985961-7
AQUA	1985961-6
ROSE	1985961-5
BLUE	1985961-4
GREEN	1985961-3
YELLOW	1985961-2
RED	1985961-1
KEYED HOUSING COLOR	PART NO.

THIS DRAWING IS A CONTROLLED DOCUMENT.		DWN B. BRIGGS 01APR2008	<div>TE Connectivity</div>			
DIMENSIONS: mm		CHK C. BENNETT 01APR2008				
TOLERANCES UNLESS OTHERWISE SPECIFIED: 0 PLC ± 1 PLC ± 2 PLC ± 3 PLC ± 4 PLC ± ANGLES ± FINISH		APVD S. BUCHTER 01APR2008	NAME KIT, CONNECTOR, LightCrimp Plus LC SECURE, SIMPLEX, MM62.5, 250um-2.0mm JACKET			
MATERIAL ⚠ -		PRODUCT SPEC -	SIZE A200779		DRAWING NO C-1985961	RESTRICTED TO -
		APPLICATION SPEC -	SCALE 4:1		SHEET 1	OF 1
		WEIGHT -	Customer Drawing		REV A	