

DESIGNED & DIMENSIONED  
IN MILLIMETERS  
(INCHES FOR REFERENCE ONLY)

HSEC8-1XX-XX-X-D-EMXX

DO NOT  
SCALE FROM  
THIS PRINT

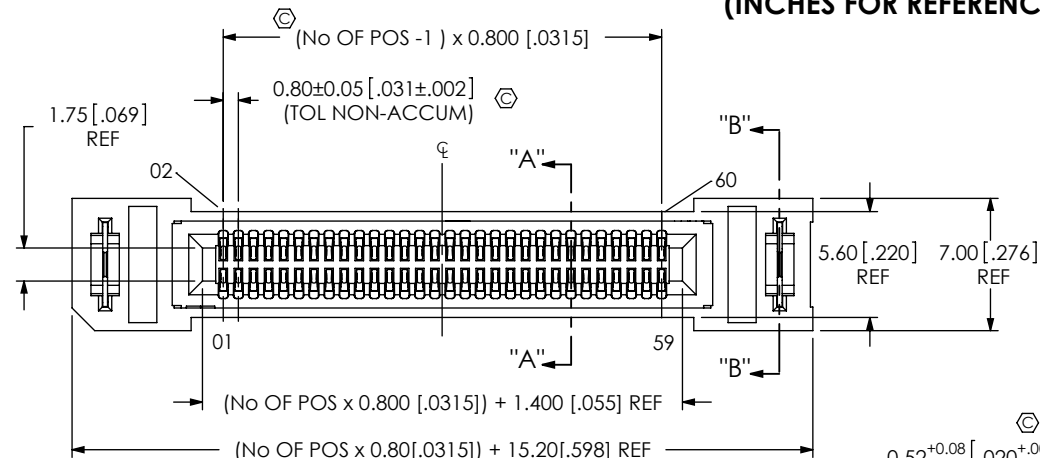

**No OF POSITIONS**  
-10, -20, & -30 (SEE FIG. 1)  
-13, -25, -37, -40, -49,  
-50, & -60 (SEE FIG. 2)  
(PER ROW)

**CARD THICKNESS**  
-01: 1.57mm [0.062] THICK CARD

**PLATING SPECIFICATION**  
-S: 30μ" SELECTIVE GOLD IN CONTACT AREA,  
MATTE TIN ON TAIL  
-L: 10μ" LIGHT SELECTIVE GOLD IN CONTACT AREA,  
MATTE TIN ON TAIL

**TAIL OPTION**  
-EM2: 1.57mm [0.062] THICK PCB  
-EM2L: 1.57mm [0.062] THICK PCB  
WITH WELD TAB LATCH  
(SHT. 3, FIG. 3) (AVAILABLE  
ONLY IN 13, 25, 37 & 49  
POSITIONS)

**ROW SPECIFICATION**  
-D: DOUBLE  
(USE HSEC8-XX-01-D-EM2X)

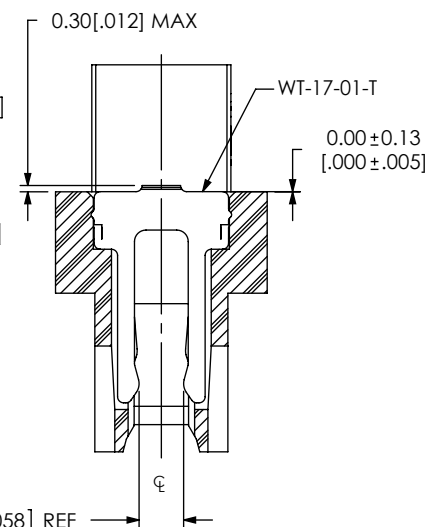
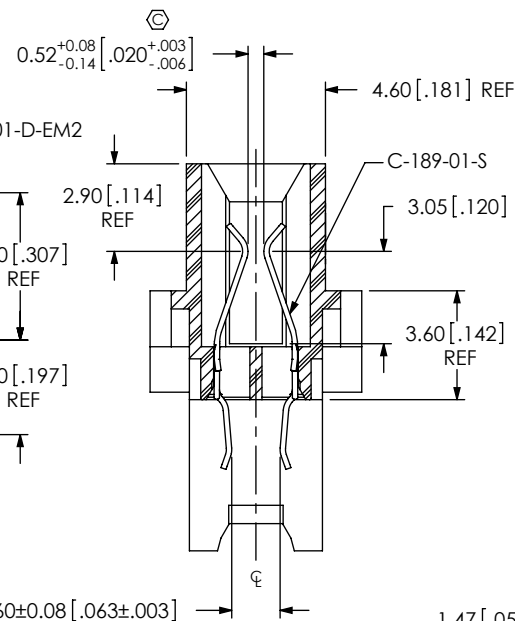
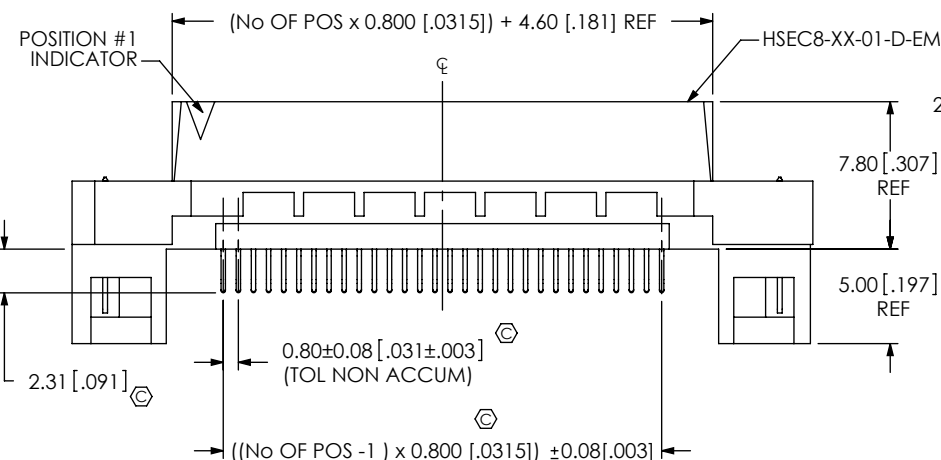

SECTION "A"- "A"  
SCALE 4 : 1

SECTION "B"- "B"  
SCALE 4 : 1

FIG 1

FOR POSITIONS -10, -20 & -30  
(SHOWN: HSEC8-130-01-S-D-EM2)

NOTES:

1. © REPRESENTS A CRITICAL DIMENSION.
2. BURR ALLOWANCE: 0.04 [0.0015] MAX.
3. MINIMUM PUSHOUT FORCE: 2.22 NEWTONS.
4. ALL TAIL TO TAIL DIMENSIONS TO BE MEASURED FROM TIP TO TIP.

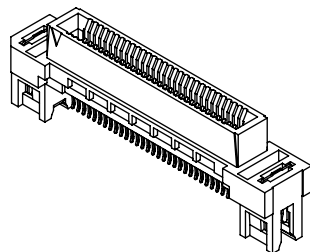

UNLESS OTHERWISE SPECIFIED,  
DIMENSIONS ARE IN MILLIMETERS.

TOLERANCES ARE:

DECIMALS ANGLES  
.X: ± 0.3 [0.01] 2°  
.XX: ± 0.13 [0.005]  
.XXX: ± 0.051 [0.0020]

PROPRIETARY NOTE

THIS DOCUMENT CONTAINS INFORMATION  
CONFIDENTIAL AND PROPRIETARY TO  
SAMTEC, INC. AND SHALL NOT BE REPRODUCED  
OR TRANSFERRED TO OTHER DOCUMENTS OR  
DISCLOSED TO OTHERS OR USED FOR ANY  
PURPOSE OTHER THAN THAT WHICH IT WAS  
OBTAINED WITHOUT THE EXPRESSED WRITTEN  
CONSENT OF SAMTEC, INC.

**MATERIAL:** DO NOT SCALE DRAWING  
INSULATOR: LCP, UL 94 VO, COLOR: BLACK  
CONTACT: BeCu  
WELD TAB: PHOS BRONZE

SHEET SCALE: 1:0.4

DESCRIPTION:  
0.8mm HIGH SPEED, DUAL EDGE MOUNT, MINI-EDGE CARD ASSEMBLY

DWG. NO.:  
HSEC8-1XX-XX-X-D-EMXX

BY: BRATCHER 01/27/03 SHEET 1 OF 3

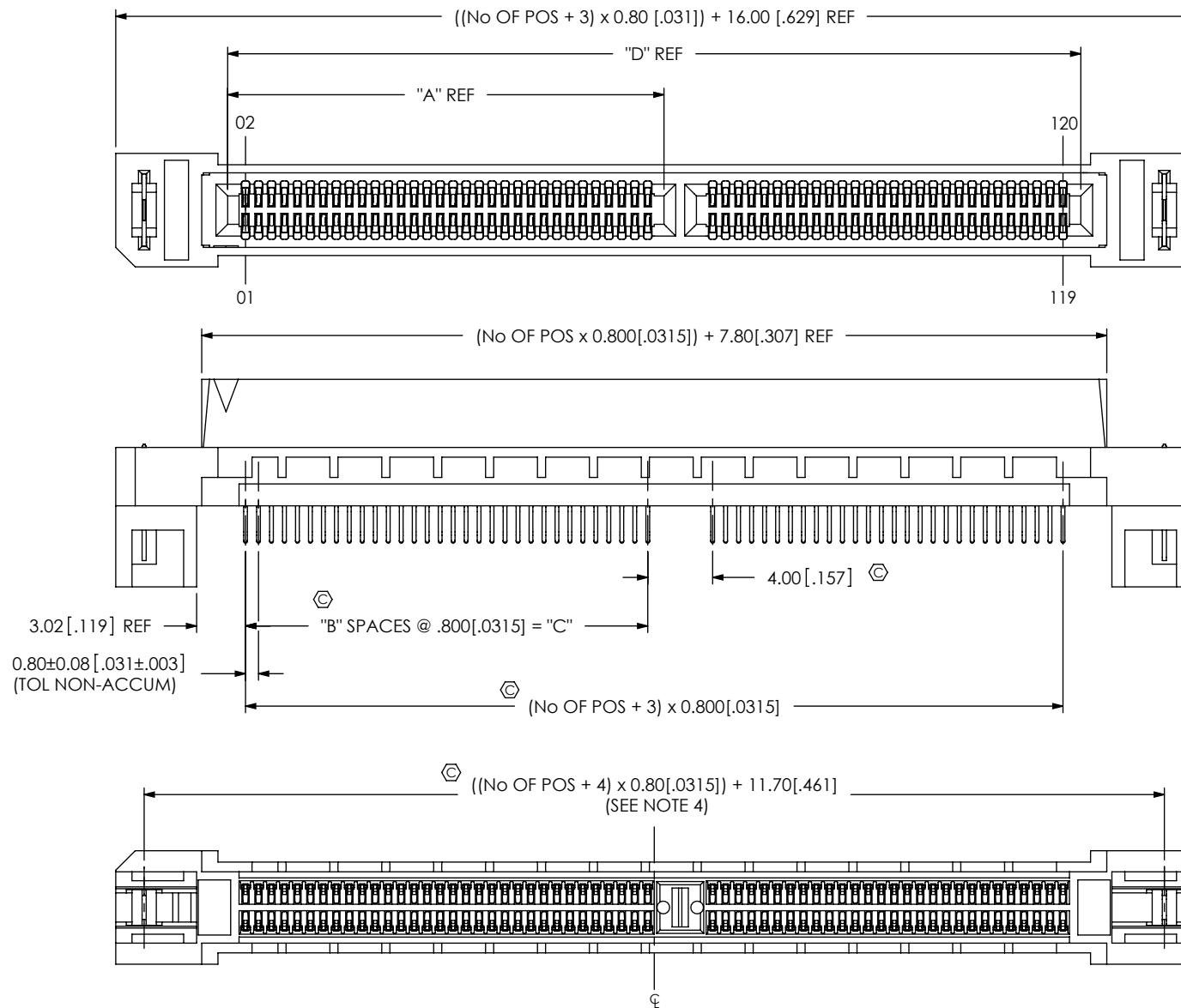

FIG 2

FOR POSITIONS -13, -25, -37, -40, -49, -50, -60  
(SAME AS FIG 1, UNLESS OTHERWISE STATED)  
(SHOWN: HSEC8-160-01-S-D-EM2)

No OF POS	"A" REF	"B"	"C"	"D" REF
-13	6.10[.240]	5	4.000[.1575]	15.00[.591]
-25	6.10[.240]	5	4.000[.1575]	24.60[.969]
-37	18.10[.713]	20	16.000[.6299]	34.20[1.346]
-40	18.90[.744]	21	16.800[.6614]	36.600[1.441]
-49	22.90[.902]	26	20.800[.8189]	43.80[1.724]
-50	22.90[.902]	26	20.800[.8189]	44.60[1.756]
-60	26.90[1.059]	31	24.800[.9763]	52.60[2.071]

F:\DWG\MISC\MKTG\HSEC8-1XX-XX-X-D-EMXX-MKT.SLDDRW

PROPRIETARY NOTE

**PROPRIETARY NOTE**  
THIS DOCUMENT CONTAINS INFORMATION  
CONFIDENTIAL AND PROPRIETARY TO  
SAMTEC, INC. AND SHALL NOT BE REPRODUCED  
OR TRANSFERRED TO OTHER DOCUMENTS OR  
DISCLOSED TO OTHERS OR USED FOR ANY  
PURPOSE OTHER THAN THAT WHICH IT WAS  
OBTAINED WITHOUT THE EXPRESSED WRITTEN  
CONSENT OF SAMTEC, INC.

DO NOT SCALE DRAWING

SHEET SCALE: 1:0.4

PACKAGING VIEW

FOR EM2

(PARTS TO HAVE POSITION #1 LOADED IN  
SAME DIRECTION AS ARROW ON TUBE)

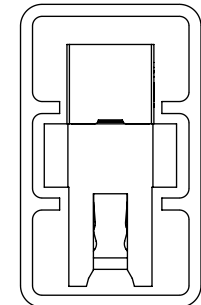

TUBE: PT-1-24-02-125  
PLUG: TP-03

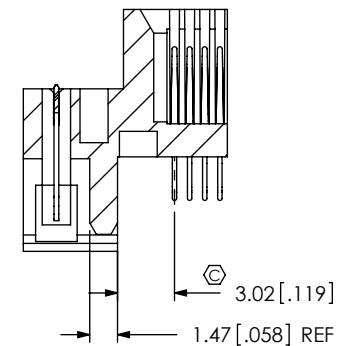

SECTION "C"-"C"



520 PARK EAST BLVD, NEW ALBANY, IN 47150  
PHONE: 812-944-6733 FAX: 812-948-5047  
e-Mail [info@SAMTEC.com](mailto:info@SAMTEC.com) code 55322

DESCRIPTION:

0.8mm HIGH SPEED, DUAL EDGE MOUNT, MINI-EDGE CARD ASSEMBLY

DWG. NO.

HSEC8-1XX-XX-X-D-EMXX

BY: BRATCHER 01/27/03

SHEET 2 OF 3

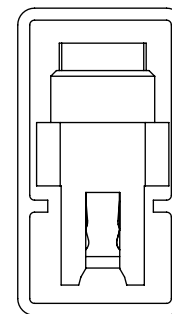
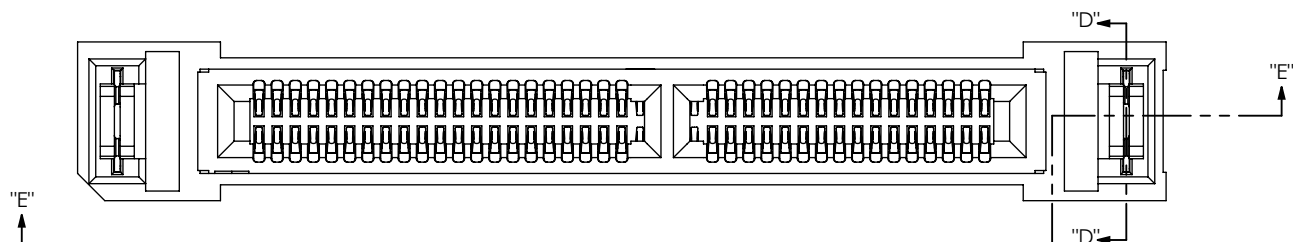

TUBE: PT-1-24-01-108  
PLUG: TP-13

**PACKAGING VIEW**  
FOR EM2L

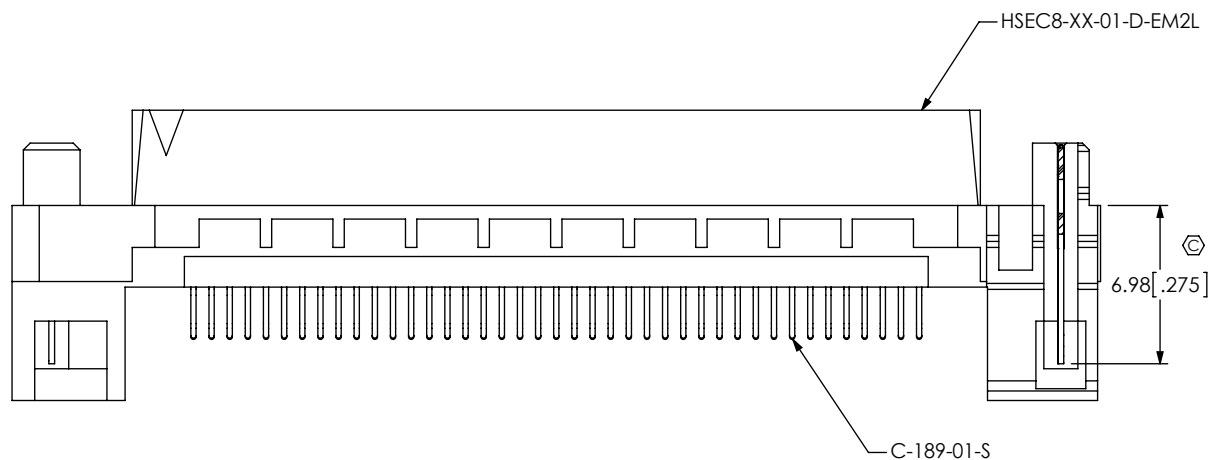

**SECTION "E"-"E"**

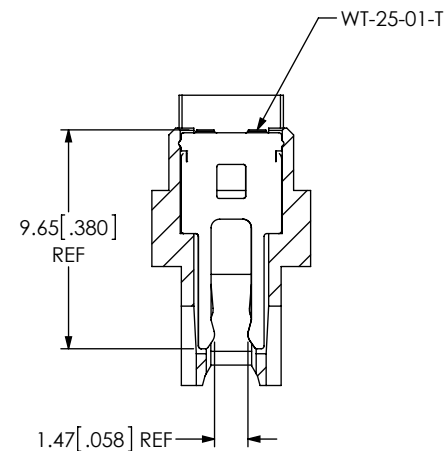

**SECTION "D"-"D"**

**FIG 3**

(SAME AS FIG 2, UNLESS OTHERWISE STATED)  
(SHOWN: HSEC8-137-01-S-D-EM2L)

**PROPRIETARY NOTE**

THIS DOCUMENT CONTAINS INFORMATION  
CONFIDENTIAL AND PROPRIETARY TO  
SAMTEC, INC. AND SHALL NOT BE REPRODUCED  
OR TRANSFERRED TO OTHER DOCUMENTS OR  
DISCLOSED TO OTHERS OR USED FOR ANY  
PURPOSE OTHER THAN THAT WHICH IT WAS  
OBTAINED WITHOUT THE EXPRESSED WRITTEN  
CONSENT OF SAMTEC, INC.

DO NOT SCALE DRAWING

SHEET SCALE: 1:0.333333

**samtec**

520 PARK EAST BLVD, NEW ALBANY, IN 47150  
PHONE: 812-944-6733 FAX: 812-948-5047  
e-Mail info@SAMTEC.com code 55322

**DESCRIPTION:**

0.8mm HIGH SPEED, DUAL EDGE MOUNT, MINI-EDGE CARD ASSEMBLY

**DWG. NO.**

**HSEC8-1XX-XX-X-D-EMXX**

BY: BRATCHER 01/27/03

SHEET 3 OF 3