

#### ELECTRICAL SPECIFICATIONS:

OPERATING TEMPERATURE RANGE: -20C TO +85C

#### 1.0 INDUCTANCE:

P6-J6=P3-J3 ; P2-J2=P1-J1 : 65 uH 0.1V, 10 KHz, nominal @ 25C.

#### 2.0 DC RESISTANCE:

P6-J6 : .5 ohm MAX

P3-J3 : .5 ohm MAX

P2-J2 : .5 ohm MAX

P1-J1 : .5 ohm MAX

#### 3.0 COMMON MODE ATTENUATION: CMA (-dB)

FREQUENCY (MHz)	TYPICAL	MIN
1	8	5
5	17	15
20	23	15
70	25	20
200	22	17
500	11	6

#### NOTE:

1.0 PINS WITHOUT ELECTRICAL CONNECTIONS ARE OMITTED.

InNet Technologies Inc.

<http://www.innet-tech.com>

Stewart Connector Systems

<http://www.stewartconnector.com>

SHEET  
1 OF 3

DRAWING NO.

SI-20142

REV. 09

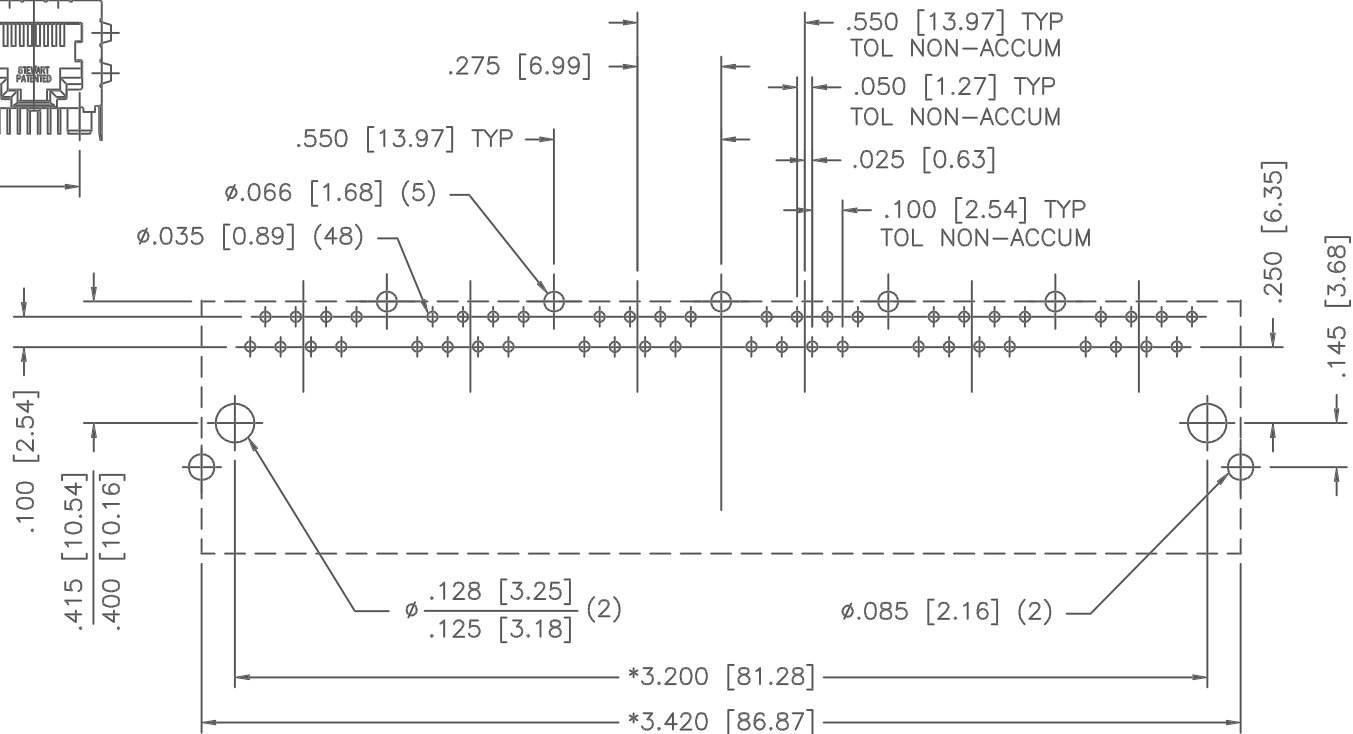
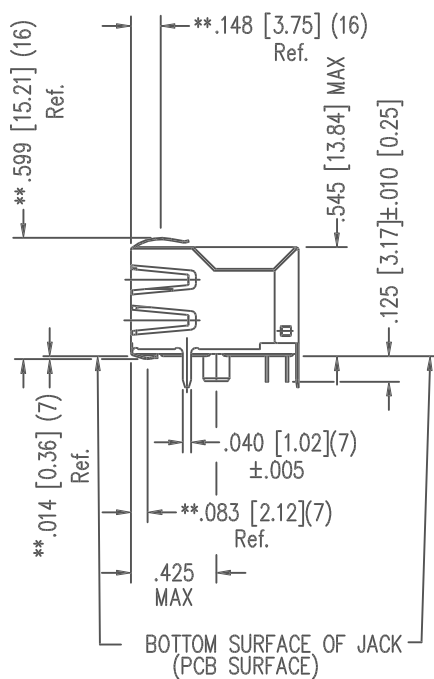
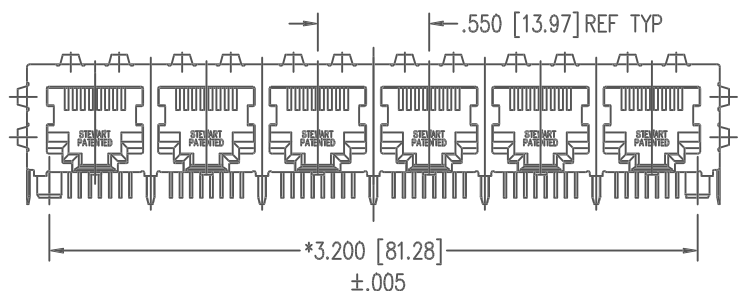
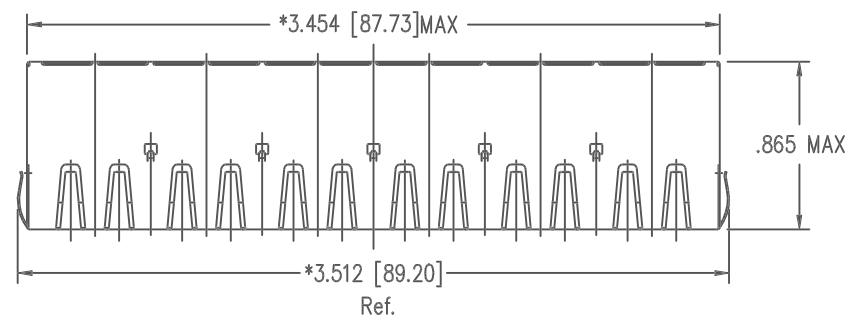

# NOTES:

- TOLERANCES COMPLY WITH F.C.C. DIMENSION REQUIREMENTS
- DIMENSIONS SHOWN WITH "\*" TO BE CENTRAL ABOUT CENTER LINE
- "\*" ON DIMENSION INDICATES HIGHEST POINT OF BEAM
- PINS NOT ELECTRICALLY CONNECTED MAYBE OMITTED. SEE ELECTRICAL DRAWING FOR OMITTED PINS.

## AVAILABLE WITH:

- 50 MICRO-INCH SELECTIVE GOLD PLATING

P.C.B. RECOMMENDED HOLE LAYOUT  
SEEN FROM COMPONENT SIDE  
TOLERANCE ±.003 [0.08] UNLESS OTHERWISE SPECIFIED

InNet Technologies Inc.

<http://www.innet-tech.com>

Stewart Connector Systems

<http://www.stewartconnector.com>

CT660100X2

SHEET  
2 of 3

DRAWING NO. SI-20142 REV. 02

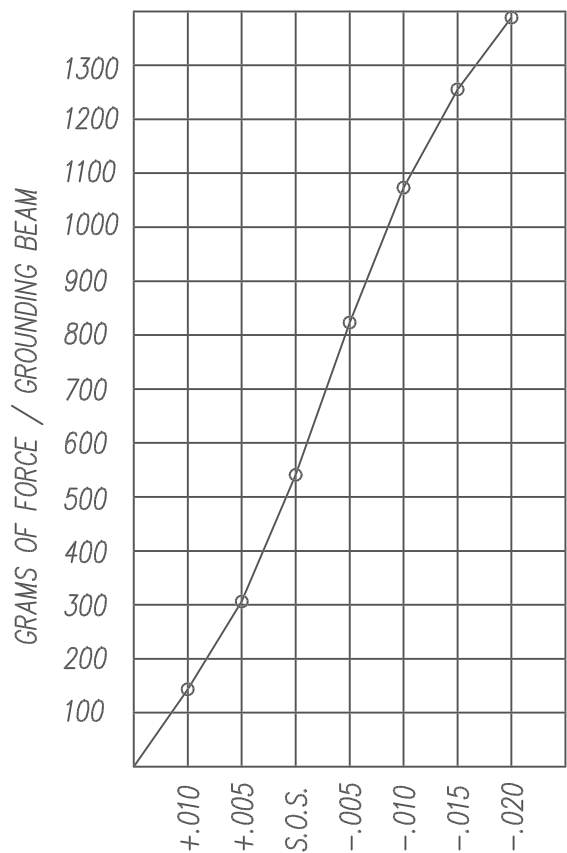

PANEL GROUNDING BEAM DEFLECTION  
S.O.S. = SUGGESTED OPENING SIZE

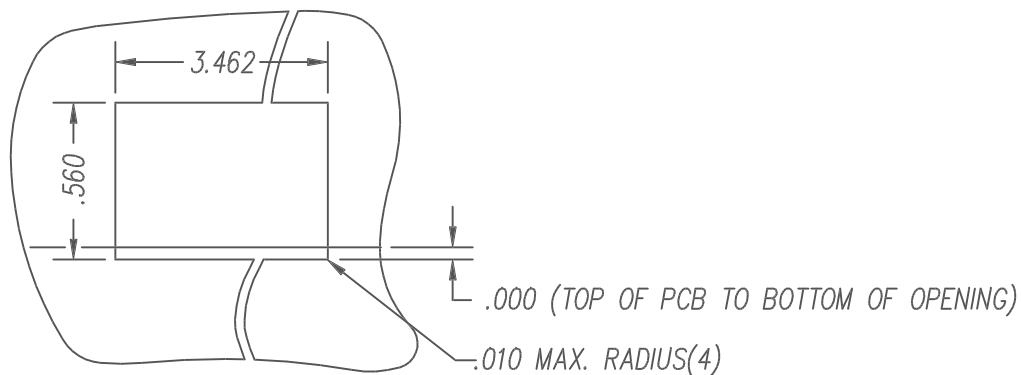

SUGGESTED PANEL OPENING

CT660100X2

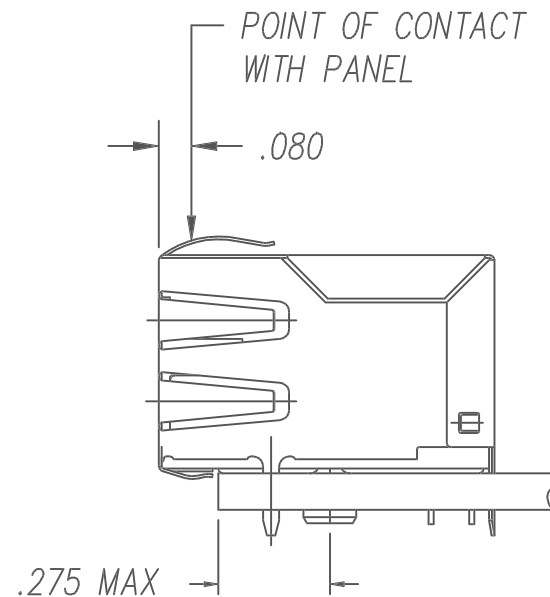

THE SUGGESTED PANEL OPENING IS INTENDED TO GIVE THE USER THE ABILITY TO HAVE REASONABLE JACK / PANEL CLEARANCES YET MAINTAIN RELIABLE GROUNDING CAPABILITY. THESE VARIABLES CAN BE ADJUSTED IN EITHER DIRECTION BUT MAY CARRY SOME CONSEQUENCES IN THE FORM OF LOWER MATING FORCES OR TIGHTER ASSEMBLY TOLERANCES. FORCE VALUES ON THE GRAPH ARE GENERAL AVERAGES TAKEN AT THE POINT OF CONTACT SHOWN ABOVE. THE SUGGESTED PANEL OPENING INCLUDES APPROXIMATELY .020 CLEARANCE ON THE SIDES AND TOP AND .005 ON THE BOTTOM.

InNet Technologies Inc.

<http://www.innet-tech.com>

Stewart Connector Systems

<http://www.stewartconnector.com>

SHEET  
3 of 3

DRAWING NO.  
SI-20142

REV.  
02