



EVERLIGHT ELECTRONICS CO.,LTD.

Device Number : DLE-033-858 REV: 1.0

T-1 3/4 (5mm) Round Shape LEDs

MODEL NO : 333-2SURD/S530-A6 ECN : Page: 1/4

■ Features :

- Populart T-1 3/4 diameter package.
- Choice of various viewing angles.
- Available on tape and reel.
- Reliable and robust.

■ Descriptions :

- The series is specially designed for applications requiring higher brightness.
- The LED lamps are available with different colors,intensities, epoxy colors, etc.

■ Package Dimensions:

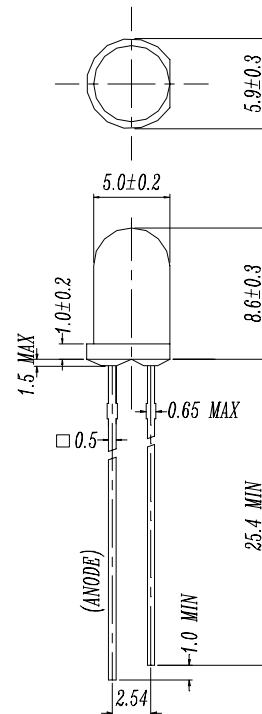

■ Applications :

- TV Set
- Monitor
- Telephone
- Computer

■ Notes :

- 1.All dimensions are in millimeters.
- 2.An epoxy meniscus may extend about 1.5mm(0.059") down to the lead.

PART NO	Chip		Lens Color
	Material	Emitted Color	
333-2SURD/S530-A6	AlGaInP	Hyper Red	Red Diffused

B89071661.8907014

OFFICE : NO. 25,Lane 76,Sec.3, Chung Yang Rd., Tucheng 236, Taipei, Taiwan, R.O.C.

TEL : 886-2-2267-2000,2267-9936

FAX : 886-2-2267-6244,22676189,22676306

<http://www.everlight.com>



EVERLIGHT ELECTRONICS CO.,LTD.

Device Number : DLE-033-858 REV: 1.0

T-1 3/4 (5mm) Round Shape LEDs

MODEL NO : 333-2SURD/S530-A6 ECN : Page: 2/4

■ Absolute Maximum Ratings at Ta = 25°C

Parameter	Symbol	Rating	Unit
Forward Current	IF	25	mA
Operating Temperature	Topr	-40 to +85	°C
Storage Temperature	Tstg	-40 to +100	°C
Soldering Temperature	Tsol	260 ± 5	°C
Electrostatic Discharge :	ESD	2000	V
Power Dissipation	Pd	60	mW
Peak Forward Current(Duty 1/10 @ 1KHZ)	IF(Peak)	160	mA
Reverse voltage	VR	5	V

■ Electronic Optical Characteristics :

Parameter	Symbol	Min.	Typ.	Max.	Unit	Condition
Luminous Intensity	Iv	250	400	---	mcd	IF=20mA
Viewing Angle	2θ 1/2	----	30	----	deg	IF=20mA
Peak Wavelength	λ p	----	632	----	nm	IF=20mA
Dominant Wavelength	λ d	-----	624	----	nm	IF=20mA
Spectrum Radiation Bandwidth	△ λ	----	20	-----	nm	IF=20mA
Forward Voltage	VF	----	2.0	2.4	V	IF=20mA
Reverse Current	IR	----	----	10	μ A	VR=5V



EVERLIGHT ELECTRONICS CO.,LTD.

Device Number : DLE-033-858

REV: 1.0

T-1 3/4 (5mm) Round Shape LEDs

MODEL NO : 333-2SURD/S530-A6

ECN :

Page: 3/4

■ Typical Electro-Optical Characteristic Curves

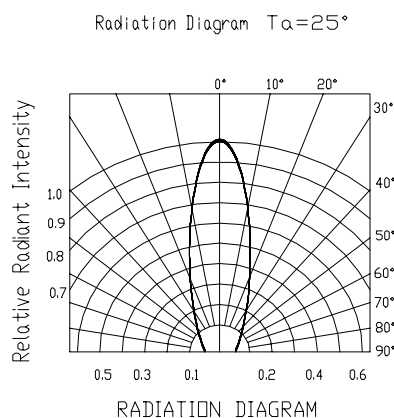
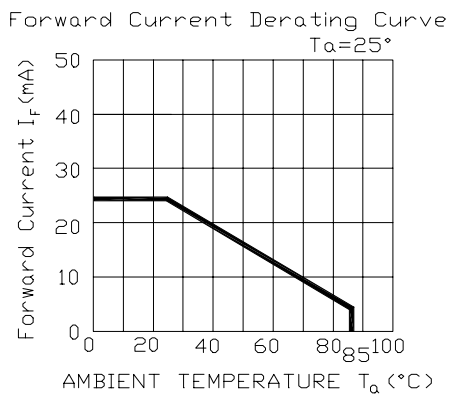
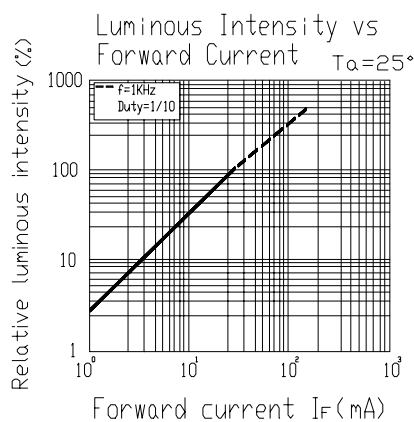
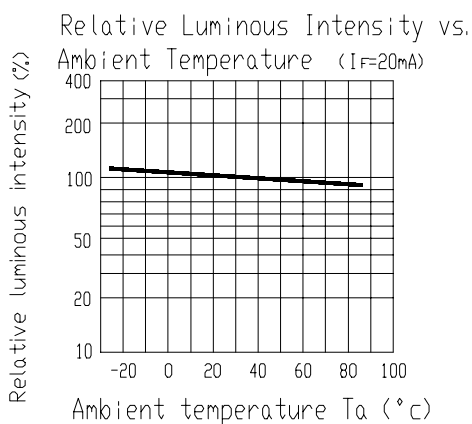
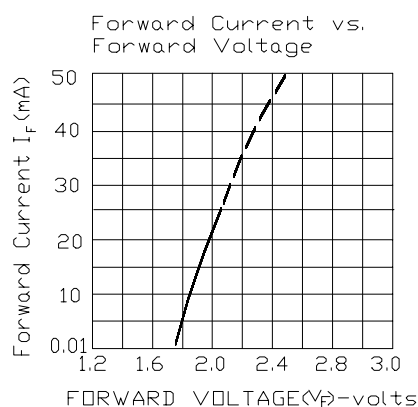
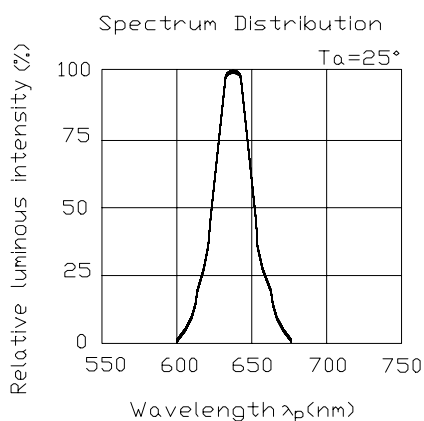



EVERLIGHT ELECTRONICS CO.,LTD.

Device Number : DLE-033-858

REV: 1.0

T-1 3/4 (5mm) Round Shape LEDs

MODEL NO : 333-2SURD/S530-A6

ECN :

Page: 4/4

■ Reliability test items and conditions

NO	Item	Test Conditions	Test Hours/Cycle	Sample Size	Ac/Re
1	Solder Heat	TEMP : 260°C ± 5 °C	5 SEC	76 PCS	0/1
2	Temperature Cycle	H : +85°C 30min ┆ 5 min L : -55°C 30min	50 CYCLE	76 PCS	0/1
3	Thermal Shock	H : +100°C 5min ┆ 10 sec L : -10°C 5min	50 CYCLE	76 PCS	0/1
4	High Temperature Storage	TEMP : 100°C	1000 HRS	76 PCS	0/1
5	Low Temperature Storage	TEMP : -55°C	1000 HRS	76 PCS	0/1
6	DC Operating Life	IF = 20 mA	1000 HRS	76 PCS	0/1
7	High Temperature / High Humidity	85°C/85% RH	1000 HRS	76 PCS	0/1