

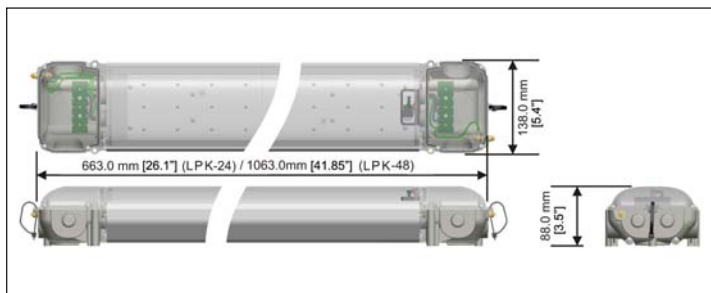

## LPK Series LED Linear White Fixture



Dimensions in Inches [mm]

### Certifications & Ratings:

- ▷ Certified to UL1598
- ▷ CE compliant
- ▷ CSA 22.2 # 250.0-04
- ▷ IP66 rated - CE ver
- ▷ IP65 rated - UL ver

### Features & Benefits:

- ▷ >70% lumen maintenance after 60,000 operating hours
- ▷ Utilizes the latest >100 lumens per LED technology for cool white
- ▷ Optional optics to direct light where most needed results in significant energy savings and/or increased luminaire spacing
- ▷ Can be wired in series
- ▷ Instant on/off
- ▷ Universal input voltage 90-277V 50/60Hz

### Order Codes:

LPK Series - UL Version	
LPK-00-062-3112-400	LPK24 Cool White
LPK-00-062-1112-500	LPK24 Cool White w/ Spot Optics
LPK-00-062-1112-600	LPK24 Cool White w/ Wide Optics
LPK-00-062-1112-700	LPK24 Cool White w/ Asymmetrical Optics
LPK-00-062-3212-400	LPK24 Warm White
LPK-00-064-3112-400	LPK48 Cool White
LPK-00-064-1112-500	LPK48 Cool White w/ Spot Optics
LPK-00-064-1112-600	LPK48 Cool White w/ Wide Optics
LPK-00-064-1112-700	LPK48 Cool White w/ Asymmetrical Optics
LPK-00-064-3212-400	LPK48 Warm White

### Application:

The Dialight LPK Series is a rugged and durable solution for demanding industrial and utility lighting applications. Its sealed housing allows its use outdoors as well as indoors and with its automatic input voltage sensing it can be used in most locations around the world. The fixture is rated for 60,000 hours continuous operation, requiring no maintenance apart from routine inspection throughout its operational life.

All of Dialight's long life LED luminaires are designed to meet the most demanding specification criteria while offering maximum energy savings, reduced maintenance costs, and a superior quality of light.

### Mechanical Information:

**Container Dimensions:** LPK24 = 8.27" X 6.10" X 30.70"  
210mm x 155mm x 780mm  
LPK48 = 8.27" X 6.10" X 45.67"  
210mm x 155mm x 1160mm

**Container Weight:** LPK24 = 13.5lbs (6.13kg)  
LPK48 = 19.8lbs (9.00kg)

### Electrical specifications:

**Operating Voltage:** 90-277V 50/60Hz

**Power Consumption:** LPK24 = 36W  
LPK48 = 72W

**Operating Temp:** -4°F to +133°F (-20°C to +55°C)

**Surge / Lightning Protection:** 1 kV line to line  
2 kV line to ground

**THD:** < 20%

**Power Factor:** > 0.9

### Material:

**Body:** Anodized alum. 6061

**Lens:** Clear polycarbonate

**Accessories (hardware):** Stainless steel

### Photometric Information:

**CRI (typ):** 70

**CCT (typ):** 6350K (cool white)  
3500K (warm white)

LPK Series - CE Version	
LPK-24-CW-NO-X	LPK24 Cool White
LPK-24-WW-NO-X	LPK 24 Warm White
LPK-48-CW-NO-X	LPK48 Cool White
LPK-48-WW-NO-X	LPK48 Warm White

# LPK Series - Light Measurement Data

## LPK 24

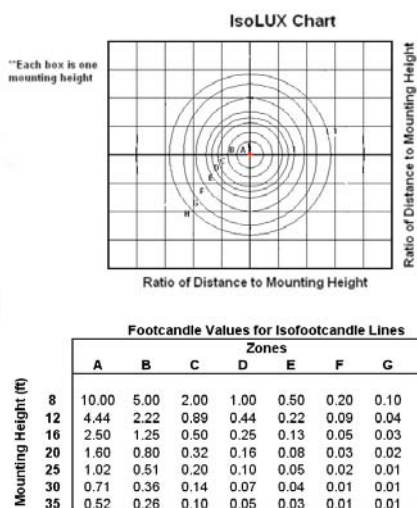
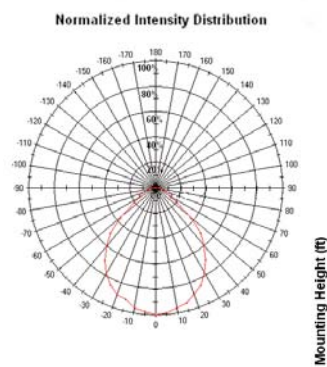

Footcandle Values for Isofootcandle Lines								
Zones								
	A	B	C	D	E	F	G	H
8	10.00	5.00	2.00	1.00	0.50	0.20	0.10	0.05
12	4.44	2.22	0.89	0.44	0.22	0.09	0.04	0.02
16	2.50	1.25	0.50	0.25	0.13	0.05	0.03	0.01
20	1.60	0.80	0.32	0.16	0.08	0.03	0.02	0.01
25	1.02	0.51	0.20	0.10	0.05	0.02	0.01	0.01
30	0.71	0.36	0.14	0.07	0.04	0.01	0.01	0.00
35	0.52	0.26	0.10	0.05	0.03	0.01	0.01	0.00

## LPK 48

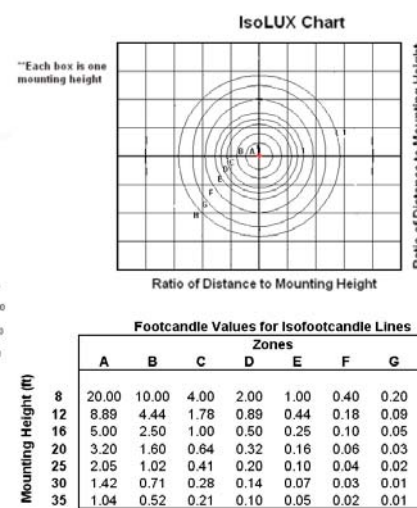
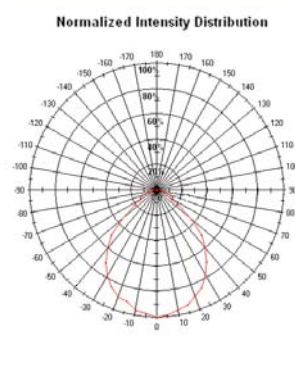

Footcandle Values for Isofootcandle Lines								
Zones								
	A	B	C	D	E	F	G	H
8	20.00	10.00	4.00	2.00	1.00	0.40	0.20	0.10
12	8.89	4.44	1.78	0.89	0.44	0.18	0.09	0.04
16	5.00	2.50	1.00	0.50	0.25	0.10	0.05	0.03
20	3.20	1.60	0.64	0.32	0.16	0.06	0.03	0.02
25	2.05	1.02	0.41	0.20	0.10	0.04	0.02	0.01
30	1.42	0.71	0.28	0.14	0.07	0.03	0.01	0.01
35	1.04	0.52	0.21	0.10	0.05	0.02	0.01	0.01

Light measurement data shown with no optics.

## LPK Series - Fixing / Wiring Detail

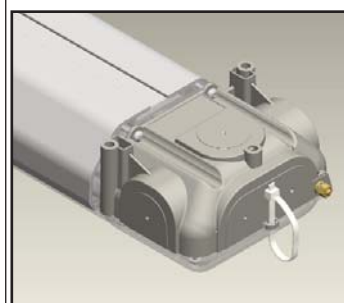

End Assembly  
Available Entry Points

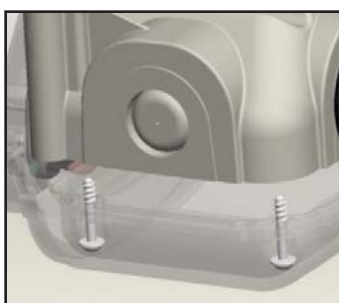

End Assembly  
Drill-Out Location



Mounting Screws

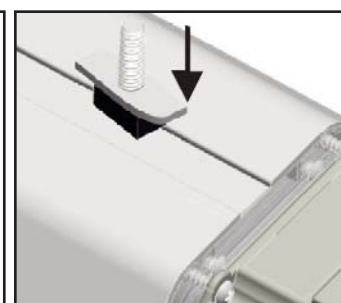

Slot-Bolt Assembly  
Required for Tracks/Raceways wiring

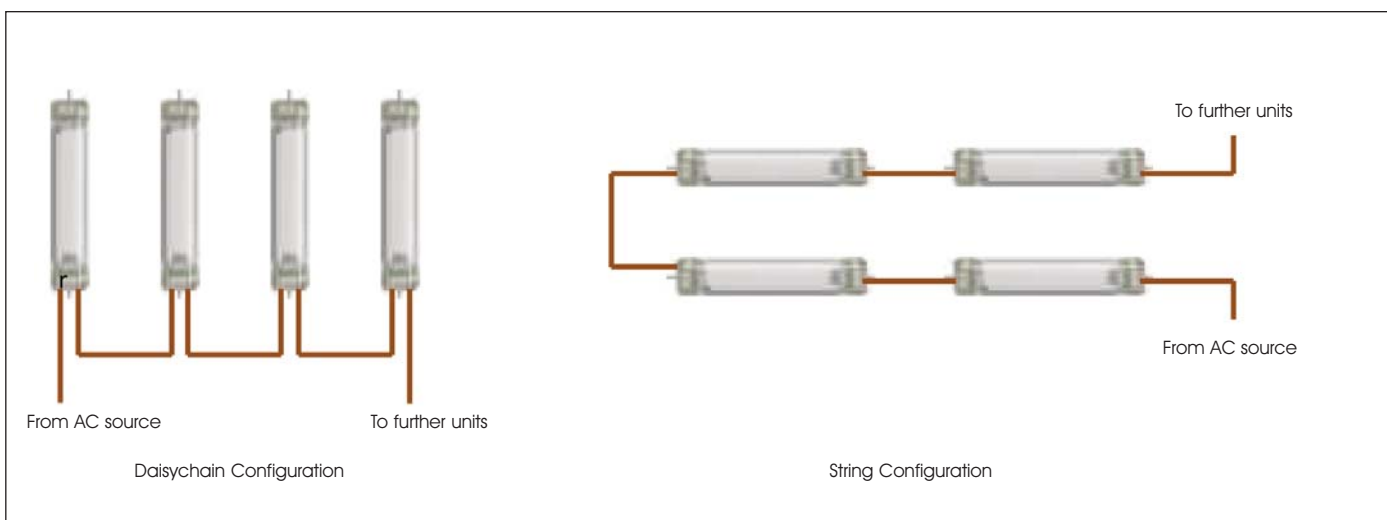

MDEXLUMLPKX001\_B