

Size #20 Crimp Contacts

#20 Pin Contact



#20 Socket Contact



Standard size #20 contacts accept #20 to #24 AWG wire. At rated test current of 7.5 amps, the maximum voltage drop is 55 millivolts. Contacts are gold-plated copper alloy. Socket contacts feature stainless steel hoods to protect against probe damage. Approved to SAE-AMS-39029. Contacts are bulk packaged. Terminate with M22520/1-01 crimper and M22520/1-04 positioner.

Contact Type	Wire Size	Part Number	Military Part Number	Color Band			Tool Code
				1st	2nd	3rd	
Pin	#20 – #24	850-002-20-363	M39029/58-363	Orange	Blue	Orange	J, K
Socket	#20 – #24	850-003-20-357	M39029/57-357	Orange	Green	Violet	J, K

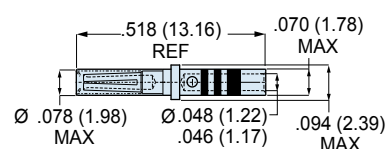
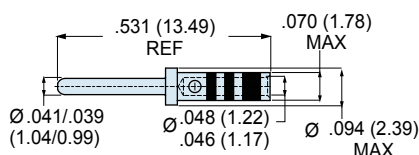

Size #16 Crimp Contacts

#16 Pin Contact



#16 Socket Contact



Standard size #16 contacts accept #16 to #20 AWG wire. At rated test current of 13 amps, the maximum voltage drop is 74 millivolts. Contacts are gold-plated copper alloy. Socket contacts feature stainless steel hoods to protect against probe damage. Approved to SAE-AMS-39029. Contacts are bulk packaged. Terminate with M22520/1-01 crimper and M22520/1-04 positioner.

Contact Type	Wire Size	Part Number	Military Part Number	Color Band			Tool Code
				1st	2nd	3rd	
Pin	#16 – #20	809-110	M39029/58-364	Orange	Blue	Yellow	J, K
Socket	#16 – #20	809-111	M39029/57-358	Orange	Green	Gray	J, K

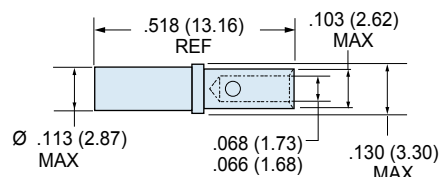
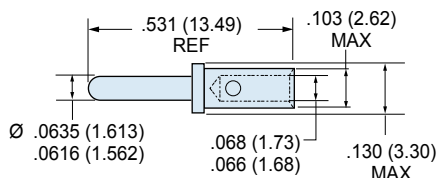

Size #12 Crimp Contacts

#12 Pin Contact

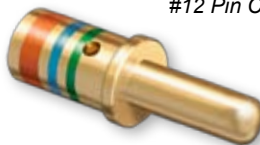

#12 Socket Contact



Standard size #12 contacts accept #12 to #14 AWG wire. At rated test current of 23 amps, the maximum voltage drop is 63 millivolts. Contacts are gold-plated copper alloy. Socket contacts feature stainless steel hoods to protect against probe damage. Approved to SAE AS39029. Contacts are bulk packaged. Terminate with M22520/1-01 crimper and M22520/1-04 positioner.

Contact Type	Wire Size	Part Number	Military Part Number	Color Band			Tool Code
				1st	2nd	3rd	
Pin	#12 – #14	809-112	M39029/58-365	Orange	Blue	Green	J, K
Socket	#12 – #14	809-113	M39029/57-359	Orange	Green	White	J, K

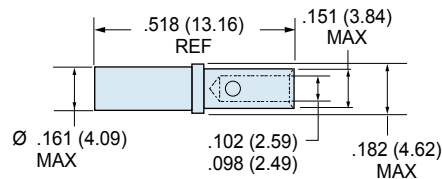
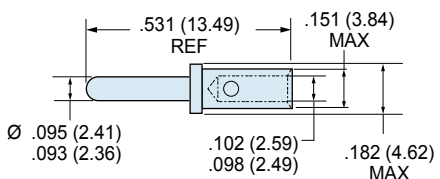

Dimensions in inches (millimeters) and are subject to change without notice.

CAGE Code 06324

Printed in U.S.A.