

## HAKKO FX-301B



LEAD FREE

Digital type

- Easy pot replacement.
- Selectable heating programs allows to get optimum temperature quickly.
- Select from four heating programs: Sn-Pb (Tin/Lead), Sn-Ag-Cu (Tin/Silver/Copper), Sn-Cu (Tin/Copper), and Sn (Tin).
- Special coating pot for long life as standard.
- Precise temperature control by digital temperature display & offset function.
- A timer function helps you keep tabs on how long the soldering pot has been in use, making it easy to judge the time for pot replacement.

## HAKKO FX-300



Analog type

- Easy pot replacement.
  - Use different pots for different composition solder, or different pot sizes (50 mm square and 75 mm square) with the same unit.
- Special coating pot for long life. (Option)

### Easy Pot Replacement

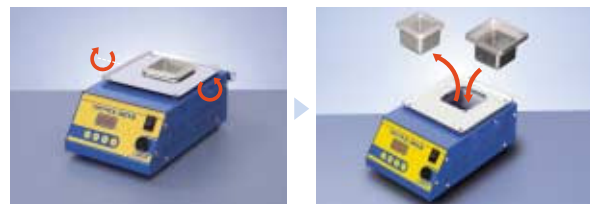

Loosen the screws on both sides of the pot. Replace the pot and retighten the screws.

### Dimensions of Solder Pot

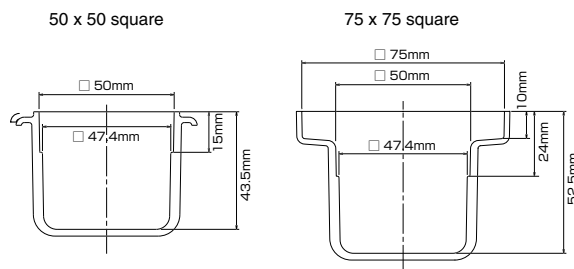

### Performance comparison table

	FX-300	FX-301B
Analog/Digital type	Analog	Digital
Parameter setting	×	○ Four heating programs
Offset function	×	○
Timer function	×	○
Standard pot/Special coating pot (50mm square and 75mm square)	○	○

### Specifications

Model No.	FX-301B	FX-300
Power Consumption	200W	195W
Weight (w/o solder & cord)	1.7kg	
Dimensions	143(W) x 100(H) x 220(D)mm	

### Soldering Pot

	50 x 50 Square	75 x 75 Square
Temperature Range	200-450°C	200-380°C
Dimensions	50(W) x 43.5(H) x 50(D)mm	75(W) x 52.5(H) x 75(D)mm
Molten Solder Capacity	0.85kg	1.2kg

\* Only a 50 x 50 square solder pot is included in this product.

\* The 75 x 75 square solder pot is an optional part.

### Replacement and Optional Parts

Part No.	Name/Description
A1517	Solder pot/50 x 50mm
A1518	Solder pot/75 x 75mm
A1539*	Solder pot/50 x 50mm Special coating for long life
A1540*	Solder pot/75 x 75mm Special coating for long life

\* A special coating is applied to increase the corrosion resistance of the solder pot and provide extended life. The corrosion resistance test<sup>①</sup> shows that the life of this solder pot is more than 5 times longer compared to that of the standard pot. This pot is compatible with both lead-free and tin-lead soldering.

① The data are based on our comparison test, actual life varies depending on the use conditions.

### Packing List

Model Name	Contents
HAKKO FX-301B	Unit .....1
	Spatula .....1
	J-shaped waste collector .....1
	Hexagon wrench .....1
HAKKO FX-300	Unit .....1
	Spatula .....1
	J-shaped waste collector .....1
	Hexagon wrench .....1

### Temperature Probe

Part No.	Name/Description
A1310	Temperature probe for solder in pots



\* For further details, refer to page 39.

## HAKKO 96



- Large-capacity solder pot holds a larger amount of solder, the solder temperature remains high even during continuous soldering operations.
- The stainless steel solder pot and other heavy-duty components offer greater durability, while the solder overflow prevention rim around the pot provides greater safety.
- The raised rim around the pot enhances soldering and desoldering efficiency.
- A waste collector adds a final touch of operating ease and efficiency.



### Specifications

Model No.	96	96-1
Power Consumption	200W	
Heating Element	Ceramic Heater	
Dimensions	135(W) x 107(H) x 222(D)mm	135(W) x 117(H) x 222(D)mm
Weight (w/o cord)	1.5kg	1.6kg
Temperature	100-450°C	100-380°C
Insulation Resistance	Over 100MΩ (250°C)	
Dimension of Solder Pot	50(W) x 54(H) x 50(D)mm	70(W) x 64(H) x 70(D)mm
Molten Solder Capacity	0.85kg	1.2kg

### Packing List

Model Name	Contents
HAKKO 96	Unit .....1
	Spatula .....1

### Dimensions of Solder Pot

