

PRODUCT NUMBER

71600-YXXLF

LEAD FREE, SEE NOTE 6

TOTAL NB OF POSITION 04 TO 64
SEE SHEET 2

OPTIONAL STRAIN RELIEF
SEE SHEET 2

TRIANGLE INDICATES
POSITION 1
NOTE 5

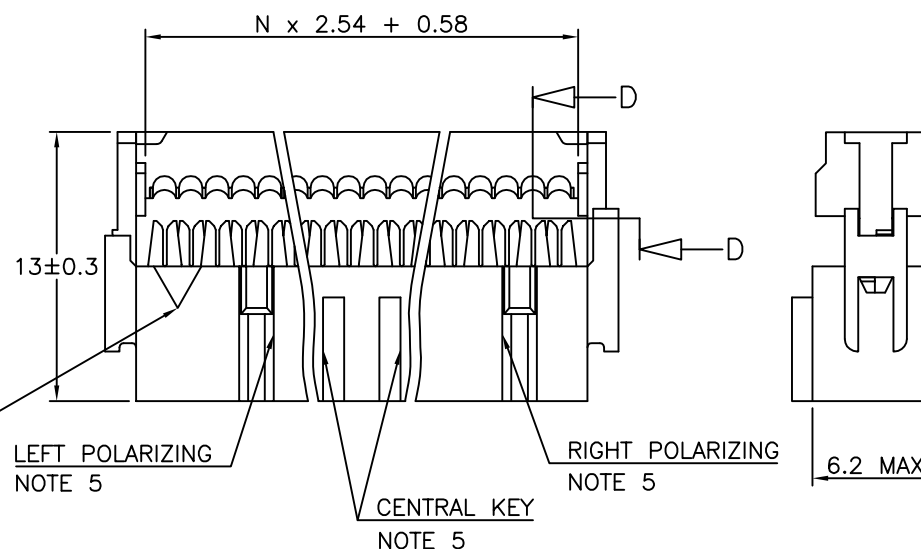

NOTES:

- 1 - PLASTIC MAT'L : GLASS FILLED HIGH TEMPERATURE THERMOPLASTIC. UL94V-0 COLOR: GREY
- 2 - PIN MATERIAL : PHOSPHOR BRONZE
- 3 - PRODUCT PACKAGED IN TUBES.
- 4 - TO DETERMINE DIMENSIONS :
N = NUMBER OF POSITIONS PER ROW
EXAMPLE : 8 POS $N \times 2.54 = 20.32\text{mm}$
- 5 - 2x5, 2x6, 2x7 HAVE NO LEFT POLARIZING SLOT.
- 2x2, 2x3 WITH CENTRAL KEY HAVE NO TRIANGLE, NO LEFT AND RIGHT POLARIZING SLOT.
- 2x2 WITHOUT CENTRAL KEY HAS NO LEFT AND RIGHT POLARIZING SLOT.
- 2x3, 2x4 WITHOUT CENTRAL KEY HAVE NO LEFT POLARIZING SLOT
- 2x4 WITH CENTRAL KEY HAVE NO LEFT AND RIGHT POLARIZING SLOT
- 6 - THIS PRODUCT MEETS EUROPEAN UNION DIRECTIVES AND OTHER COUNTRY REGULATIONS AS PER GS-22-008.
PACKAGING SPECIFICATION AS PER GS-14-920.

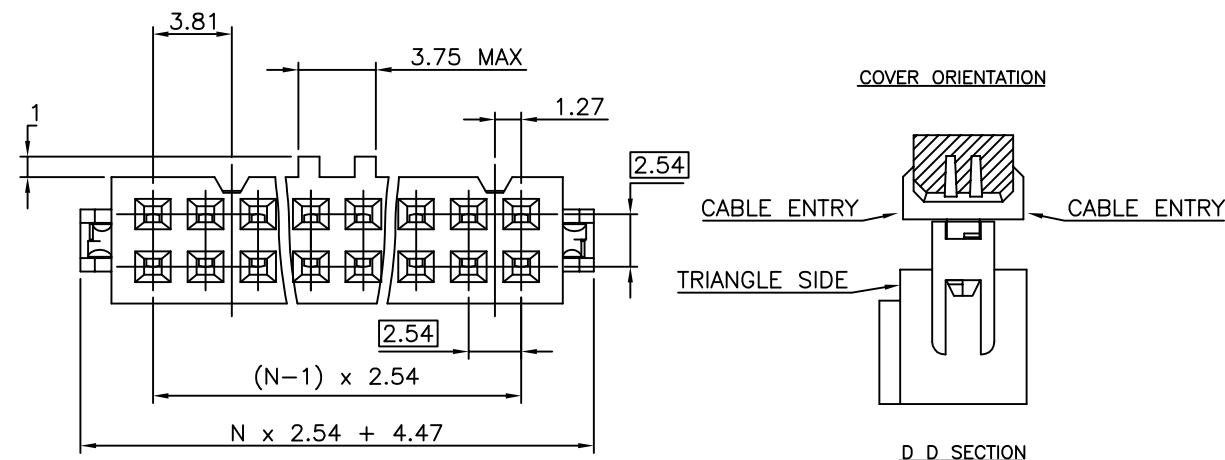

| | | | | | | | |
|--------------------------|----------|-----|----------|---------------------------------------|-------------------------------|------------|------------------------------|
| mat'l. code SEE NOTES | | | | surface ISO 1302 | tolerance ISO 406 ISO 1101 | projection | product family 2.54MM IDC |
| ltr | ecn no | dr | date | tolerances unless otherwise specified | | mm | title |
| AP | F12-0046 | LMU | 12.04.25 | angles | X.X ±0.3 | | QUICKIE III FEM |
| AR | B-17851 | LMU | 14.06.05 | linear | X.XX ±0.13 | | 0.76µm Au |
| | | | | | X.XXX ±0.05 | scale 5:1 | |
| AK | F05-0180 | LMU | 05.04.22 | dr | D.LE | 01.01.24 | dwg no |
| AL | F06-0270 | LMU | 06.09.12 | engr | P.NZ | 01.01.24 | sheet 1 of 2 |
| AM | F06-0274 | LMU | 06.09.25 | chr | JF.N | 01.01.24 | size |
| AN | F09-0233 | LMU | 09.12.15 | appd | P.NZ | 01.01.24 | A3 |
| sheet | revision | AR | AF | | | | type |
| index | sheet | 1 | 2 | | | | CUSTOMER Drawing |



FCIconnect.com

Copyright FCI

| STRAIN RELIEF OPTION AVAILABILITY | Nbr OF POSITIONS |
|---|------------------|
| 1/6 | 04 |
| 0/1/2/3/6 | 06 |
| 0/1/2/3/6 | 08 |
| 0/1/2/3/6 | 10 |
| 0/1/2/3/6 | 14 |
| 0/1/2/3/6 | 16 |
| 0/1/2/3/6 | 18 |
| 0/1/2/3/6 | 20 |
| 0/1/3 | 24 |
| 0/1/2/3/6 | 26 |
| 0/1/2/3/6 | 30 |
| 0/1/2/3/6 | 34 |
| 0/1/2/3/6 | 40 |
| 0/1/2/3/6 | 50 |
| 0/1/2/3/6 | 60 |
| 0/1/2/3/6 | 64 |
| PLATING 0.76µm GOLD ON CONTACT AREA 1.27 µm Ni REMAINDER OF PRODUCT | |

| |
|----------------------|
| 624 |
| 304 |
| 204 / 224 |
| 004 |
| DASHES NOT AVAILABLE |

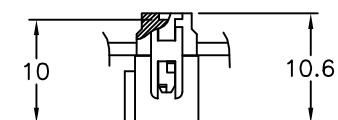

WITHOUT STRAIN RELIEF

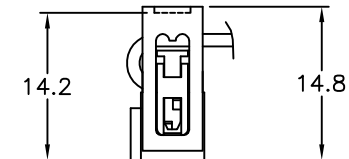

WITH LOW PROFILE STRAIN RELIEF

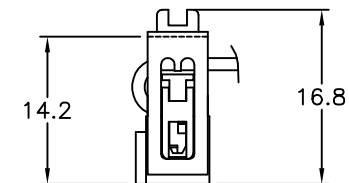

WITH STANDARD STRAIN RELIEF

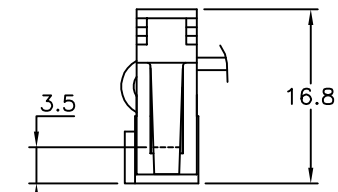

WITH LATCHING STRAIN RELIEF

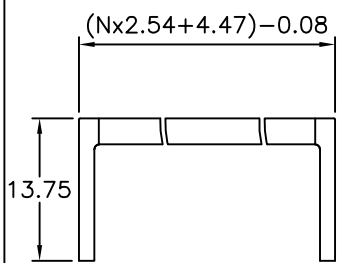

LOW PROFILE STRAIN RELIEF

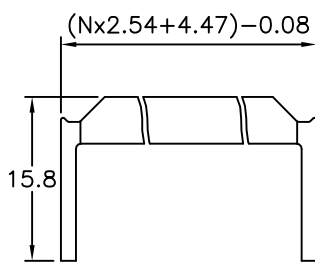

STANDARD STRAIN RELIEF

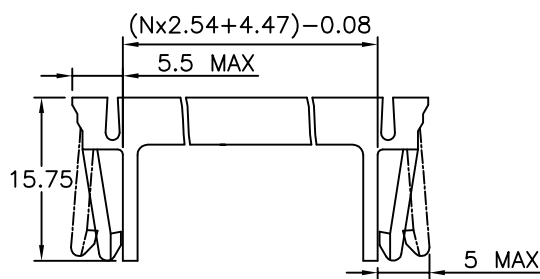

LATCHING STRAIN RELIEF FOR SLIM HEADER

| | | | | | | |
|----------------|-------------|---------|---------------|---------|-------------|----------|
| 71600-6YYLF | ● | | | | | ● |
| 71600-3YYLF | | ● | ● | | | |
| 71600-2YYLF | ● | | | | ● | |
| 71600-1YYLF | ● | | | | ● | |
| 71600-0YYLF | ● | | ● | | | |
| PRODUCT NUMBER | WITH | WITHOUT | STANDARD | WITHOUT | LOW PROFILE | LATCHING |
| | CENTRAL KEY | | STRAIN RELIEF | | | |

| | | | | | | | |
|-------------|----------------|-----|----------|---------------------------------------|-----------|------------|-----------------------|
| mat'l. code | | | | surface | tolerance | projection | product family |
| ltr | ecn no | dr | date | ISO 1302 | ISO 406 | ISO 1101 | QUICKIE |
| AF | B-17851 | LMU | 14.06.05 | tolerances unless otherwise specified | | mm | title |
| | | | | angles | linear | | IDC RECEPT DR |
| AA | F10199 | GCO | 01.04.26 | | | scale N/A | dwg no |
| AB | F03019 | DLE | 03.01.23 | dr | D.LE | 01.01.24 | sheet 2 of - size |
| AC | F05-0180 | LMU | 05.04.22 | engr | P.NZ | 01.01.24 | 71600 A3 |
| AD | F06-0270 | LMU | 06.09.12 | chr | JF.N | 01.01.24 | type CUSTOMER Drawing |
| AE | F06-0274 | LMU | 06.09.25 | appd | P.NZ | 01.01.24 | |
| sheet index | revision sheet | | | | | | |

Mouser Electronics

Authorized Distributor

Click to View Pricing, Inventory, Delivery & Lifecycle Information:

FCI:

[71600-024LF](#) [71600-120LF](#) [71600-350LF](#)