

**ST** 7mmL, Wide Temperature Range  
series

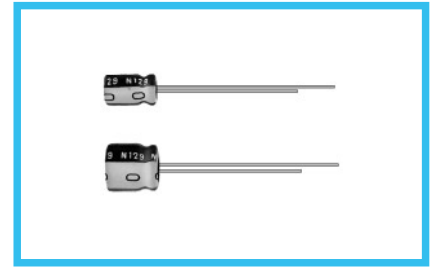

- Wide temperature range of  $-55$  to  $+105^{\circ}\text{C}$ , with 7mm height.
- Compliant to the RoHS directive (2002/95/EC).

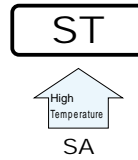

## Specifications

Item	Performance Characteristics						
Category Temperature Range	$-55$ to $+105^{\circ}\text{C}$						
Rated Voltage Range	6.3 to 50V						
Rated Capacitance Range	0.1 to $220\mu\text{F}$						
Capacitance Tolerance	$\pm 20\%$ at 120Hz, $20^{\circ}\text{C}$						
Leakage Current	After 2 minutes' application of rated voltage, leakage current is not more than $0.01\text{CV}$ or $3(\mu\text{A})$ , whichever is greater.						
Tangent of loss angle ( $\tan \delta$ )	Measurement frequency : 120Hz, Temperature : $20^{\circ}\text{C}$						
	Rated voltage (V)	6.3	10	16	25	35	50
	$\tan \delta$ (MAX.)	0.24	0.21	0.18	0.15	0.13	0.12
Stability at Low Temperature	Measurement frequency : 120 Hz						
	Rated voltage (V)	6.3	10	16	25	35	50
	Impedance ratio	Z- $25^{\circ}\text{C}$ / Z- $20^{\circ}\text{C}$	3	2	2	2	2
	ZT / Z20 (MAX.)	Z- $40^{\circ}\text{C}$ / Z- $20^{\circ}\text{C}$	6	5	4	3	3
Endurance	The specifications listed at right shall be met when the capacitors are restored to $20^{\circ}\text{C}$ after the rated voltage is applied for 1000 hours at $105^{\circ}\text{C}$ .						
Shelf Life	After storing the capacitors under no load at $105^{\circ}\text{C}$ for 1000 hours and then performing voltage treatment based on JIS C 5101-4 clause 4.1 at $20^{\circ}\text{C}$ , they shall meet the specified values for the endurance characteristics listed above.						
Marking	Printed with white color letter on black sleeve.						

## Radial Lead Type

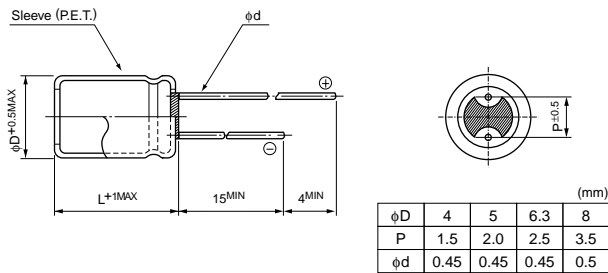

## Type numbering system (Example : 10V 33 $\mu\text{F}$ )

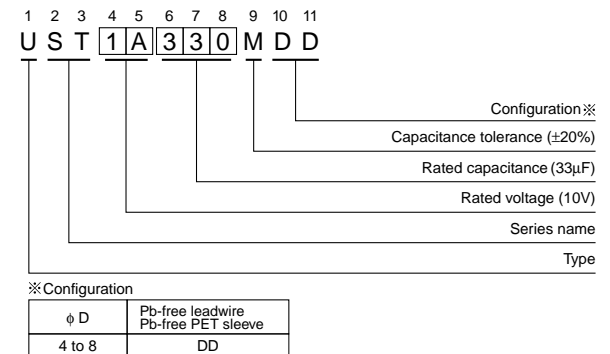

## Dimensions

Cap. ( $\mu\text{F}$ )	V	6.3	10	16	25	35	50		
Code		0J	1A	1C	1E	1V	1H		
0.1	0R1							4 × 7	1.0
0.22	R22							4 × 7	2.3
0.33	R33							4 × 7	3.5
0.47	R47							4 × 7	5.0
1	010							4 × 7	10
2.2	2R2							4 × 7	19
3.3	3R3							4 × 7	24
4.7	4R7					4 × 7	24	5 × 7	29
10	100			4 × 7	29	5 × 7	33	5 × 7	36
22	220	4 × 7	34	5 × 7	38	5 × 7	44	6.3 × 7	51
33	330	5 × 7	42	5 × 7	47	6.3 × 7	57	6.3 × 7	63
47	470	5 × 7	50	6.3 × 7	59	6.3 × 7	68	8 × 7	78
100	101	6.3 × 7	77	8 × 7	96	8 × 7	107		
220	221	8 × 7	130	8 × 7	140				
								Case size $\phi D \times L$ (mm)	Rated ripple

Rated ripple current 120Hz

## Frequency coefficient of rated ripple current

Frequency	50 Hz	120 Hz	300 Hz	1 kHz	10 kHz or more
Coefficient	0.70	1.00	1.17	1.36	1.50

Please refer to page 20, 21, 22 about the formed or taped product spec.  
Please refer to page 4 for the minimum order quantity.

CAT.8100Y