

## TH-12 Catch-Off Hinge



### Characteristic

The door can be removed at approximate angle of 40°.

### Application

Measuring instruments /  
Telecommunication devices

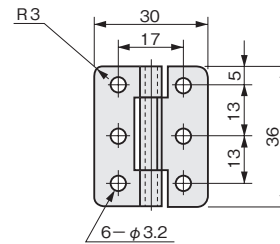

### Parts List

No.	Part Name	Material	Finish	Quantity
1	Hinge Piece (A)	BSP	Ni	1
2	Hinge Piece (B)			1
3	Shaft	BSBM		1

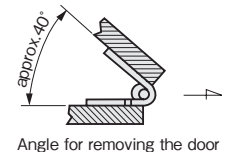
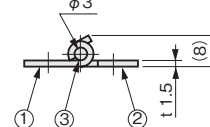

Model No.	Allowable Load N (kgf)	Net Weight (g)	Code No.
TH-12	147 (15)	18	2129

## TH-13 Catch-Off Hinge



### Characteristic

The door can be removed at approximate angle of 40°.

### Application

Measuring instruments /  
Telecommunication devices

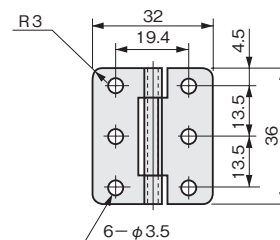

### Parts List

No.	Part Name	Material	Finish	Quantity
1	Hinge Piece (A)	BSP	Ni	1
2	Hinge Piece (B)			1
3	Shaft	BSW		1

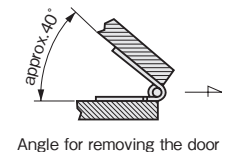
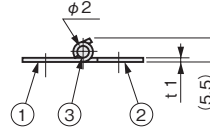

Model No.	Allowable Load N (kgf)	Net Weight (g)	Code No.
TH-13	98.1 (10)	11.5	2130

## TH-17 Catch-Off Hinge



### Characteristic

The door can be removed at approximate angle of 40°.

### Application

Measuring instruments /  
Telecommunication devices

### Note

When using countersunk screws or rivets to attach the hinge; the mounting surface should also be countersunk.

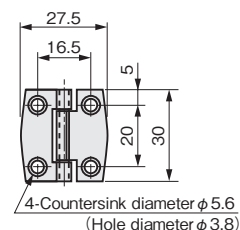

### Parts List

No.	Part Name	Material	Finish	Quantity
1	Hinge Piece (A)	C2801	Ni	1
2	Hinge Piece (B)			1
3	Shaft	C3602		1

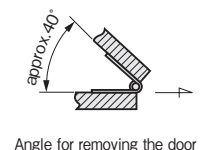
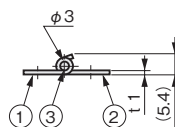

Model No.	Net Weight (g)	Code No.
TH-17	9	2137