

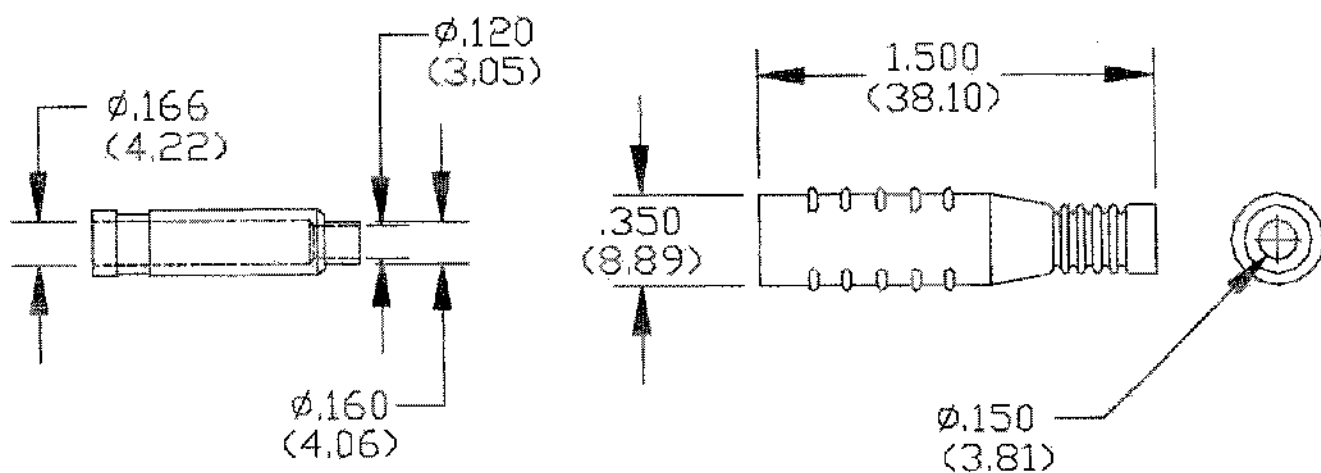

**MODEL: BU-P5168-\***

**Banana Jack (In-Line)**



#### MATERIALS:

Body – Nickel Plated Brass

Insulator – Flexible PVC. Comes in -0 Black, -2 Red

For use with 14 AWG and 16 AWG wires. Can be soldered or crimped

#### RATING:

15 Amps

Hands free testing to 5000 VDC max.

Temperature: -70°C to 50°C