

PRODUCT NUMBER
71959-YXXLF

WHEN REQUIRED, ADD SUFFIX LETTER "LF"
INDICATES THE PRODUCT IS RoHS
COMPATIBLE, SEE NOTE 7

PLATING

3=0.76µm GOLD/GXT ON CONTACT AREA
3.81µm TIN-LEAD ON TAIL

4=3.81µm TIN-LEAD ON CONTACT AREA
AND ON TAIL

WHEN "LF" IS REQUIRED, 2µm MIN
MATTE TIN OVER 1.27µm MIN NICKEL
IS PROVIDED INSTEAD OF TIN-LEAD

STYLE	SIZE	OMIT PIN POSITION FROM TOP VIEW
01	1x03	1
02	1x03	2
03	1x03	3
04	1x07	3;4;5
05	1x04	2;3
06	1x04	1;2;

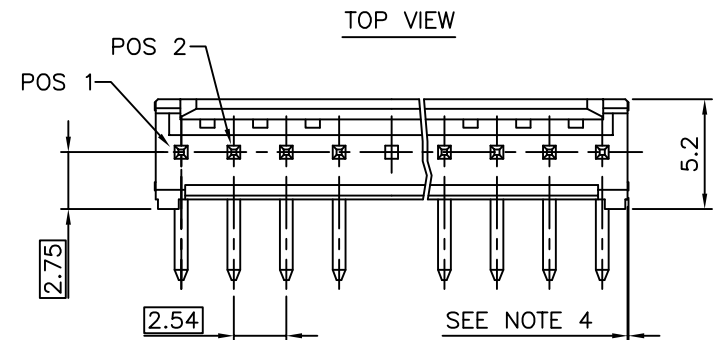

NOTES:

1. BODY MATERIAL: POLYESTER 30% GLASSFILLED COLOR BLUE, FLAME RETARDANT PER UL-94 V0.
2. CONTACT MATERIAL: PHOSPHOR BRONZE.
3. 15N MIN PIN RETENTION IN EITHER DIRECTION
4. 0.6 MAX PROTRUSION PERMITTED AT 4 PLACES
5. PACKAGING :
 - POLYBAGS FROM 02 TO 06 POSITIONS
 - TUBE FROM 07 TO 36 POSITIONS
6. TO DETERMINE DIMENSIONS :
N = NUMBER OF POSITIONS PER ROW
EXAMPLE : 8 POS N x 2.54 = 20.32mm
7. RoHS COMPATIBLE PRODUCT SPECIFICATIONS

- a - PLATING:
 - "LF" MEANS THE PRODUCT IS LEAD-FREE, 2µm MINIMUM MATTE TIN OVER 1.27µm MINIMUM NICKEL UNDERPLATE.
- b - MANUFACTURING PROCESS COMPATIBILITY
 - THE HOUSING WILL WITHSTAND EXPOSURE TO 245°C ±5°C SOLDER BATH TEMPERATURE FOR 5 SECONDS IN A WAVE SOLDER APPLICATION WITH A 1.6mm MIN THICK CIRCUIT BOARD.
- c - LABELING:
 - MEETS PACKAGING SPECS AS PER GS-14-920
- d - LEGAL STATEMENT: SEE GS-22-008

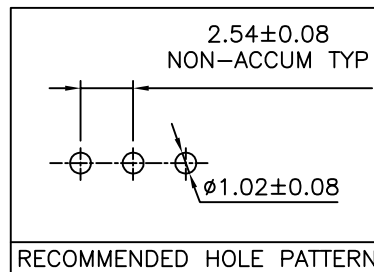
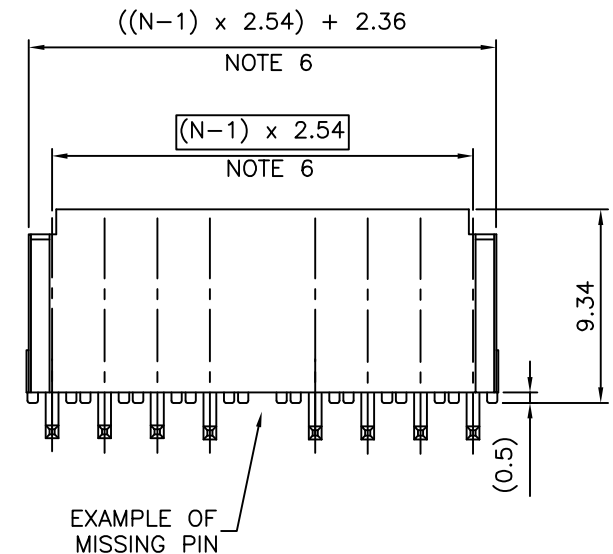
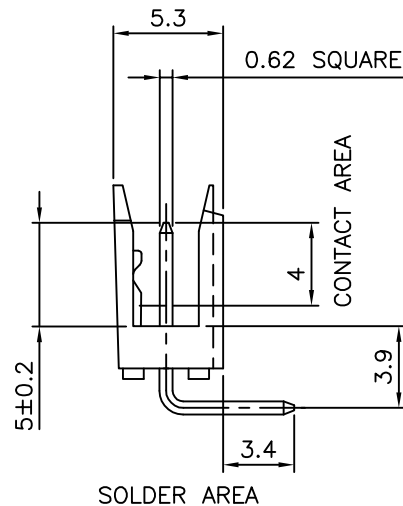

mat'l. code SEE P/N				surface ISO 1302	tolerance ISO 406 ISO 1101	projection mm	product family DUBOX HDR
H	F08-0147	YOV	08.04.14	angles	.X ±0.3	mm	title DUBOX,SR,RA SELECTIVELY LOADED
J	B-14263	LMU	13.03.14	linear	.XX ±0.15	scale 4:1	dwg no 71959
K	F-21810	AMA	15.06.19		.XXX ±0.05		sheet 1 of 1 size A3
E	F05-0156	LMU	03.05.22	dr	COMPAGNON J 95.04.11	FCI	type CUSTOMER Drawing
F	F05-0244	JCO	05.09.06	enr	PHAMVAN JM 95.04.11		
G	F06-0228	LMU	06.07.11	chr	JMC 95.04.11		
				app	JMP 95.04.11		
sheet index	revision sheet						