

F

E

D

C

B

A

F

E

D

C

B

A

FACE VIEW-FEMALE INSERT		
1 BLACK 2 WHITE	1 BLACK 2 WHITE 3 GREEN-VERDE	1 BLACK 2 GREEN 3 RED 4 WHITE

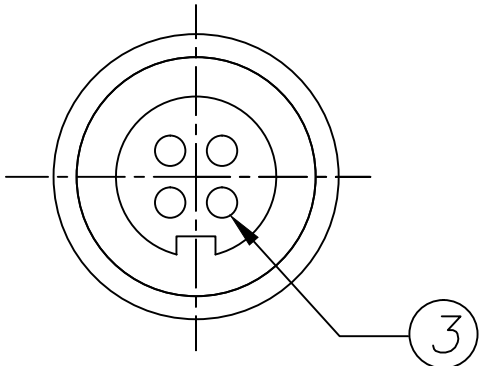
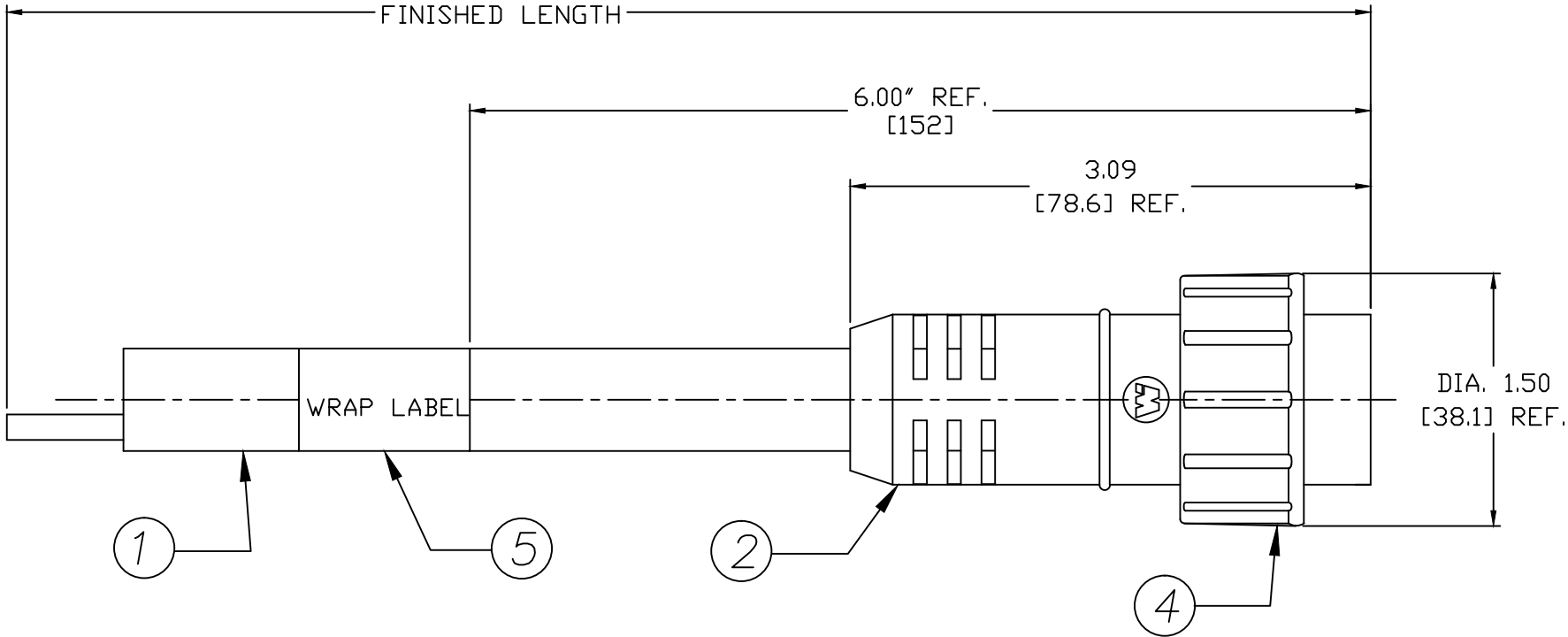

CONNECTOR SPECIFICATION:

VOLTAGE RATING	600V AC/DC
AMPERAGE RATING	2P: 25 AMPS, 3P: 25 AMPS, 4P: 20 AMPS
PROTECTION	IP67
OPERATING TEMP.	-20°C TO 105°C
UL CERTIFICATIONS	UL RECOGNIZED, FILE NO. E46237

POLES	MATERIAL NO.	ENGINEERING NO.	FINISHED LENGTH
4	1300000088	32678	6.0 FT. +2.19"-0 [183CM+56mm-0]
4	1300000090	32679	12.0 FT. +3.50"-0 [366 CM +89mm-0]

5	LABEL	VINYL	YELLOW
4	COUPLING	THERMOPLASTIC	BLACK
3	CONTACT SOCKET	COPPER ALLOY	UN-PLATED
2	OVERMOLD	RUBBER	YELLOW
1	CABLE-12 AWG SOW	CPE JACKET	YELLOW
ITEM	COMPONENT	MATERIAL	FINISH

RELEASED EC NO: IPG2013-0663 DRWN: RSTONE 2012/11/26 CHKD: K JOZWIK APPR: JFMURPHY 2013/02/07	DESCRIPTION	QUALITY SYMBOLS <div>▽=0</div> <div>▽C=0</div>	GENERAL TOLERANCES (UNLESS SPECIFIED)			DIMENSION STYLE INCH/MM		SCALE 4:1	DESIGN UNITS INCH	<div>THIRD ANGLE PROJECTION</div>	TITLE QUICK CHANGE CABLE ASSY 2-4P FEMALE, 12 AWG ----- MOLEX INCORPORATED		
				mm	INCH	DRAWN BY RSTONE	DATE 2012/11/26	DOCUMENT NO. SD-130000-005	SHEET NO. 1 OF 1				
			4 PLACES	±---	±---	CHECKED BY K JOZWIK	DATE 2012/11/28						
			3 PLACES	±---	±---	APPROVED BY JFMURPHY	DATE 2013/02/07						
			2 PLACES	±---	±.01	MATERIAL NO. SEE CHART							
			1 PLACE	±0.3	±---	SIZE B							
			ANGULAR ±2°			THIS DRAWING CONTAINS INFORMATION THAT IS PROPRIETARY TO MOLEX INCORPORATED AND SHOULD NOT BE USED WITHOUT WRITTEN PERMISSION							
DRAFT WHERE APPLICABLE MUST REMAIN WITHIN DIMENSIONS													
A	REV												