



Photoelectric sensors
W12-3, Photoelectric proximity sensor,
Background suppression

WTB12-3P2431



Model Name > [WTB12-3P2431](#)
Part No. > [1041411](#)



At a glance

- State of the art technology provides precise background suppression
- Withstands harsh environments
- PinPoint LED technology with highly visible light spot; variants available with IR LED for highly critical applications
- Rugged die-cast zinc housing, with optional Teflon® coating
- Versatile mounting options due to dovetail mounting - mounting holes and oblong holes
- Highly visible status LEDs
- Sensing range adjustment with potentiometer or teach-in pushbutton
- IO-Link communication available (optional)

Your benefits

State of the art technology, e.g. OES3 provides precise background suppression and reliable detection of challenging objects

High immunity to ambient light, optical reflections and crosstalk ensures fewer false readings and less downtime

PinPoint LED technology provides a highly visible light spot that enables quick and easy sensor alignment

Highly visible status LEDs simplify sensing distance adjustments and reduce installation time

A rugged metal housing withstands high-pressure cleaners and cleaning agents, reducing downtime

Complementary outputs in one housing reduce inventory and procurement costs

IO-Link enables quick remote diagnostics and maintenance (optional)

Easy installation using SICK accessories



Features

| | |
|----------------------------------|--------------------------------|
| Dimensions (W x H x D): | 15.6 mm x 48.5 mm x 42 mm |
| Sensing range max.: | 20 mm ... 350 mm ¹⁾ |
| Sensing range: | 20 mm ... 350 mm |
| Housing design (light emission): | Rectangular |
| Light source: | LED ²⁾ |
| Type of light: | Visible red light |

| | |
|-----------------------------|--|
| Wave length: | 640 nm |
| Sensitivity adjustment: | Potentiometer, 5-turn |
| Sensor/detection principle: | Photoelectric proximity sensor, Background suppression |
| Light spot (distance): | 6 mm (200 mm) |

¹⁾ Object with 90 % reflectance (referred to standard white DIN 5033) ²⁾ Average service life 100,000 h at Ta = +25 °C

Mechanics/electronics

| | |
|-----------------------------------|---|
| Enclosure rating: | IP 66 IP 67 IP 69K |
| Supply voltage: | 10 V DC ... 30 V DC ¹⁾ |
| Residual ripple: | ≤ 5 Vpp ²⁾ |
| Power consumption: | ≤ 45 mA ³⁾ |
| Switching output: | PNP, light/dark-switching, Complementary |
| Output current I _{max} : | 100 mA ⁴⁾ |
| Response time: | ≤ 330 μs ⁵⁾ |
| Switching frequency: | 1,500 Hz ⁵⁾ |
| Connection type: | Connector M12, 4-pin |
| Protection class: | II |
| Circuit protection::: | A, C, D ⁶⁾ ⁷⁾ ⁸⁾ |
| Weight: | 120 g |
| Ambient operating temperature: | -40 °C ... 60 °C |
| Ambient storage temperature: | -40 °C ... 75 °C |
| Signal voltage PNP HIGH/LOW: | > U _v - 2,5 V/ca. 0 V |
| Special device: | - |
| UL File-No.: | UL No. NRKH.E181493 & cUL No. NRKH7.E181493 |

¹⁾ Limit values, operation in short-circuit protected network max. 8 A ²⁾ May not exceed or fall short of V_S ³⁾ Without load ⁴⁾ Signal transit time with resistive load ⁵⁾ Without load
⁶⁾ A = V_S connections reverse-polarity protected ⁷⁾ C = interference suppression ⁸⁾ D = outputs overcurrent and short-circuit protected

Dimensional drawing

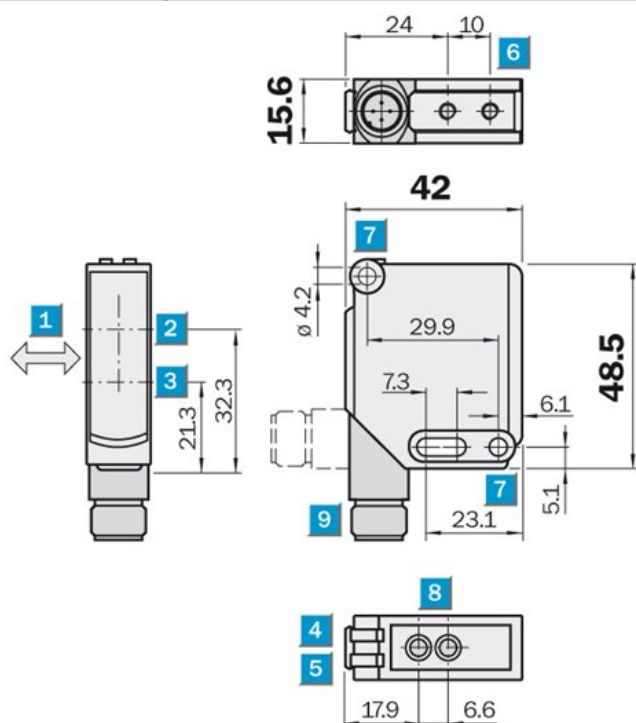

- [1] Standard direction of the material being scanned
- [2] Optical axis, receiver
- [3] Optical axis, sender
- [4] Status indicator LED green: supply voltage active
- [5] Status indicator LED, yellow: Status of received light beam
- [6] M4 threaded mounting hole, 4 mm deep
- [7] Mounting hole, Ø 4.2 mm
- [8] Scanning distance adjustment, double Teach button
- [9] Connection

Einstell-Möglichkeiten

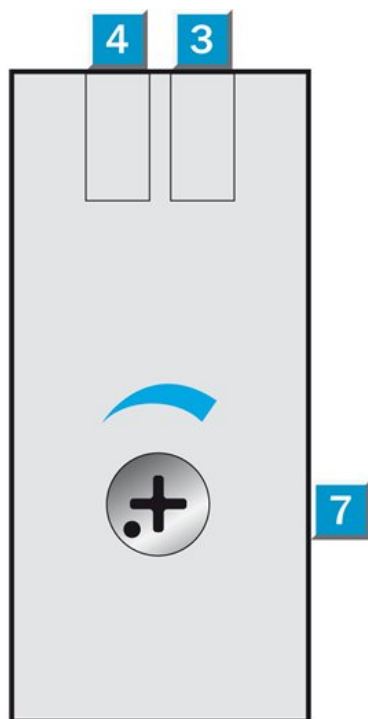

- [3] Status indicator LED, yellow: Status of received light beam
- [4] Status indicator LED green: supply voltage active
- [7] Sensing distance adjustment: Poti

Connection diagram

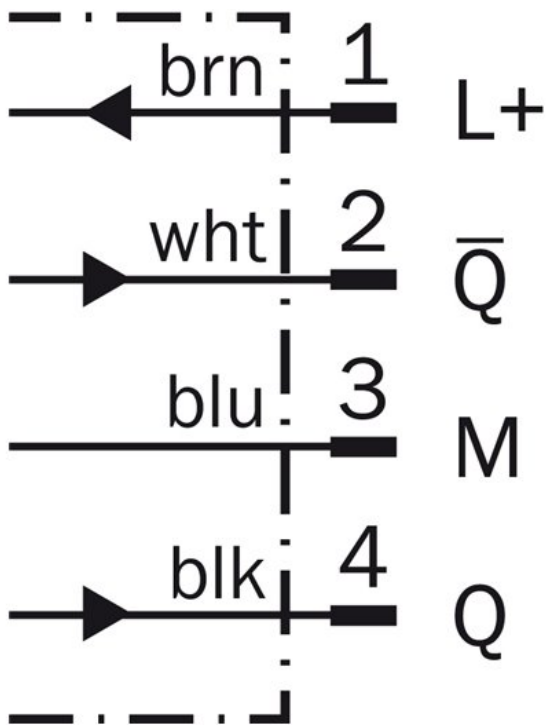

Connection type

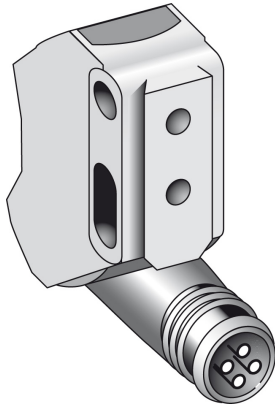

Characteristic curve

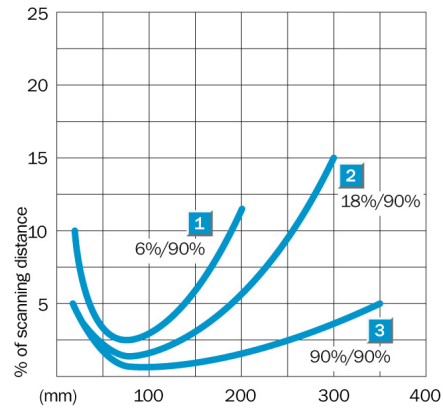

Sensing range diagram

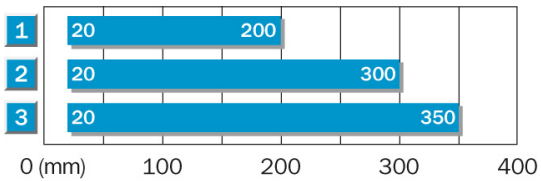

| | |
|---|---|
| 1 | Scanning distance on black, 6 % Remission |
| 2 | Scanning distance on grey, 18 % Remission |
| 3 | Scanning on white, 90 % Remission |

Australia

Phone +61 3 9497 4100
1800 334 802 – tollfree
E-Mail sales@sick.com.au

Belgium/Luxembourg

Phone +32 (0)2 466 55 66
E-Mail info@sick.be

Brasil

Phone +55 11 3215-4900
E-Mail sac@sick.com.br

Canada

Phone +1(952) 941-6780
1 800-325-7425 – tollfree
E-Mail info@sickusa.com

Ceská Republika

Phone +420 2 57 91 18 50
E-Mail sick@sick.cz

China

Phone +852-2763 6966
E-Mail ghk@sick.com.hk

Danmark

Phone +45 45 82 64 00
E-Mail sick@sick.dk

Deutschland

Phone +49 211 5301-301
E-Mail kundenservice@sick.de

España

Phone +34 93 480 31 00
E-Mail info@sick.es

France

Phone +33 1 64 62 35 00
E-Mail info@sick.fr

Great Britain

Phone +44 (0)1727 831121
E-Mail info@sick.co.uk

India

Phone +91-22-4033 8333
E-Mail info@sick-india.com

Israel

Phone +972-4-999-0590
E-Mail info@sick-sensors.com

Italia

Phone +39 02 27 43 41
E-Mail info@sick.it

Japan

Phone +81 (0)3 3358 1341
E-Mail support@sick.jp

Magyarország

Phone +36 1 371 2680
E-Mail office@sick.hu

Nederlands

Phone +31 (0)30 229 25 44
E-Mail info@sick.nl

Norge

Phone +47 67 81 50 00
E-Mail austefjord@sick.no

Österreich

Phone +43 (0)22 36 62 28 8-0
E-Mail office@sick.at

Polska

Phone +48 22 837 40 50
E-Mail info@sick.pl

România

Phone +40 356 171 120
E-Mail office@sick.ro

Russia

Phone +7 495 775 05 30
E-Mail info@sick.ru

Schweiz

Phone +41 41 619 29 39
E-Mail contact@sick.ch

Singapore

Phone +65 6744 3732
E-Mail admin@sicksgp.com.sg

South Africa

Phone +27 11 472 3733
E-Mail info@sickautomation.co.za

South Korea

Phone +82-2 786 6321/4
E-Mail info@sickkorea.net

Slovenija

Phone +386 (0)1-47 69 990
E-Mail office@sick.si

Suomi

Phone +358-9-25 15 800
E-Mail sick@sick.fi

Sverige

Phone +46 10 110 10 00
E-Mail info@sick.se

Taiwan

Phone +886 2 2375-6288
E-Mail sales@sick.com.tw

Türkiye

Phone +90 216 528 50 00
E-Mail info@sick.com.tr

United Arab Emirates

Phone +971 4 8865 878
E-Mail info@sick.ae

USA/México

Phone +1(952) 941-6780
1 800-325-7425 – tollfree
E-Mail info@sickusa.com

More representatives and agencies
at www.sick.com