

# P25SMT

SMT GULL WING SURFACE MOUNT  
TECHNOLOGY



## FEATURES

- 2.5mm height
- 7.0mm length
- lateral C-contact
- contacts with abrasion resistant hard gold plating
- solid, tinned PCB pins

Solid PCB pins ensure trouble-free assembly and safe connection. Contacts with abrasion resistant hard gold plating have low and stable contact resistance. ISO 9001:2000 approved production together with 100% electronic final inspection and testing guarantee reliable operation. Figures are clearly visible and detention mechanism is precise for fast and easy operation.

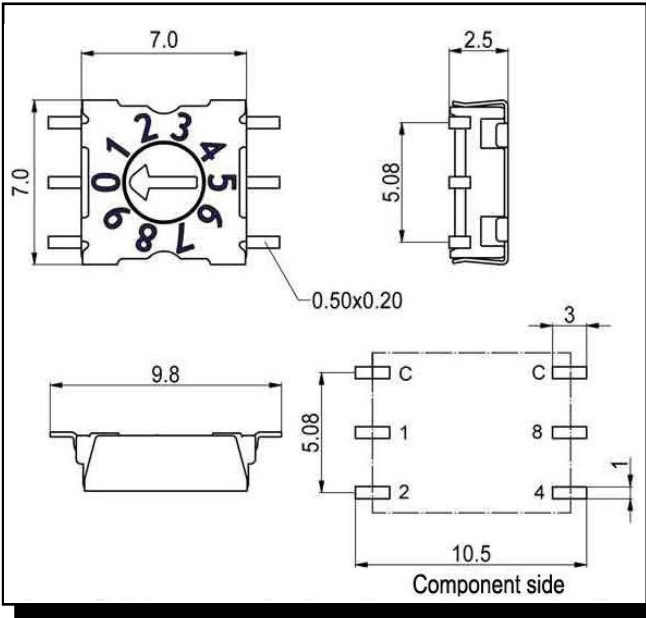

## GENERAL SPECIFICATIONS

### MECHANICAL DATA

|                             |                        |
|-----------------------------|------------------------|
| Type                        | horizontal             |
| Fixation mode               | SMT                    |
| Height                      | 2.5 mm                 |
| Length                      | 7.0 mm                 |
| Width                       | 7.0 mm                 |
| Pin connection              | 3+3                    |
| Perm. ambient temperature   | -50 ... +125 °C        |
| Perm. storage temperature   | -55 ... +135 °C        |
| Torque                      | min. 0.7 Ncm           |
| Positions per rotation      | 10, 16                 |
| Shock and vibration testing | acc. DIN IEC 60068     |
| Humidity                    | 21 days at 40°C, 93%RH |

### ELECTRICAL DATA

|                       |                |
|-----------------------|----------------|
| Operating voltage     | ≤ 42 V         |
| Contact load, static  | ≤ 0.4 A        |
| Contact load, dynamic | ≤ 0.1 A        |
| Minimum load          | 1µA 20mVDC     |
| Test voltage          | 250V 50Hz/1min |
| Contact resistance    | < 80 mΩ        |
| Insulation resistance | > 100 MΩ       |

### CODES

|                        | Pos | Rotor  | Code                    |
|------------------------|-----|--------|-------------------------|
| BCD                    | 10  | red    | ○ Code: P25SMT _ 01 _ _ |
| BCD Complement         | 10  | orange | ○ Code: P25SMT _ 02 _ _ |
| Hexadecimal            | 16  | grey   | ○ Code: P25SMT _ 03 _ _ |
| Hexadecimal Complement | 16  | white  | ○ Code: P25SMT _ 06 _ _ |



Arrow shaped slot  
○ Code: P25SMT 1 \_ \_



Spindle  
○ Code: P25SMT 3 \_ \_



Slotted spindle  
○ Code: P25SMT 8 \_ \_