

POWER COMBICON Plugs and Headers PC 6/... for Currents up to 41 A, 10.16 mm Pitch

The PC 6 plug connector features highly conductive metal alloys to offer a current carrying capacity of 41 A at a rated voltage of 1000 V. A double steel spring on the female side offers additional contact reliability especially in the case of extreme fluctuations of power or temperature.

The plugs are also available with a screw flange for vibration-proof connection to the headers, with 2 to 8 positions.

The plugs and headers are coded with the CP-HCC 4. coding profile. The self-adhesive marker cards SK 10/5 are used for labeling (see COMBICON catalog).

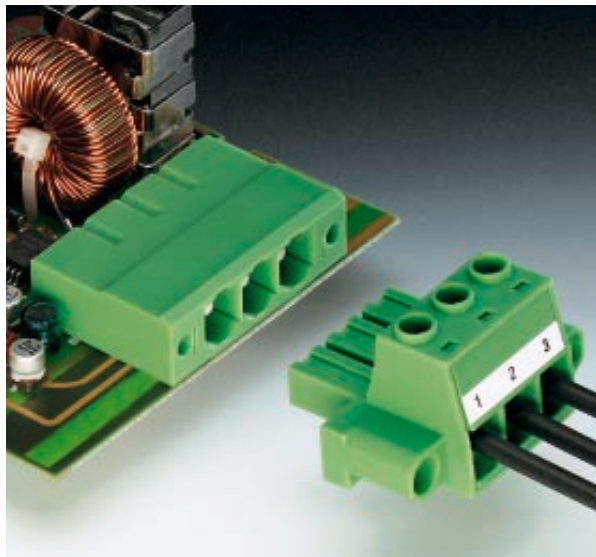

PC 6/...-ST-10,16

10.16 mm Pitch



Note:

COMBICON plug connectors may only be actuated in the no-load condition. If smaller loads need to be switched for operational reasons, experimental values are available on request.

| Description | No. of positions | Dim. a [mm] |
|--|------------------|-------------------|
| POWER COMBICON plugs, 10.16 mm pitch, color: green | 2 | 10.16 |
| | 3 | 20.32 |
| | 4 | 30.48 |
| | 5 | 40.64 |
| | 6 | 50.80 |
| | 7 | 60.96 |
| | 8 | 71.12 |

(1) **Coding profile**, is inserted into the recess on the plug and header, insulating material: red



(2) **Marker card**, with 10 pcs. 10-section marker strips, white, self-adhesive, for 100 terminal blocks

(3) **Screwdriver**, blade: 1.0 x 4.0 x 100 mm, length: 200 mm



Technical data

| | |
|----------------|-----------|
| Dimensions | |
| Pitch | [mm] |
| Hole diameter | [mm] |
| Pin dimensions | [mm]x[mm] |

Technical data in accordance with IEC/ DIN VDE

| | |
|--|-----------|
| Insulating material group | — |
| Surge voltage category / contamination class | —/— |
| Rated voltage | [V] |
| Rated surge voltage | [kV] |
| Nominal current / cross section | [A]/[mm²] |
| Maximum load current / cross section | [A]/[mm²] |

Connection capacity

| | |
|---|-----------------|
| Solid / stranded / conductor sizes | [mm²]/[mm²]/AWG |
| Stranded with ferrule without / with plastic sleeve | [mm²] |

Multiple connection (2 conductors with same cross section)

| | |
|--|-------|
| Solid / stranded | [mm²] |
| Stranded with ferrule with plastic sleeve | [mm²] |
| Stranded with TWIN ferrule with plastic sleeve | [mm²] |

Stripping length

| | |
|--|------|
| | [mm] |
|--|------|

Internal cylindrical gauge (IEC 60 947-1)

Thread

| | |
|--|------|
| | [Nm] |
|--|------|

Insulating material

Inflammability class in acc. with UL 94

Approval data (UL/CUL and CSA)

| | |
|---|---------------------|
| Nominal voltage / current / conductor sizes | UL/CUL: [V]/[A]/AWG |
| | CSA: [V]/[A]/AWG |

| Type | Order No. | Pcs./Pkt. |
|--------------------------------|------------|-----------|
| PC 6/2-ST-10,16 | 19 13 50 7 | 50 |
| PC 6/3-ST-10,16 | 19 13 51 0 | |
| PC 6/4-ST-10,16 | 19 13 52 3 | |
| PC 6/5-ST-10,16 | 19 13 53 6 | |
| PC 6/6-ST-10,16 | 19 13 54 9 | 50 |
| PC 6/7-ST-10,16 | 19 13 55 2 | |
| PC 6/8-ST-10,16 | 19 13 56 5 | |
| CP-HCC 4 | 16 00 02 7 | 100 |
| SK 10/5 (see COMBICON catalog) | | |
| SZS 1,0 x 4,0 | 12 05 06 6 | 10 |

see description

10.16

—

—

| | | |
|---------|----------|--------|
| | I | |
| III / 3 | III / 2 | II / 2 |
| 1000 | 1000 | 1000 |
| 8 | 8 | 8 |
| | 41 / 6.0 | |
| | 41 / 6.0 | |

0.5 - 10.0 / 0.5 - 6.0 / 20 - 7
0.5 - 6.0 / 0.5 - 6.0

0.5 - 6.0 / 0.5 - 6.0
0.5 - 2.5
0.5 - 4.0

12

A 5

M 4

1.2 - 1.5

PA

V0

600 / 41 / 20 - 8

—

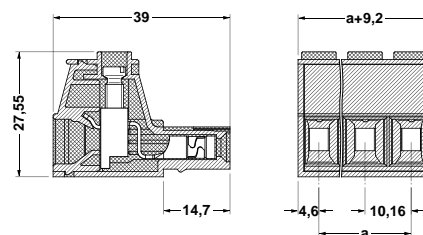

PC 6/...-STF-10,16 with Screw Flange 10.16 mm Pitch



HNote:

COMBICON plug connectors may only be actuated in the no-load condition. If smaller loads need to be switched for operational reasons, experimental values are available on request.

| Description | No. of positions | Dim. a [mm] |
|--|------------------|-------------------|
| POWER COMBICON plugs, 10.16 mm pitch, color: green, with screw flange | 2 | 10.16 |
| | 3 | 20.32 |
| | 4 | 30.48 |
| | 5 | 40.64 |
| | 6 | 50.80 |
| | 7 | 60.96 |
| | 8 | 71.12 |

(1) **Coding profile**, is inserted into the recess on the plug and header, insulating material: red



(2) **Marker card**, with 10 pcs. 10-section marker strips, white, self-adhesive, for 100 terminal blocks

(3) **Screwdriver**, blade: 1.0 x 4.0 x 100 mm, length: 200 mm



Technical data

| | |
|----------------|-----------|
| Dimensions | |
| Pitch | [mm] |
| Hole diameter | [mm] |
| Pin dimensions | [mm]x[mm] |

Technical data in accordance with IEC/ DIN VDE

| | |
|--|-----------|
| Insulating material group | — |
| Surge voltage category / contamination class | —/— |
| Rated voltage | [V] |
| Rated surge voltage | [kV] |
| Nominal current / cross section | [A]/[mm²] |
| Maximum load current / cross section | [A]/[mm²] |

Connection capacity

| | |
|---|-----------------|
| Solid / stranded / conductor sizes | [mm²]/[mm²]/AWG |
| Stranded with ferrule without / with plastic sleeve | [mm²] |

Multiple connection (2 conductors with same cross section)

| | |
|--|-------|
| Solid / stranded | [mm²] |
| Stranded with ferrule with plastic sleeve | [mm²] |
| Stranded with TWIN ferrule with plastic sleeve | [mm²] |

Stripping length

| | |
|--|------|
| | [mm] |
|--|------|

Internal cylindrical gauge (IEC 60 947-1)

Thread

| | |
|--|------|
| | [Nm] |
|--|------|

Insulating material

Inflammability class in acc. with UL 94

Approval data (UL/CUL and CSA)

| | |
|---|---------------------|
| Nominal voltage / current / conductor sizes | UL/CUL: [V]/[A]/AWG |
| | CSA: [V]/[A]/AWG |

| Type | Order No. | Pcs./Pkt. |
|--------------------------------|------------|-----------|
| PC 6/2-STF-10,16 | 19 13 57 8 | 50 |
| PC 6/3-STF-10,16 | 19 13 58 1 | |
| PC 6/4-STF-10,16 | 19 13 59 4 | |
| PC 6/5-STF-10,16 | 19 13 60 4 | |
| PC 6/6-STF-10,16 | 19 13 61 7 | 10 |
| PC 6/7-STF-10,16 | 19 13 62 0 | |
| PC 6/8-STF-10,16 | 19 13 63 3 | |
| CP-HCC 4 | 16 00 02 7 | 100 |
| SK 10/5 (see COMBICON catalog) | | |
| SZS 1,0 x 4,0 | 12 05 06 6 | 10 |

see description

10.16

—

—

| | | |
|---------|----------|--------|
| | I | |
| III / 3 | III / 2 | II / 2 |
| 1000 | 1000 | 1000 |
| 8 | 8 | 8 |
| | 41 / 6.0 | |
| | 41 / 6.0 | |

0.5 - 10.0 / 0.5 - 6.0 / 20 - 7
0.5 - 6.0 / 0.5 - 6.0

0.5 - 6.0 / 0.5 - 6.0
0.5 - 2.5
0.5 - 4.0

12

A 5

M 4

1.2 - 1.5

PA

V0

600 / 41 / 20 - 8

—

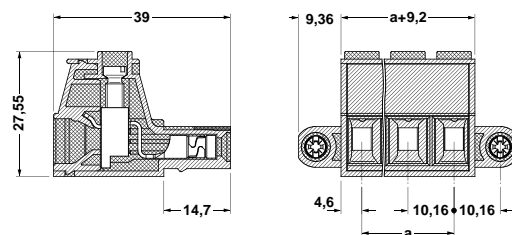

PC 6/...-G-10,16

10.16 mm Pitch

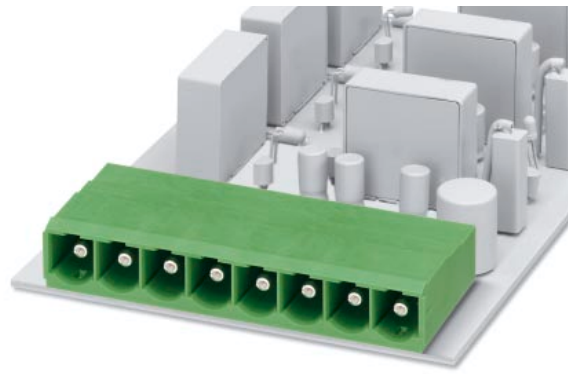

Note:

COMBICON plug connectors may only be actuated in the no-load condition. If smaller loads need to be switched for operational reasons, experimental values are available on request.

| Description | No. of positions | Dim. a [mm] |
|--|------------------|-------------------|
| POWER COMBICON headers, 10.16 mm pitch, color: green, plug-in direction parallel to the PCB | 2 | 10.16 |
| | 3 | 20.32 |
| | 4 | 30.48 |
| | 5 | 40.64 |
| | 6 | 50.80 |
| | 7 | 60.96 |
| | 8 | 71.12 |

(1) **Coding profile**, is inserted into the recess on the plug and header, insulating material: red



(2) **Marker card**, with 10 pcs.
10-section marker strips, white,
self-adhesive, for 100 terminal blocks

Technical data

| | |
|----------------|-----------|
| Dimensions | |
| Pitch | [mm] |
| Hole diameter | [mm] |
| Pin dimensions | [mm]x[mm] |

Technical data in accordance with IEC/ DIN VDE

| | |
|--|-----------|
| Insulating material group | - |
| Surge voltage category / contamination class | -/- |
| Rated voltage | [V] |
| Rated surge voltage | [kV] |
| Nominal current / cross section | [A]/[mm²] |
| Maximum load current / cross section | [A]/[mm²] |

Connection capacity

| | |
|---|-----------------|
| Solid / stranded / conductor sizes | [mm²]/[mm²]/AWG |
| Stranded with ferrule without / with plastic sleeve | [mm²] |

Multiple connection (2 conductors with same cross section)

| | |
|--|-------|
| Solid / stranded | [mm²] |
| Stranded with ferrule with plastic sleeve | [mm²] |
| Stranded with TWIN ferrule with plastic sleeve | [mm²] |

Stripping length [mm]

Internal cylindrical gauge (IEC 60 947-1)

Thread

Torque [Nm]

Insulating material

Inflammability class in acc. with UL 94

Approval data (UL/CUL and CSA)

| | |
|---|---|
| Nominal voltage / current / conductor sizes | UL/CUL: [V]/[A]/AWG CSA: [V]/[A]/AWG |
|---|---|

1) 1000 V on printed circuit board.

| Type | Order No. | Pcs./Pkt. |
|--------------------------------|------------|-----------|
| PC 6/2-G-10,16 | 19 13 64 6 | 50 |
| PC 6/3-G-10,16 | 19 13 65 9 | |
| PC 6/4-G-10,16 | 19 13 66 2 | |
| PC 6/5-G-10,16 | 19 13 67 5 | |
| PC 6/6-G-10,16 | 19 13 68 8 | 100 |
| PC 6/7-G-10,16 | 19 13 69 1 | |
| PC 6/8-G-10,16 | 19 13 70 1 | |
| CP-HCC 4 | 16 00 02 7 | 100 |
| SK 10/5 (see COMBICON catalog) | | |

see description

10.16

1.7

1.0 x 1.2

| | | |
|-------------------|---------|--------|
| | I | |
| III / 3 | III / 2 | II / 2 |
| 630 ¹⁾ | 1000 | 1000 |
| 6 | 8 | 8 |
| | 41 / - | |
| | 41 / - | |

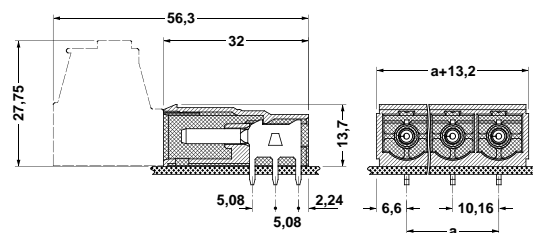
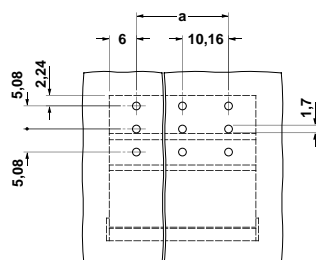

PC 6/...-GF-10,16 with Threaded Flange 10.16 mm Pitch

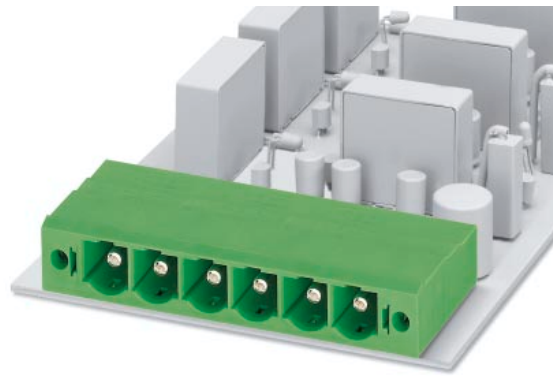

Note:

COMBICON plug connectors may only be actuated in the no-load condition. If smaller loads need to be switched for operational reasons, experimental values are available on request.

| Description | No. of positions | Dim. a [mm] |
|---|------------------|-------------------|
| POWER COMBICON headers, 10.16 mm pitch, color: green, plug-in direction parallel to the PCB, with threaded flange | 2 | 10.16 |
| | 3 | 20.32 |
| | 4 | 30.48 |
| | 5 | 40.64 |
| | 6 | 50.80 |
| | 7 | 60.96 |
| | 8 | 71.12 |

(1) **Coding profile**, is inserted into the recess on the plug and header, insulating material: red



(2) **Marker card**, with 10 pcs.
10-section marker strips, white,
self-adhesive, for 100 terminal blocks

Technical data

| | |
|----------------|-----------|
| Dimensions | |
| Pitch | [mm] |
| Hole diameter | [mm] |
| Pin dimensions | [mm]x[mm] |

Technical data in accordance with IEC/ DIN VDE

| | |
|--|-----------|
| Insulating material group | - |
| Surge voltage category / contamination class | -/- |
| Rated voltage | [V] |
| Rated surge voltage | [kV] |
| Nominal current / cross section | [A]/[mm²] |
| Maximum load current / cross section | [A]/[mm²] |

Connection capacity

| | |
|---|-----------------|
| Solid / stranded / conductor sizes | [mm²]/[mm²]/AWG |
| Stranded with ferrule without / with plastic sleeve | [mm²] |

Multiple connection (2 conductors with same cross section)

| | |
|--|-------|
| Solid / stranded | [mm²] |
| Stranded with ferrule with plastic sleeve | [mm²] |
| Stranded with TWIN ferrule with plastic sleeve | [mm²] |

Stripping length [mm]

Internal cylindrical gauge (IEC 60 947-1)

Thread

Torque [Nm]

Insulating material

Inflammability class in acc. with UL 94

Approval data (UL/CUL and CSA)

| | |
|---|---------------------------------------|
| Nominal voltage / current / conductor sizes | UL/CUL:[V]/[A]/AWG CSA:[V]/[A]/AWG |
|---|---------------------------------------|

¹⁾ 1000 V on printed circuit board.

| Type | Order No. | Pcs./Pkt. |
|---------------------------------------|-------------------|-----------|
| PC 6/2-GF-10,16 | 19 13 71 4 | 50 |
| PC 6/3-GF-10,16 | 19 13 72 7 | |
| PC 6/4-GF-10,16 | 19 13 73 0 | |
| PC 6/5-GF-10,16 | 19 13 74 3 | |
| PC 6/6-GF-10,16 | 19 13 75 6 | 100 |
| PC 6/7-GF-10,16 | 19 13 76 9 | |
| PC 6/8-GF-10,16 | 19 13 77 2 | |
| CP-HCC 4 | 16 00 02 7 | 100 |
| SK 10/5 (see COMBICON catalog) | | |

see description

10.16

1.7

1.0 x 1.2

| | | |
|-------------------|---------|--------|
| | I | |
| III / 3 | III / 2 | II / 2 |
| 630 ¹⁾ | 1000 | 1000 |
| 6 | 8 | 8 |
| | 41 / - | |
| | 41 / - | |

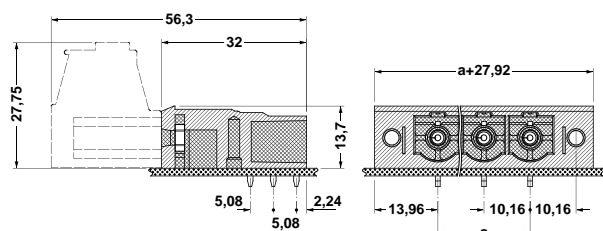
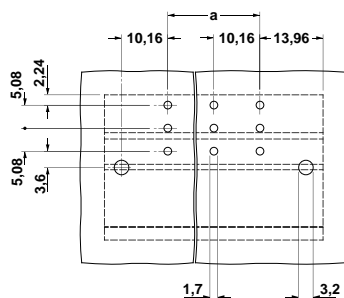

PCV 6/...-G-10,16

10.16 mm Pitch

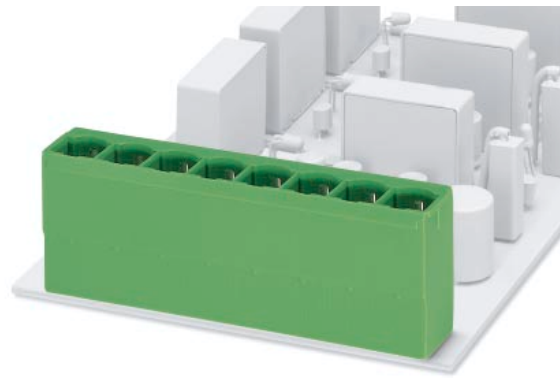

Note:

COMBICON plug connectors may only be actuated in the no-load condition. If smaller loads need to be switched for operational reasons, experimental values are available on request.

| Description | No. of positions | Dim. a [mm] |
|---|------------------|-------------------|
| POWER COMBICON headers, 10.16 mm pitch, color: green, plug-in direction vertical to the PCB, | 2 | 10.16 |
| | 3 | 20.32 |
| | 4 | 30.48 |
| | 5 | 40.64 |
| | 6 | 50.80 |
| | 7 | 60.96 |
| | 8 | 71.12 |
| | 9 | 81.28 |

(1) **Coding profile**, is inserted into the recess on the plug and header, insulating material: red



(2) **Marker card**, with 10 pcs.
10-section marker strips, white,
self-adhesive, for 100 terminal blocks

Technical data

| | |
|----------------|-----------|
| Dimensions | |
| Pitch | [mm] |
| Hole diameter | [mm] |
| Pin dimensions | [mm]x[mm] |

Technical data in accordance with IEC/ DIN VDE

| | |
|--|-----------|
| Insulating material group | — |
| Surge voltage category / contamination class | —/— |
| Rated voltage | [V] |
| Rated surge voltage | [kV] |
| Nominal current / cross section | [A]/[mm²] |
| Maximum load current / cross section | [A]/[mm²] |

Connection capacity

| | |
|---|-----------------|
| Solid / stranded / conductor sizes | [mm²]/[mm²]/AWG |
| Stranded with ferrule without / with plastic sleeve | [mm²] |

Multiple connection (2 conductors with same cross section)

| | |
|--|-------|
| Solid / stranded | [mm²] |
| Stranded with ferrule with plastic sleeve | [mm²] |
| Stranded with TWIN ferrule with plastic sleeve | [mm²] |

Stripping length

Internal cylindrical gauge (IEC 60 947-1)

Thread

Torque

Insulating material

Inflammability class in acc. with UL 94

Approval data (UL/CUL and CSA)

Nominal voltage / current / conductor sizes UL/CUL:[V]/[A]/AWG
CSA:[V]/[A]/AWG

1) 1000 V on printed circuit board.

| Type | Order No. | Pcs./Pkt. |
|--------------------------------|------------|-----------|
| PCV 6/2-G-10,16 | 19 22 48 8 | 50 |
| PCV 6/3-G-10,16 | 19 22 49 1 | |
| PCV 6/4-G-10,16 | 19 22 50 1 | |
| PCV 6/5-G-10,16 | 19 22 51 4 | 50 |
| PCV 6/6-G-10,16 | 19 22 52 7 | |
| PCV 6/7-G-10,16 | 19 22 53 0 | |
| PCV 6/8-G-10,16 | 19 22 54 3 | 50 |
| PCV 6/9-G-10,16 | 19 22 55 6 | |
| CP-HCC 4 | 16 00 02 7 | 100 |
| SK 10/5 (see COMBICON catalog) | | |

see description

10.16

1.7

1.0 x 1.2

| | | |
|-------------------|---------|--------|
| | I | |
| III / 3 | III / 2 | II / 2 |
| 630 ¹⁾ | 1000 | 1000 |
| 6 | 8 | 8 |
| | 41 / — | |
| | 41 / — | |

—

—

—

—

—

—

—

—

—

—

—

—

—

300 / 41 / —

—

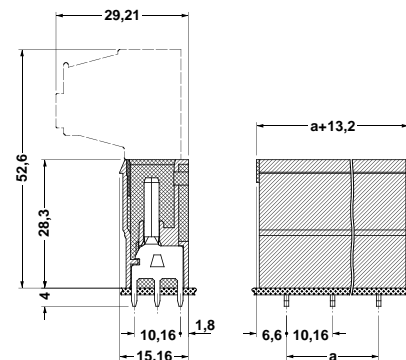
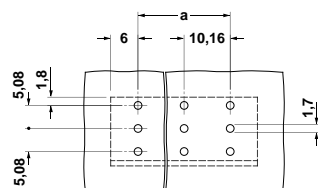

PCV 6/...-GF-10,16 with Threaded Flange 10.16 mm Pitch

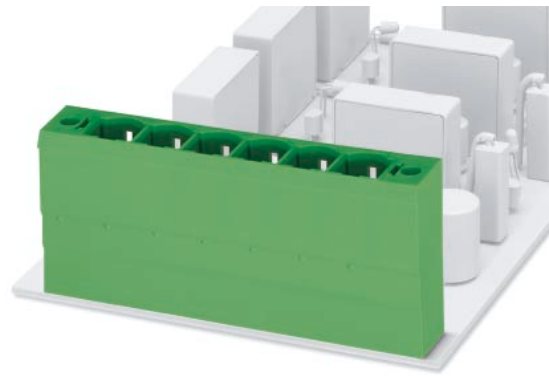

Note:

COMBICON plug connectors may only be actuated in the no-load condition. If smaller loads need to be switched for operational reasons, experimental values are available on request.

| Description | No. of positions | Dim. a [mm] |
|---|------------------|-------------------|
| POWER COMBICON headers, 10.16 mm pitch, color: green, plug-in direction vertical to the PCB, with threaded flange | 2 | 10.16 |
| | 3 | 20.32 |
| | 4 | 30.48 |
| | 5 | 40.64 |
| | 6 | 50.80 |
| | 7 | 60.96 |
| | 8 | 71.12 |

(1) **Coding profile**, is inserted into the recess on the plug and header, insulating material: red



(2) **Marker card**, with 10 pcs. 10-section marker strips, white, self-adhesive, for 100 terminal blocks

Technical data

| | |
|----------------|-----------|
| Dimensions | |
| Pitch | [mm] |
| Hole diameter | [mm] |
| Pin dimensions | [mm]x[mm] |

Technical data in accordance with IEC/ DIN VDE

| | |
|--|-----------|
| Insulating material group | - |
| Surge voltage category / contamination class | -/- |
| Rated voltage | [V] |
| Rated surge voltage | [kV] |
| Nominal current / cross section | [A]/[mm²] |
| Maximum load current / cross section | [A]/[mm²] |

Connection capacity

| | |
|---|-----------------|
| Solid / stranded / conductor sizes | [mm²]/[mm²]/AWG |
| Stranded with ferrule without / with plastic sleeve | [mm²] |

Multiple connection (2 conductors with same cross section)

| | |
|--|-------|
| Solid / stranded | [mm²] |
| Stranded with ferrule with plastic sleeve | [mm²] |
| Stranded with TWIN ferrule with plastic sleeve | [mm²] |

Stripping length [mm]

Internal cylindrical gauge (IEC 60 947-1)

Thread

Torque [Nm]

Insulating material

Inflammability class in acc. with UL 94

Approval data (UL/CUL and CSA)

Nominal voltage / current / conductor sizes UL/CUL:[V]/[A]/AWG
CSA:[V]/[A]/AWG

| Type | Order No. | Pcs./Pkt. |
|---------------------------------|------------|-----------|
| PCV 6/2-GF-10,16 | 19 22 56 9 | 50 |
| PCV 6/3-GF-10,16 | 19 22 57 2 | |
| PCV 6/4-GF-10,16 | 19 22 58 5 | |
| PCV 6/5-GF-10,16 | 19 22 59 8 | |
| PCV 6/6-GF-10,16 | 19 22 60 8 | 100 |
| PCV 6/7-GF-10,16 | 19 22 61 1 | |
| PCV 6/8-GF-10,16 | 19 22 62 4 | |
| CP-HCC 4 | 16 00 02 7 | 100 |
| SK 10/5 (see COMBICON catalog) | | |

see description

10.16

1.7

1.0 x 1.2

| | | |
|-------------------|---------|--------|
| | I | |
| III / 3 | III / 2 | II / 2 |
| 630 ¹⁾ | 1000 | 1000 |
| 6 | 8 | 8 |
| | 41 / - | |
| | 41 / - | |

¹⁾ 1000 V on printed circuit board.

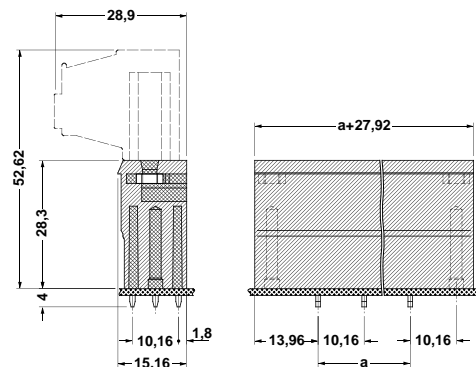
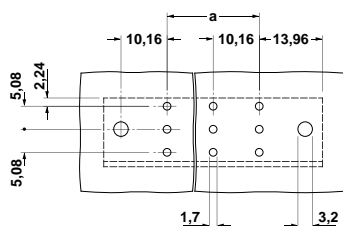

POWER COMBICON Plug-In Block for Direct Mounting, 10.16 mm Pitch

All electronic components are pluggable and easy to maintain. The plug is not connected to the PCB, however, but vice versa.

Plug-in blocks PCU 6/...-STD-10,16 with a screw connection and vertical plug-in direction have a base plate with two mounting ears for screwing onto mounting plates or into component housings.

They are available with 2 to 9 positions and a 10.16 mm pitch.

The self-adhesive marker cards SK 10/5 are used for labeling (see COMBICON catalog)



PCU 6/...-STD-10,16

10.16 mm Pitch



Note:

COMBICON plug connectors may only be actuated in the no-load condition. If smaller loads need to be switched for operational reasons, experimental values are available on request.

| Description | No. of positions | Dim. a [mm] |
|--|------------------|-------------------|
| POWER COMBICON plug-in block, 10.16 mm pitch, color: green | 2 | 10.16 |
| | 3 | 20.32 |
| | 4 | 30.48 |
| | 5 | 40.64 |
| | 6 | 50.80 |
| | 7 | 60.96 |
| | 8 | 71.12 |
| | 9 | 81.28 |

(1) **Coding profile**, is inserted into the recess on the plug and header, insulating material: red



(2) **Marker card**, with 10 pcs. 10-section marker strips, white, self-adhesive, for 100 terminal blocks

(3) **Screwdriver**, blade: 1.0 x 4.0 x 100 mm, length: 200 mm



Technical data

| | |
|----------------|-----------|
| Dimensions | |
| Pitch | [mm] |
| Hole diameter | [mm] |
| Pin dimensions | [mm]x[mm] |

Technical data in accordance with IEC/ DIN VDE

| | |
|--|------------------------|
| Insulating material group | — |
| Surge voltage category / contamination class | —/— |
| Rated voltage | [V] |
| Rated surge voltage | [kV] |
| Nominal current / cross section | [A]/[mm ²] |
| Maximum load current / cross section | [A]/[mm ²] |

Connection capacity

| | |
|---|---|
| Solid / stranded / conductor sizes | [mm ²]/[mm ²]/AWG |
| Stranded with ferrule without / with plastic sleeve | [mm ²] |

Multiple connection (2 conductors with same cross section)

| | |
|--|--------------------|
| Solid / stranded | [mm ²] |
| Stranded with ferrule with plastic sleeve | [mm ²] |
| Stranded with TWIN ferrule with plastic sleeve | [mm ²] |

Stripping length [mm]

Internal cylindrical gauge (IEC 60 947-1)

Thread

Torque [Nm]

Insulating material

Inflammability class in acc. with UL 94

Approval data (UL/CUL and CSA)

| | |
|---|--------------------|
| Nominal voltage / current / conductor sizes | UL/CUL:[V]/[A]/AWG |
| | CSA:[V]/[A]/AWG |

| Type | Order No. | Pcs./Pkt. |
|-------------------|------------|-----------|
| PCU 6/2-STD-10,16 | 19 22 63 7 | 50 |
| PCU 6/3-STD-10,16 | 19 22 64 0 | |
| PCU 6/4-STD-10,16 | 19 22 65 3 | |
| PCU 6/5-STD-10,16 | 19 22 66 6 | 50 |
| PCU 6/6-STD-10,16 | 19 22 67 9 | |
| PCU 6/7-STD-10,16 | 19 22 68 2 | |
| PCU 6/8-STD-10,16 | 19 22 69 5 | 50 |
| PCU 6/9-STD-10,16 | 19 22 70 5 | |

CP-HCC 4 16 00 02 7 100

SK 10/5 (see COMBICON catalog)

SZS 1,0 x 4,0 12 05 06 6 10

see description

10.16

—

—

| | | |
|---------|---------|----------|
| | I | II / 2 |
| III / 3 | III / 2 | 1000 |
| 1000 | 1000 | 8 |
| 8 | 8 | 41 / 6.0 |
| | | 41 / 6.0 |

0.5 - 10.0 / 0.5 - 6.0 / 20 - 7

0.5 - 6.0 / 0.5 - 6.0

0.5 - 6.0 / 0.5 - 6.0

0.5 - 2.5

0.5 - 4.0

12

A 5

M 4

1.2 - 1.5

PA

V0

—

—

