

P.C.B MOUNTING

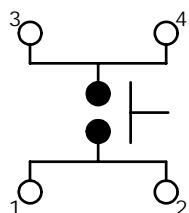

CIRCUIT: SPST

NOTES:

1. ALL DIMENSIONS IN MM [INCH]
2. GENERAL TOLERANCE: X.X=±0.4
X.XX=±0.25
3. TERMINAL NUMBERS FOR REF ONLY.
4. TRAVEL: 0.25mm +0.2/-0.1
5. RATING: 50mA, 12VDC
6. OPERATING FORCE: 100±50gf
7. CONTACT RESISTANCE: 100M OHM MAX.
8. ▲ DENOTES CRITICAL PARAMETER
- ▲9. PACKAGING: TAPE AND REEL 1,200 PCS PER
- ▲10. 2002/95/EC (ROHS) COMPLIANT

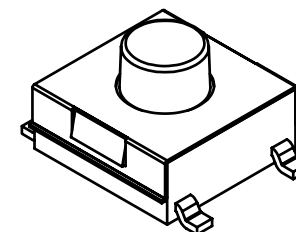
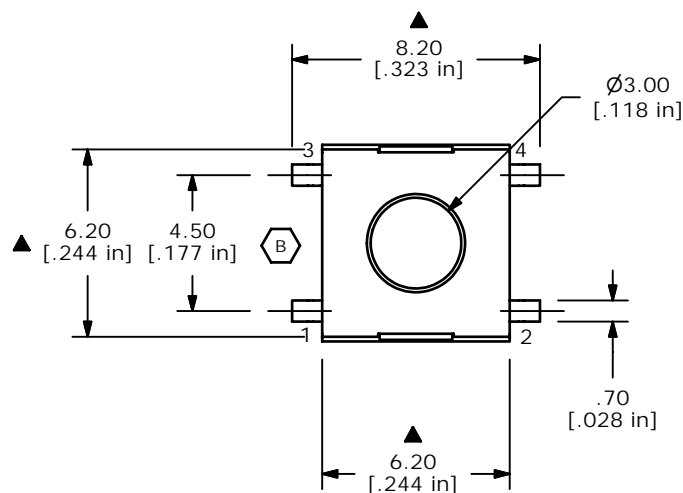

ISOMETRIC

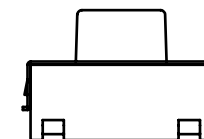
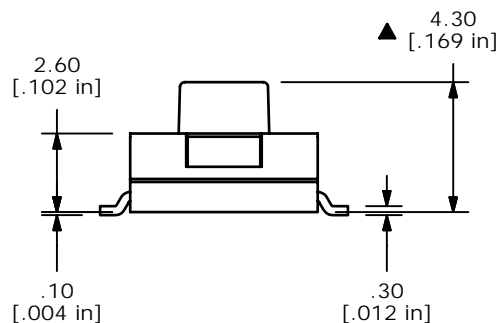

TERMINALS TO BE COLPLANAR
WITH IN 0.10mm

B	19516	CHANGE COVER TO TL3303	12/10/10	BGL
A	19438	RELEASED FOR PRODUCTION	11/15/10	BMA
REV	PCR NO	DESCRIPTION	DATE	BY

THE INFORMATION CONTAINED IN THIS DOCUMENT IS PROPRIETARY
TO E-SWITCH AND IS NOT TO BE COPIED OR TRANSFERRED



TITLE TL3303AF100QG

SCALE 4:1

DATE 11/15/2010

DR BA

DWG P020335

REV B