

LA120X Semiconductor Fuses

1200 VAC ■ Very Fast-Acting ■ 1/2 – 30 Amperes

NEW



Littelfuse's LA120X semiconductor protection fuses, rated 1/2 through 30A, 1200 VAC are popular for use in traction drive auxiliary circuits and similar applications. LA120X fuses are also suitable for use on 1000VDC auxiliary circuits with low time constants.

FEATURES

- **1000 Volt DC rating** for a wide range of circuits.
- **Compact size** fits in where competitive sizes will not fit.

APPLICATIONS

Protection of traction drive auxiliary circuits, etc.

DIMENSIONS

In Inches (mm in parentheses)

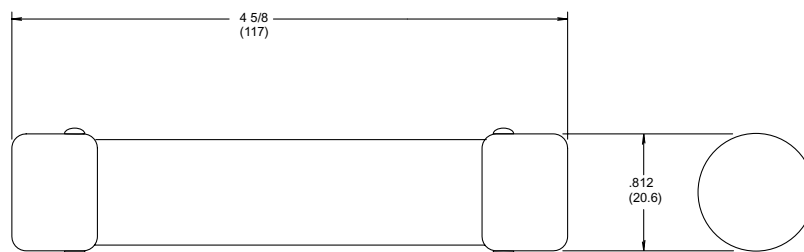

SPECIFICATIONS

Voltage Rating: AC: 1200 Volts

DC: 1000 Volts

Interrupting Rating: 100,000 Amperes

Ampere Range: 1/2 – 30 Amperes

ORDERING INFORMATION

| LA | 120 | X | 25 | -1 |
|------------|----------------|-------|---------------|-------------------------|
| Littelfuse | Voltage (1200) | Style | Ampere Rating | Mounting Type (Ferrule) |

Catalog Numbers & Technical Data

| Ampere Rating | Littelfuse Catalog Number | Mounting Type | Maximum Clearing I ² t @1200 VAC (A ² S) |
|---------------|---------------------------|---------------|--|
| 1/2 | LA120X1/2-1 | 1 | 1.9 |
| 1 | LA120X1-1 | 1 | 7.5 |
| 2 | LA120X2-1 | 1 | 30 |
| 3 | LA120X3-1 | 1 | 69 |
| 4 | LA120X4-1 | 1 | 120 |
| 5 | LA120X5-1 | 1 | 190 |
| 6 | LA120X6-1 | 1 | 280 |
| 10 | LA120X10-1 | 1 | 970 |
| 15 | LA120X15-1 | 1 | 2100 |
| 20 | LA120X20-1 | 1 | 3700 |
| 25 | LA120X25-1 | 1 | 5700 |
| 30 | LA120X30-1 | 1 | 8300 |

Special Purpose Fuses

Contact Littelfuse for characteristic curves.