

# DATA SHEET

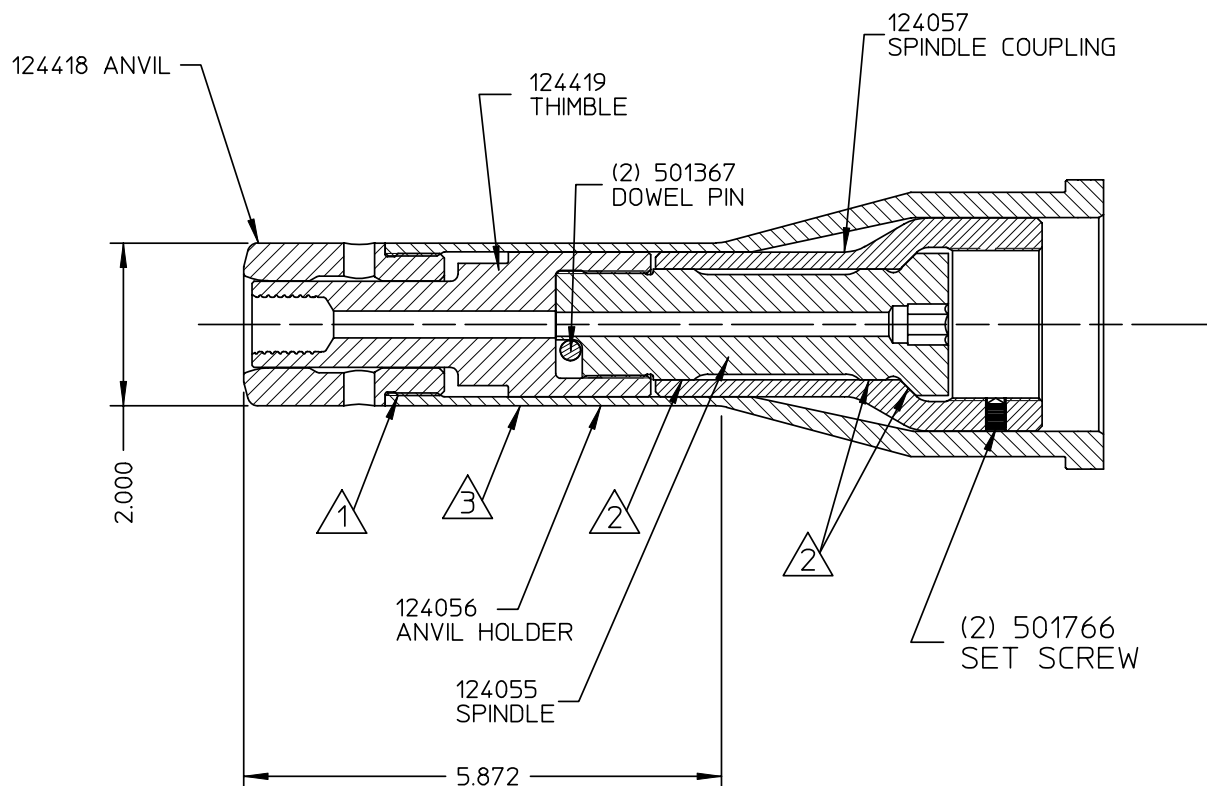
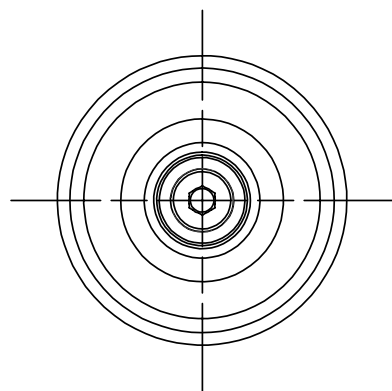

## NOTES:

- ① APPLY LOCTITE 242 P/N 505016 TO THIS THREADED JOINT.
- ② APPLY GREASE P/N 620030 TO SPINDLE BEFORE ASSEMBLY TO THIMBLE COUPLING.
- ③ APPLY WARNING STICKER P/N 590273 TO ANVIL HOLDER. DO NOT PERMIT STICKER TO OVERLAP ONTO ANVIL.

## TO ASSEMBLE SPINDLE/THIMBLE:

- A) INSERT SPINDLE 124055 INTO SPINDLE COUPLING 124057.
- B) THREAD THIMBLE 124419 ON SPINDLE 124055 UNTIL SPINDLE BOTTOMS.
- C) BACK OFF SPINDLE 124055 UNTIL FLAT IS ALIGNED WITH THE DOWEL PIN HOLES IN THE THIMBLE 124419.
- D) INSTALL DOWEL PIN 501367.

### Alcoa Fastening Systems

Commercial Products  
1 Corporate Drive, Kingston, NY 12401

TYPE:	N/A
FASTENER:	M18 HUCKSPIN
TOOL(S):	HS52

Notes: **OBSOLETE**  
**NO REPLACEMENT**

Product  
Revision: **D**

US Patent:

Date: 07/17/03

99-7417-1

Part Number