



K85R1/K85R2 Series Right Angle PCB Mount Open Body

Ordering Information

K85R1	-	E		D	-	9		S	-	N		
Series		Shell Size		Contact Construction		Number of Contacts		Contact Type		Mounting Options		Plating Options

Series

K85R1 - Kycon D-Subminiature Connector, Right Angle PCB Termination .283" (7.2 mm) Foot Print

K85R2 - Kycon D-Subminiature Connector, Right Angle PCB Termination .370" (9.4 mm) European Foot Print

Shell Size

E - 9 Contacts
A - 15 Contacts
B - 25 Contacts
C - 37 Contacts

Contact Construction

D - Precision Formed Right Angle

Number of Contacts

9, 15, 25, 37

Pin Contact Type

P - Pin Contact (Plug)
S - Socket Contact (Receptacle)

Plating Options and Performance Specifications
(see page 4)

D-SUBMINIATURE CONNECTORS

K85R1 / K85R2 Series

Mounting Options *

*Metric Jack Screws also available. (see page 38)

No Designator - No Mounting Brackets

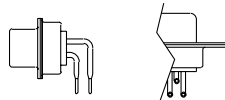

0 -

Mounting Brackets with .120" Dia. Non-Threaded Mounting Holes and Riveted Threaded Inserts

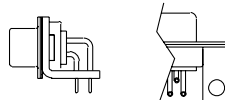

0J -

Mounting Brackets with .120" Dia. Non-Threaded Mounting Holes and Riveted Threaded Inserts with JS-1055 4-40 Hex Jackscrews Installed

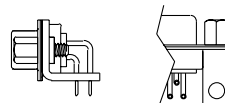

OR -

Mounting Brackets with .120" Dia. Non-Threaded Mounting Holes with 4-40 Round Jackscrews Riveted to Connector

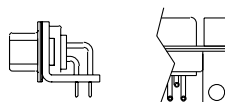

N -

Mounting Brackets with Grounding Boardlocks and Riveted Threaded Inserts

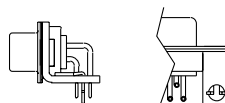

NJ -

Mounting Brackets with Grounding Boardlocks and Riveted Threaded Inserts with JS-1055 4-40 Hex Jackscrews Installed

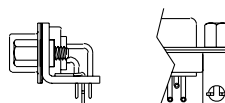

NR -

Mounting Brackets with Grounding Boardlocks and Riveted Threaded Inserts with 4-40 Round Jackscrews Riveted to Connector

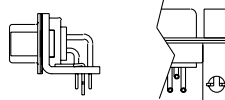

K -

(No Mounting Brackets) Riveted Threaded 4-40 Bushings

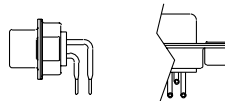

KJ -

(No Mounting Brackets) Riveted Threaded 4-40 Bushings with JS-1055 4-40 Hex Jackscrews Installed

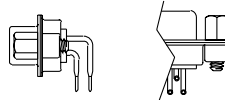

K85R1/K85R2 Dimensions

Standard with No Mounting Brackets

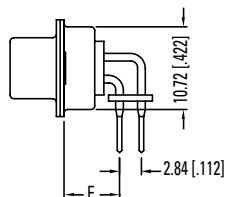
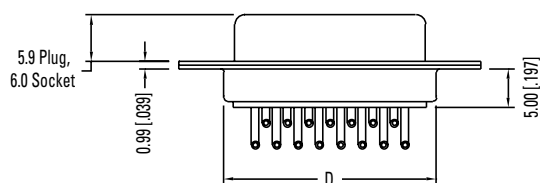
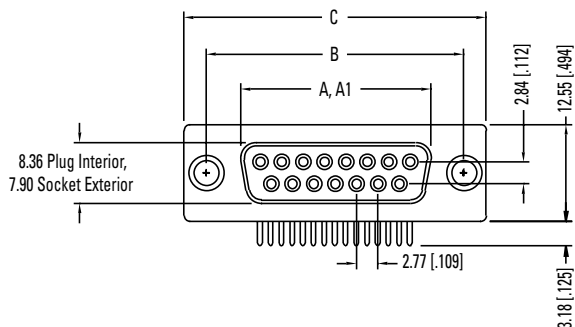

Dimensions in mm [In]

Number of Contacts (Shell Size)	Dimensions (Inch/mm) K85R1/K85R2				
	A	A1	B	C	D
9 (E)	.643 16.33	.666 16.92	.984 24.99	1.213 30.81	.795 20.19
15 (A)	.971 24.66	.994 25.25	1.312 33.32	1.541 39.14	1.083 27.51
25 (B)	1.511 38.38	1.534 38.96	1.852 47.04	2.088 53.04	1.652 41.96
37 (C)	2.159 54.84	2.182 55.42	2.500 63.50	2.729 69.32	2.272 57.71

Series	E Dimension	F Dimension
K85R1	7.2mm (.283)	8.62mm (.339)
K85R2	9.4mm (.370)	10.82mm (.425)

A = Exterior of Female Shell (S)

A1 = Interior of Male Shell (P)

D-SUBMINIATURE CONNECTORS

K85R1 / K85R2 Series

K85R1/K85R2 Dimensions

With Mounting Brackets, and Grounding Board Locks

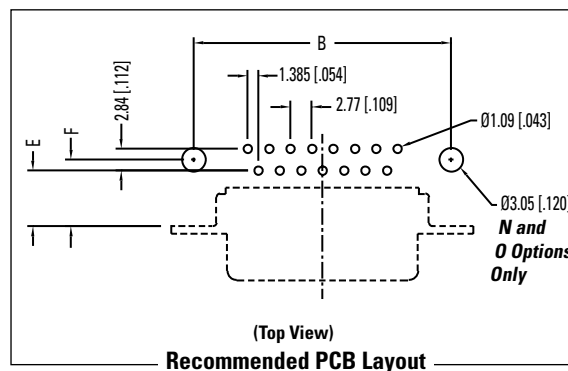
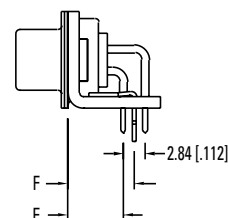
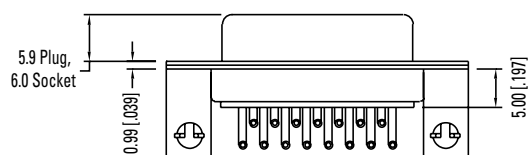
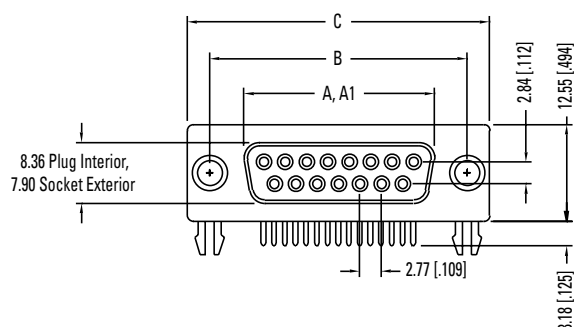

KYCON continues its leadership in D-Subminiature connectors by offering a complete line of sizes and options.

PC99 Colors Available:

- HD15: Blue
- DB15: Gold
- DB25: Burgundy
- DB09: Teal



KYCON Tech Support: **1-888-KYCON-22**
or E-mail: sales@kycon.com

D-SUBMINIATURE CONNECTORS

Performance Specifications

Materials and Finish

Shell

Steel Material, Tin Finish, and Indentations (Dimples) on Plug Only

Insert

Standard: PBT Thermoplastic, Black Color, 30% Glass Filled, 94V-0 Rated
Reflow Compatible: High Temperature Thermoplastic, Black Color,
30% Glass Filled, 94V-0 Rated

Contact Material

Pin: Brass .040 (1.02) Diameter Standard; .030 (0.76) Diameter High Density
Socket: Phosphor Bronze (Precision Formed Contact)
Brass (Precision Machined Contact)

Contact Finish-Standard

Gold Flash Over 0.0001 (0.00254) Nickel on Mating End of Contacts
Tin/Lead Over Nickel or Gold Flash Over Nickel on Solder Tails

Riveted Insert

Brass Material, Nickel Finish

Mechanical Characteristics

Contact Retention

Precision Machined Contact 10 Lbs, Precision Formed Contact 10 Lbs

Contact Extraction Force

Typ. 4 Oz.

Contact Insertion Force

Typ. 9 Oz.

Durability

1,000 Insertion Cycles Min (With Standard Plating)

Operating Temperature Rating

-55°C to +125°C

Electrical Characteristics

Contact Current Rating

Precision Machined Contact 7.6 Amps
Precision Formed Contact 5.0 Amps (Except K99 Series)

Contact Resistance

Precision Machined Contact 5 Milliohms Max
Precision Formed Contact 8 Milliohms Max

Dielectric Withstanding Voltage

1000 V AC Min for 1 Minute

Insulation Resistance

5000 Megohms Min

Processing Characteristics

Soldering Temperature Rating

High Temperature Plastic: 230°C for 30 Seconds, 260°C for 10 Seconds

Plating Options

Designator	Plating Description
Standard	Gold Flash over Nickel on Contacts. Gold Flash over Nickel or Tin/Lead over Nickel on Solder Tails.
15	15µ" Gold over Nickel on Mating End of Contacts. Tin/Lead over Nickel on Solder Tails.
30	30µ" Gold over Nickel on Mating End of Contacts. Tin/Lead over Nickel on Solder Tails.