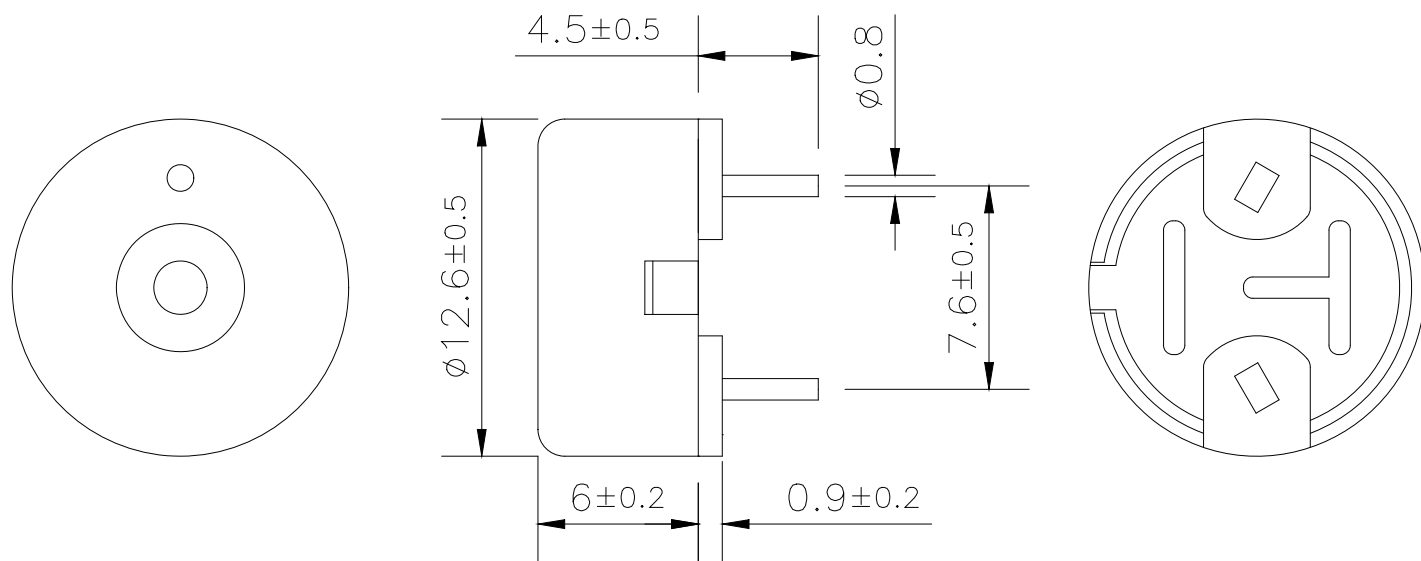

**Sales Outline Drawing****Specifications:**

Resonant Frequency (Hz)	4000 $\pm$ 500
Operating Voltage (Vp-p/max)	25
Rated Voltage (Vp-p)	5.0
Current Consumption (mA/max)	1.5 at Rated Voltage
Sound Pressure Level (dB/min)	80 at 10cm at Rated voltage
Capacitance (pF)	13,000 $\pm$ 30% at 120Hz
Operating Temperature (°C)	-20 ~ +100
Storage Temperature (°C)	-30 ~ +110
Housing	PBT1200 UL94HB plastic resin (Color: Black)
Lead Pins	Tin Plated Brass
Weight (Grams)	0.67
Condition by wave soldering (°C)	245 $\pm$ 5 / 3 $\pm$ 0.5 sec
Condition by hand soldering (°C)	350 $\pm$ 20 / within 5 sec
Options	For other options contact factory

**Dimensions:** (units: mm)**ROHS Compliant**

## **Direct Drive Transducer Operation:**

Direct drive transducer devices do not have any included DC circuitry, so the user must apply a sine or square wave with the appropriate rated frequency. A square wave will typically result in more sound level than a sine wave. The higher the peak-to-peak voltage applied (up to the maximum rated voltage), the higher the resulting sound level.

## **Frequency Response:**

