

PRODUCT NUMBER
95253-YXXXLF

WHEN REQUIRED, ADD SUFFIX LETTER "LF" INDICATES
THE PRODUCT IS RoHS COMPATIBLE, NOTE 6.
PACKAGING OPTIONS, NOTE 3.

PLATING

- 1 = 0.76µm GOLD/GXT (FULL PLATED)
ON 1.27µm NICKEL MIN
- 3 = 2µm MIN MATTE TIN (FULL PLATED)
ON 1.27µm NICKEL MIN
- 8 = 0.38µm GOLD/GXT (FULL PLATED)
ON 1.27µm NICKEL MIN

STYLE	SIZE	DIM "A"	OMIT PIN
01	2x07	5.9	A3
02	2x07	8.0	A3
03	2x04	5.9	B4
04	2x07	5.9	B4
05	2x08	5.9	B7

NOTES:

- HOUSING MAT'L : HIGH TEMPERATURE
THERMOPLASTIC. UL94V-0 COLOR: BLACK
- PIN MATERIAL : PHOSPHOR BRONZE
- PACKAGING OPTIONS:
 - = POLY BAGS
 - B = TUBE + CAP
 - A = TAPE & REEL WITH CAP, SEE TA840
FOR PRODUCT AVAILABILITY.

- 9N MIN RETENTION IN EITHER DIRECTION
- TO DETERMINE DIMENSIONS :
N = NUMBER OF POSITIONS PER ROW
EXAMPLE : 8 POS N x 2.54 = 20.32mm

6. RoHS COMPATIBLE PRODUCT SPECIFICATIONS

a - PLATING:

- "LF" MEANS THE PRODUCT IS LEAD-FREE,
2µm MINIMUM MATTE TIN OVER 1.27µm
MINIMUM NICKEL UNDERPLATE.

b - MANUFACTURING PROCESS COMPATIBILITY

- THE HOUSING WILL WITHSTAND EXPOSURE TO
260°C PEAK TEMPERATURE FOR 30 SECONDES
IN A CONVECTION, INFRA-RED OR VAPOR
PHASE REFLOW OVEN.

c - LABELING:

- MEETS PACKAGING SPECS AS PER GS-14-920

d - LEGAL STATEMENT: SEE GS-22-008

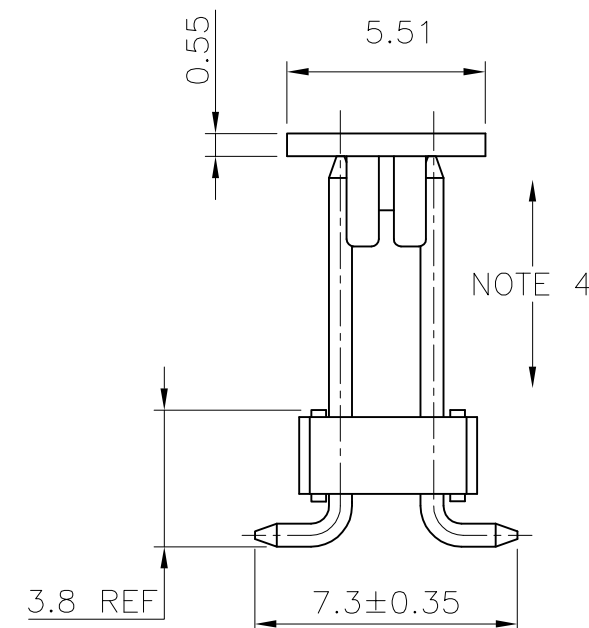
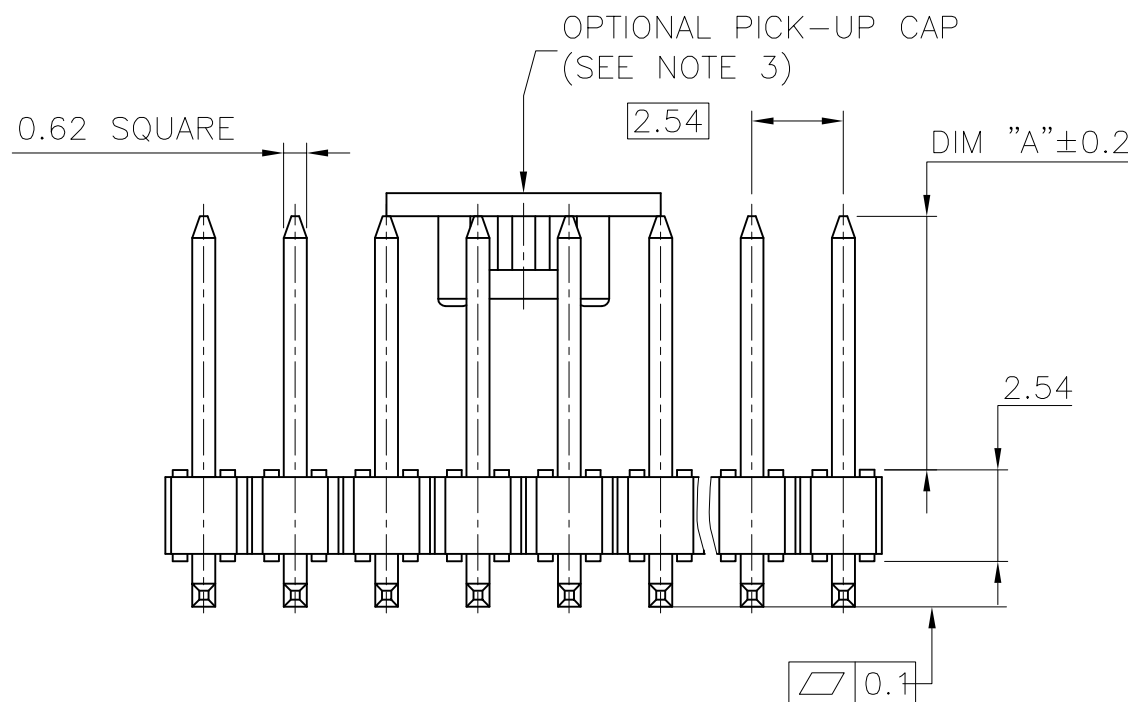
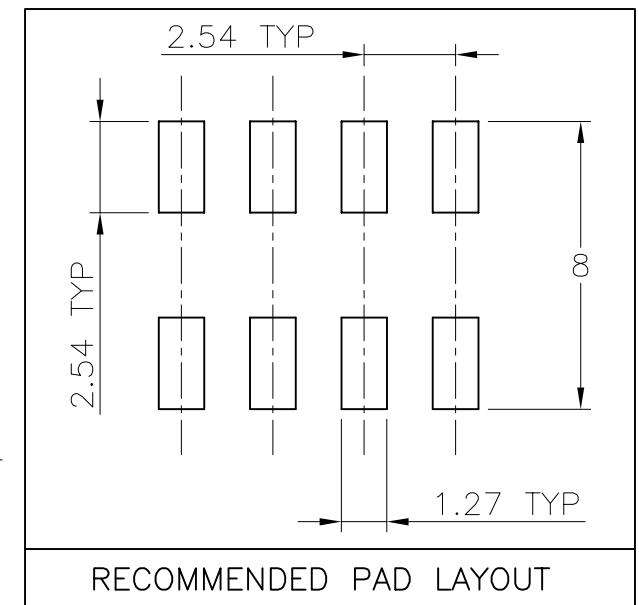
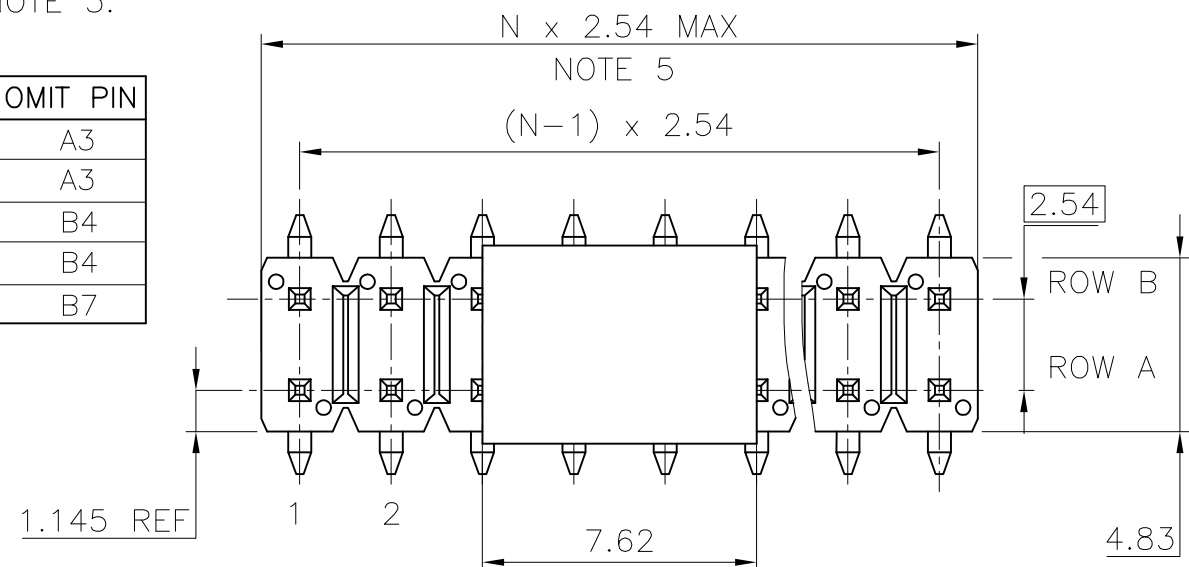

mat'l. code				surface		tolerance		projection		product family											
				ISO 1302		ISO 406 ISO 1101				HEADER											
ltr	ecn no	dr	date	tolerances unless			otherwise specified					title									
H	F90366	LMU	99.06.08	angles	linear	x.x ±0.3															
J	F03-0201	LMU	03.04.23			x.xx ±0.13															
K	F04-0362	LMU	04.11.30			x.xxx ±0.05															
								scale 5:1		dwg no											
L	F06-0168	LMU	06.04.21	dr	P.NIZZI		96.04.15														
M	F06-0208	JCO	06.06.22	enr	J. COMPAGNON		96.04.15				sheet 1 of 1										
N	F08-0148	JCO	08.05.27	chr																	
				appd	JMC		96.04.15				size										
sheet index		revision sheet																			