

PRODUCT DATA DRAWING

REVISION HISTORY			
REV	DESCRIPTION	DATE	APPROVED
-	REL. NRN 39945	10/29/15	STW

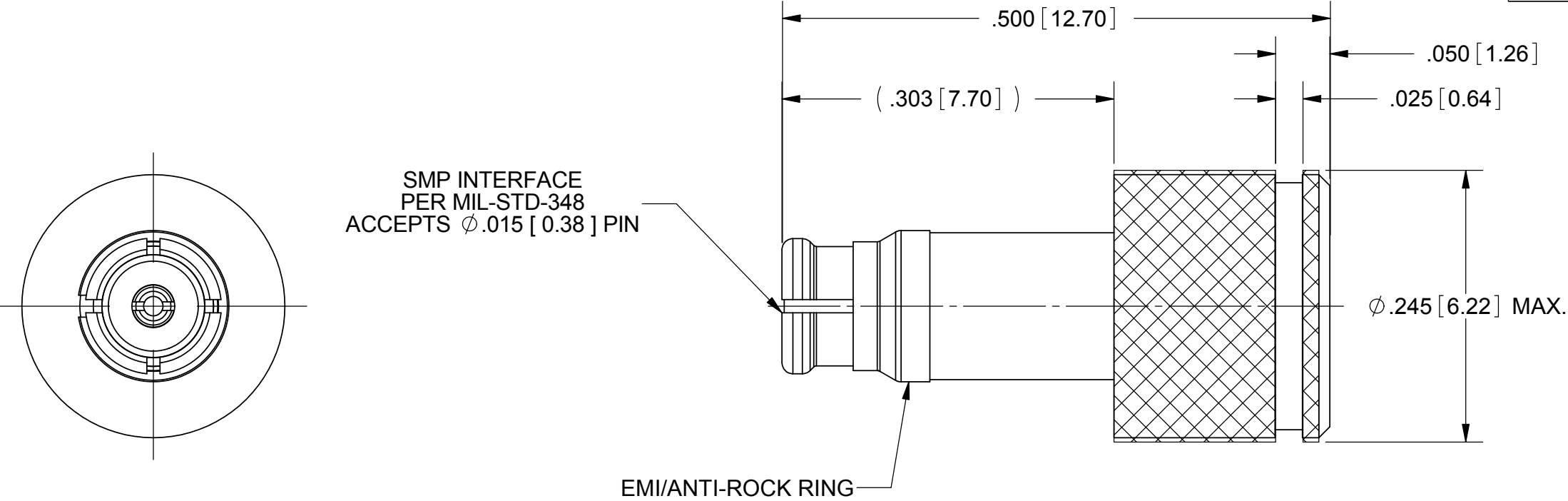

MATERIALS:
BODY, CONTACT,
EMI/ANTI-ROCK RING
& CAP:

INSULATOR:
RESISTOR ELEMENT:

BERYLLIUM COPPER ALLOY PER ASTM B196
ALLOY No. UNS17300 TD04

PTFE PER ASTM D1710
ALUMINA SUBSTRATE WITH NICHROME RESISTOR

FINISHES:
BODY, CONTACT,
EMI/ANTI-ROCK RING
& CAP:

GOLD PER ASTM B488, TYPE II, GRADE C, CLASS 1.27,
OVER NICKEL PER AMS-QQ-N-290, CLASS 1

ELECTRICAL:
IMPEDANCE:
FREQ. RANGE:
VSWR:
AVG. POWER:

PEAK POWER:

50 OHMS
DC TO 26.5 GHZ
1.25:1, DC TO 26.5 GHz
2 WATTS (POWER INPUT DERATED LINEARLY
FROM 25°C TO .2 WATTS AT 125 °C)
50 WATTS, PULSE WIDTH OF 5 MICROSECONDS
AND A DUTY CYCLE OF 5 X10-4

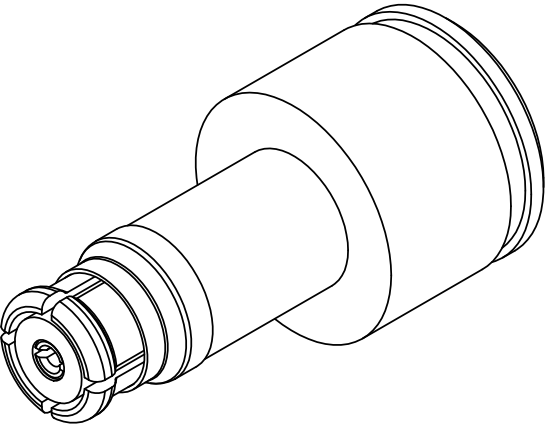

MATERIAL:	SEE NOTES	DIMENSIONS ARE IN INCHES TOLERANCES: FRACTIONAL: $\pm 1/64$ ANGULAR: X° $\pm 1^{\circ}0'$
-----------	-----------	--