

Technical datasheet: KPI-G2622P-K6271

Specifications:

Operating Temperature	-20°C to +80°C
Storage Temperature	-30°C to +100°C
Rated Voltage	12VDC
Operating Voltage	3VDC to 20VDC
Max. Rated Current	25mA at 12VDC
Resonant Frequency	2.9kHz \pm 0.5kHz
Min SPL	92dB / 12VDC / 30cm
Weight	13g
Case Material/Color	PBT/Black
Tone Nature	Continuous

Dimensions:

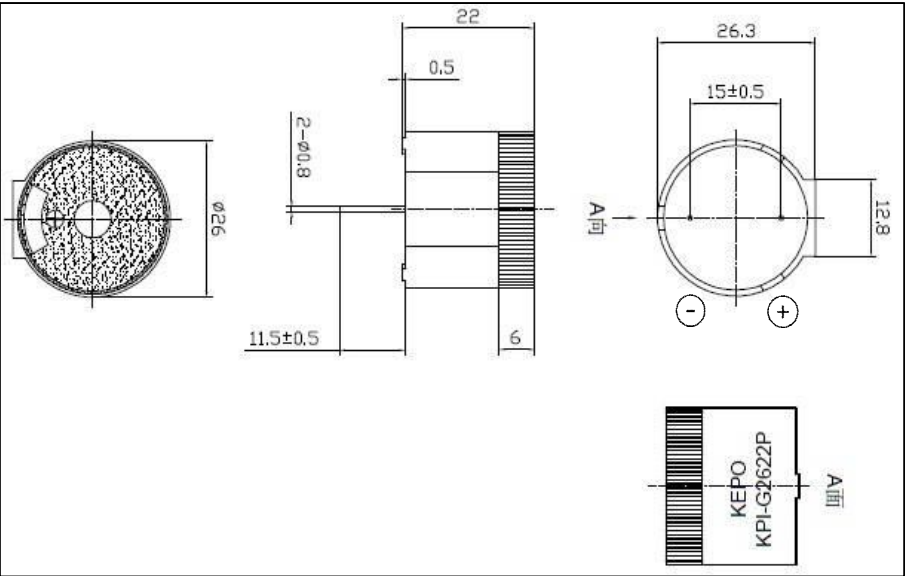

Frequency Response:

