



## Type 360381

Single terminal block, solderable, horizontal wire entry, open construction, double solder pins, screw brought down by hand (transport safety)

### Technical Data

0.5 - 2.5 mm<sup>2</sup> 16 A

Insulation co-ordination according to EN 60664-1

Protection category according to IEC 529

IP00

Tightening torque UL

4.4 lb-in max.

Solder pin dimension

2 x 1.0 mm

Recommended pc board hole dia.

Ø 1.5 mm

Solder pin length

2.25 mm

Dimensions in mm

1 mm = 0.0394 in.

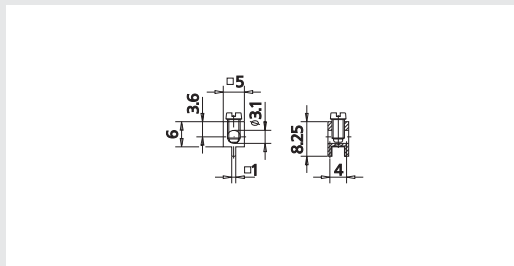

### Part numbers (P/N)

Type 360381

P/N 360381