

1. TERMINAL TO BE USED IN HOUSINGS 70066-**** AND 70450-****
2. REFER TO PRODUCT SPECIFICATION PS-71851
3. REFER TO MOLEX OPERATIONS AND SERVICE MANUAL FOR CRIMP DETAILS
4. TERMINAL TO BE USED WITH (0.64)/.025 SQUARE PINS
5. TERMINAL TO BE USED WITH 22-24 AWG STRANDED WIRE WITH (1.63)/.064 MAX. DIA. INSULATION
6. TERMINALS SUPPLIED LOOSE PER DRAWING PK-70873-0822

.000030 MINIMUM GOLD PLATE IN SELECT AREA
WITH .000075 MINIMUM TIN PLATE IN SELECT
AREA OVER NICKEL PLATE OVERALL

*THE PRIMARY SHIPPING CARTON WILL BE LABELED "COMPLIANT TO RoHS DIRECTIVE 2002/95/EC AND ELV ANNEX II OF DIRECTIVE 2000/53/EC". CARTONS WITHOUT THIS LABEL MAY CONTAIN PRODUCT WITH LEAD.

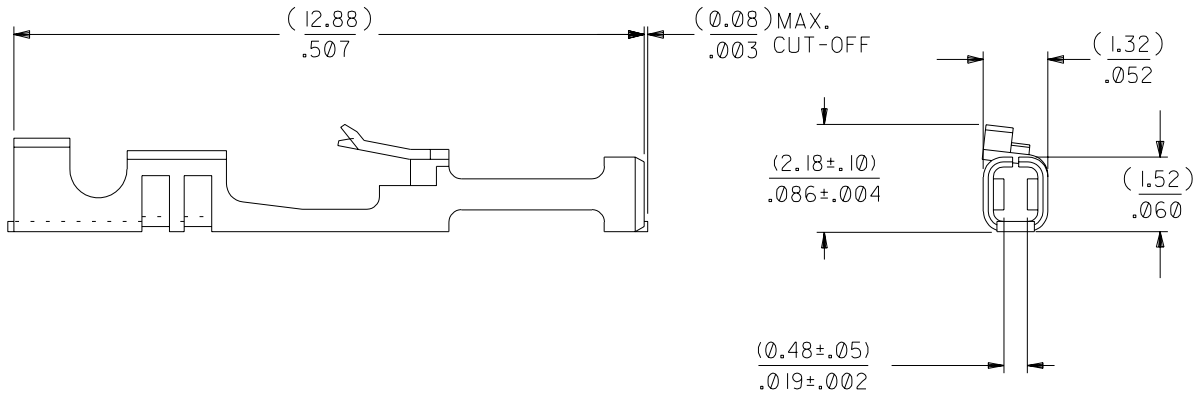
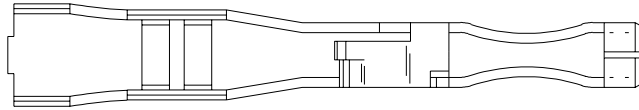

				C I		REVISED PER ECR #U70928 MCGRATH 97/06/26		DIMENSIONS SHOWN (METRIC) INCH UNLESS OTHERWISE SPECIFIED TOLERANCES: ANGULAR ± 1/2°		▽ = 0 ▽ = 0 REVISE ONLY ON CAD SYSTEM									
		D		LEAD FREE UCP2004-1769 RWHITE 04/04/06		C		REVISE PER ECR# U82219 11-07-88 MJM/MGB		TITLE TERMINAL-BOX/CRIMP HIGH FORCE CONTACT									
		C2		REVISED ECR #U80270 MCGRATH 97/07/31		B		REVISE PER ECR #U80064 3/25/88 MJM		TABLE INCH METRIC 3 PLACE ± .010 --- 2 PLACE ± .014 ± 0.25 1 PLACE --- ± 0.35 DRAFT WHERE APPLICABLE MUST REMAIN WITHIN DIMENSIONS		MOLEX INCORPORATED LITSE,ILL. 60532 U.S.A. SHEET NO. 1 DATE 03/25/88							
		LTR.		REVISIONS		LTR.		REVISIONS		PART NO. 016-02-1115 DRWG. NO. SD-71851-0226		FILE NAME S71851XB THIS DRAWING CONTAINS INFORMATION THAT IS PROPRIETARY TO MOLEX INC. AND SHOULD NOT BE USED WITHOUT WRITTEN PERMISSION.		DIV. DA SIZE B					
10		9		8		7		6		5		4		3		2		1	