

**Ordering number CA11401_BRITNEY-M**

Family	Britney	FWHM	28 degrees
Type	Assembly	Efficiency	92 %
LED	BXRA RS	cd/Im	-
Color	Metal	Gerber File	Available
Diameter	70 mm		
Height	38.4 mm		
Style	Round		
Optic Material	PC		
Holder Material	-		
Fastening	Tape		
Status	Ready		

Ordering number CA11402_BRITNEY-W

Family	Britney	FWHM	48 degrees
Type	Assembly	Efficiency	92 %
LED	BXRA RS	cd/Im	-
Color	Metal	Gerber File	Available
Diameter	70 mm		
Height	38.4 mm		
Style	Round		
Optic Material	PC		
Holder Material	-		
Fastening	Tape		
Status	Ready		

Ordering number CA12900_BRITNEY-XW

Family	Britney	FWHM	74 degrees
Type	Assembly	Efficiency	96 %
LED	BXRA RS	cd/Im	0.650
Color	White	Gerber File	Available
Diameter	70 mm		
Height	38.7 mm		
Style	Round		
Optic Material	PC		
Holder Material	-		
Fastening	Tape		
Status	Ready		

NOTE: The typical divergence will be changed by different color, chip size and chip position tolerance. The typical total divergence is the full angle measured where the luminous intensity is half of the peak value.



PRODUCT DATASHEET

Britney series

last update 4/10/2012



GENERAL INFORMATION

- Product series especially designed & optimized for BXRA RS series of LEDs.
- Special care taken to make light distribution as uniform as possible.
- Reflector is made of aluminium coated PC (120 degrees of Celcius / 248 degrees of Fahrenheit) with protective lacquer (110 degrees of Celcius / 230 degrees of Fahrenheit).

- Fastening to heat sink with a PU foam adhesive tape of automotive grade. Please find fastening details by clicking link: http://www.ledil.com/datasheets/DataSheet_TAPE.pdf

NOTE 1: We advise customer to ensure the suitability and sufficiency of the bond in the end product. For example, mechanical stress, vibration and holes on the surface of the circuit board weaken the strength of the tape.

NOTE 2: Assembly to the surface must be made straight, so the tape bonds constant and balanced with fastening surface. Slanted assembly might cause unbalanced bond to the surface. All surfaces where tape is applied must be clean, dry and free from grease and dirt.

If cleaning of PCB surfaces is needed, please follow strictly the cleaning instructions of your LED manufacturer - this is important as cleaning shall under no circumstances damage LEDs or other electronics components on the PCB.

Further note that optical components shall not be cleaned with any chemicals - only micro fiber cloth may be used to remove fingerprints or other traces from handling.

Relative intensity of CA12900_BRITNEY-XW (BXRA-RS)

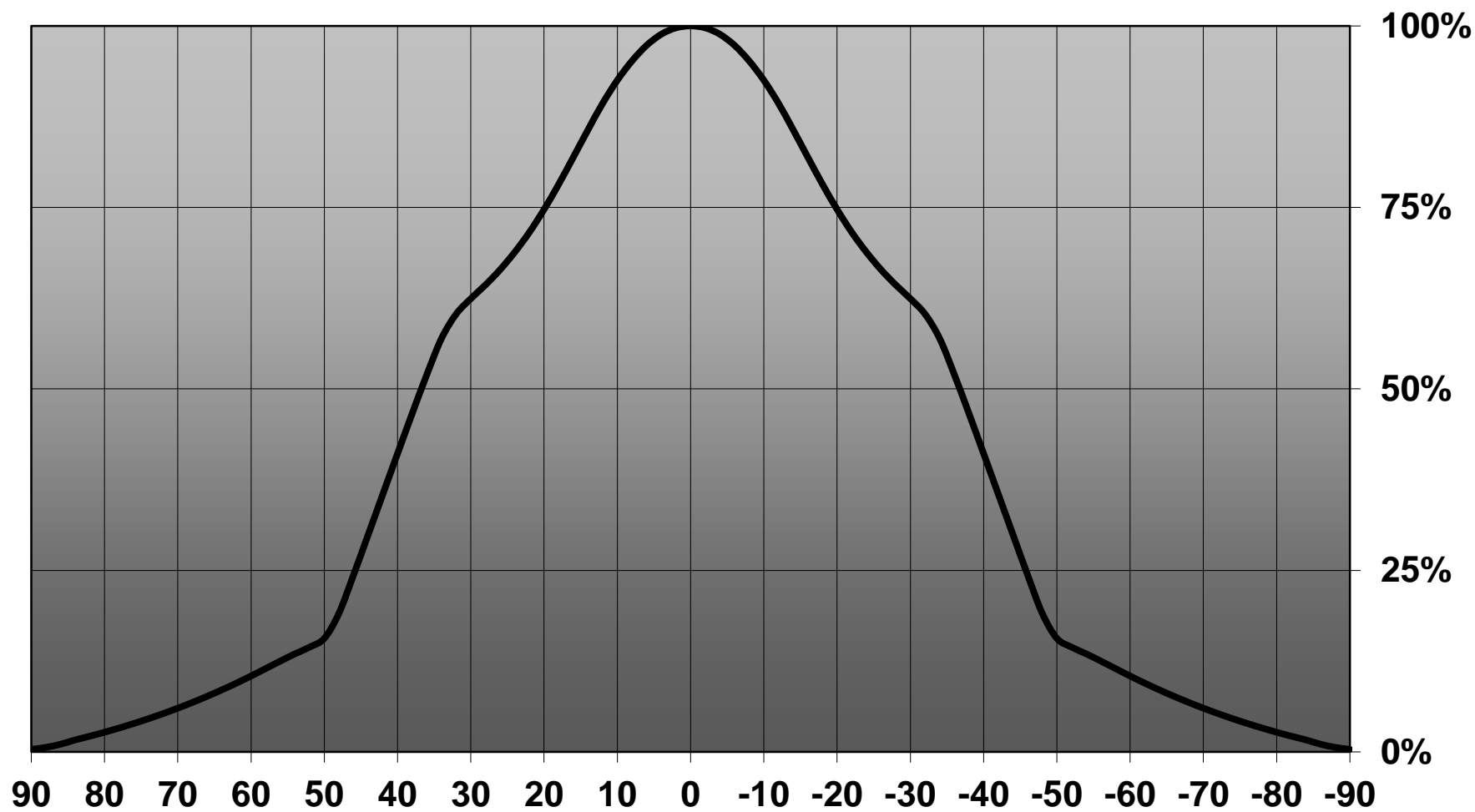

D

C

B

A

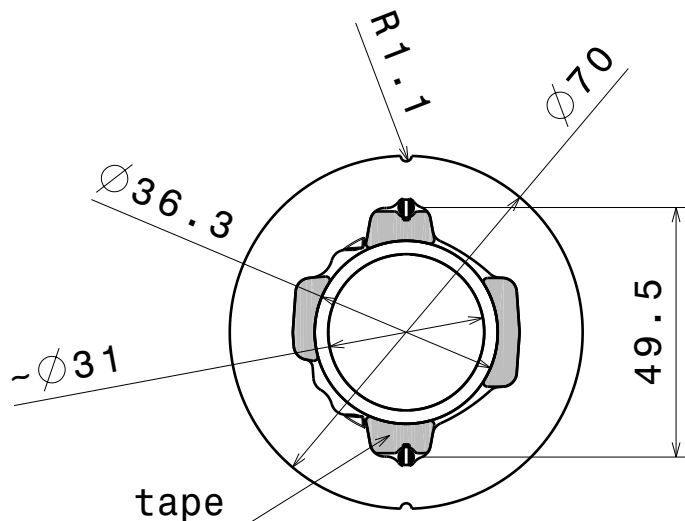
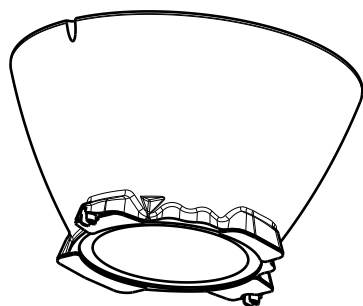

Bottom view

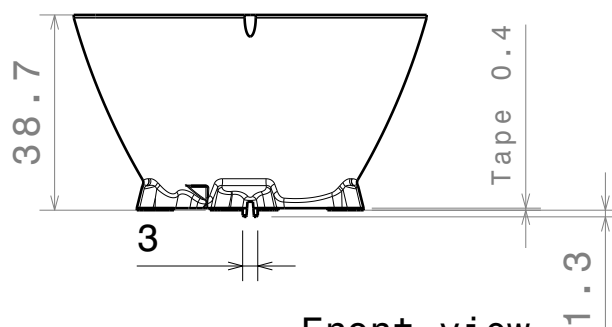

Front view

Reflector:
White reflective PC
OR
PC with Metal coating
and clear lacquer

Tape: PU Foam

Tolerances for dimensions:
0-20mm tolerance value $\pm 0.1\text{mm}$
21-45mm tolerance value $\pm 0.2\text{mm}$
46-90mm tolerance value $\pm 0.3\text{mm}$
91-100mm tolerance value $\pm 0.4\text{mm}$
101-mm tolerance value $\pm 0.5\text{mm}$

This drawing is our property.
It can't be reproduced
or communicated without
our written agreement.

L
S
F
Fe
a
i
nd
l
i

a

DRAWING TITLE

Datasheet Britney-series reflector Assy

DRAWN BY

p

DATE

02.08.2012

CHECKED BY

p

DATE

08.12.2011

DESIGNED BY

ol

DATE

17.03.2010

SIZE

A4

DRAWING NUMBER

REV

3

SCALE

2:3

WEIGHT (g)

SHEET

1/1

D

A