

Pushbutton

- **Alarm systems**
- **Computers**
- **Detector switch application**



HOUSING & BUSHING: 6/6 nylon (UL94V-2), black.

ACTUATOR: 6/6 nylon (UL 94V-2), natural. Internal o-ring seal, available on KM11 & KM33 models.

MOVABLE CONTACT: B contact material: Bronze or copper, with gold plate over nickel plate. See page A-69 for additional contact materials.

STATIONARY CONTACTS & TERMINALS: B contact material: Copper, with gold plate over nickel plate. See page A-69 for additional contact materials.

RETURN SPRING: Music wire, phosphor coated.

MOUNTING NUT: Brass, nickel plated.

TERMINAL SEAL: Epoxy.

NOTE: Specifications and materials listed above are for switches with standard options. For information on specific and custom switches, consult Customer Service Center.

To order, simply select desired option from each category and place in the appropriate box. Available options are shown and described on pages A-68 and A-70. For additional options not shown in catalog, consult Customer Service Center.

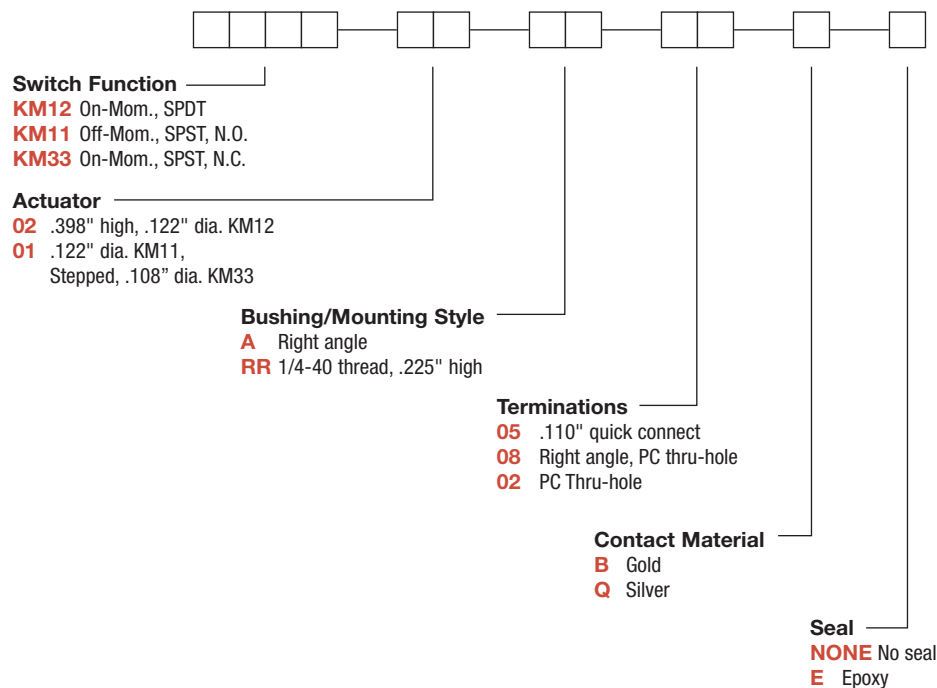

Dimensions are shown: Inches (mm)
Specifications and dimensions subject to change



A

Pushbutton

KM Series Subminiature Pushbutton Switches

SWITCH FUNCTION

| NO. POLES | MODEL NO. | SWITCH FUNCTION | | CONNECTED TERMINALS | | SCHEMATIC |
|--|-------------|-----------------|--------|---------------------|--------|-----------|
| | | POS. 1 | POS. 2 | POS. 1 | POS. 2 | |
| SP | KM11 | OFF | MOM. | OPEN | 2-1 | SPST N.O. |
| | KM33 | ON | MOM. | 2-1 | OPEN | SPST N.C. |
| SPST Part number shown: KM1101RR05BE | | | | | | |
| SP | KM12 | ON | MOM. | 2-1 | 4-3 | SPDT |
| SPDT Part number shown: KM1202A08BE | | | | | | |

ACTUATOR

02 .398" HIGH, .122" DIA.

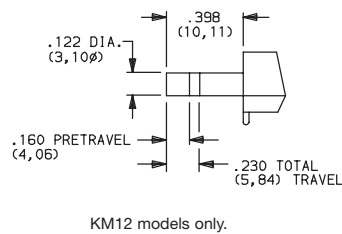

01 .122" DIA.

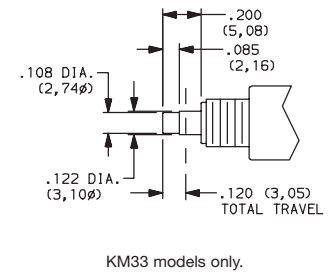
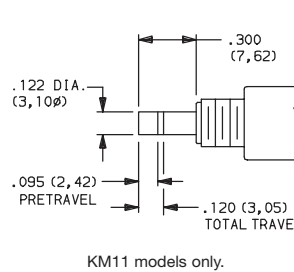

NOTE: Caps available for plunger options, see page A-70.

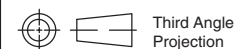

Dimensions are shown: Inches (mm)
Specifications and dimensions subject to change

C&K

KM Series Subminiature Pushbutton Switches



A

Pushbutton

BUSHING/ MOUNTING STYLE



A RIGHT ANGLE

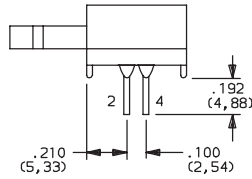

KM12 models only.

RR 1/4-40 THREAD, .225" HIGH

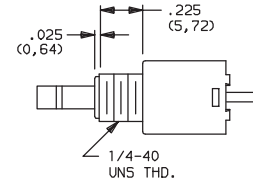

KM11 & KM33 models only.

PANEL MOUNTING



KM11 & KM33 models.

PC MOUNTING

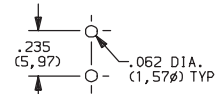

KM11 models only.

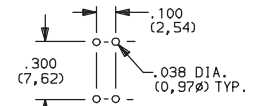

KM12 models only.

TERMINATIONS



05 .110" QUICK CONNECT

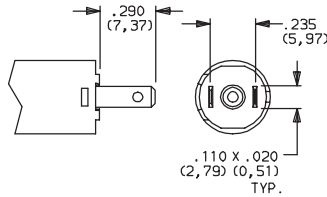

08 RIGHT ANGLE, PC THRU-HOLE

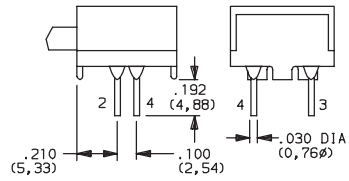

KM12 models only.

02 PC THRU-HOLE

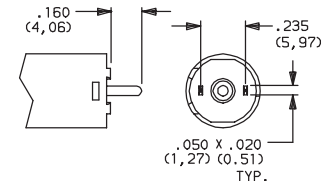

KM11 models only.

CONTACT MATERIAL



| OPTION CODE | RoHS COMPLIANT * | RoHS COMPATIBLE * | CONTACT AND TERMINAL MATERIAL | RATINGS | |
|-------------|------------------|-------------------|-------------------------------|-----------------------|---|
| B | YES | YES | GOLD ¹ | LOW LEVEL/DRY CIRCUIT | 0.4 VA MAX. @ 20 V AC OR DC MAX. |
| Q | YES | YES | SILVER ² | POWER | 0.25 AMPS @ 125 V AC OR DC (KM11, KM12) (UL) 1 AMP @ 125 V AC OR 28 V DC (KM33). |

* Note: See Technical Data section of this catalog for RoHS compliant and compatible definitions and specifications.

¹ STATIONARY CONTACTS & TERMINALS: Copper, with gold plate over nickel plate.
MOVABLE CONTACT: Phosphor bronze or beryllium copper, with gold plate over nickel plate.

² STATIONARY CONTACTS & TERMINALS: Copper, silver plated (standard with all termination options).
MOVABLE CONTACT: Phosphor bronze or beryllium copper, silver plated.

³ STATIONARY CONTACTS & TERMINALS: Copper, with gold plate over nickel plate over silver plate.
MOVABLE CONTACT: Phosphor bronze or beryllium copper, with gold plate over nickel plate over silver plate.

NOTE: Any models supplied with Q or B contact material are RoHS compliant.

KM11, KM12 models  when ordered with 'Q' contact material.

SEAL



NONE NO SEAL

E EPOXY SEAL

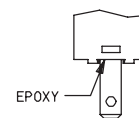

Dimensions are shown: Inches (mm)
Specifications and dimensions subject to change

C&K

**A****Pushbutton**

KM Series Subminiature Pushbutton Switches

AVAILABLE HARDWARE

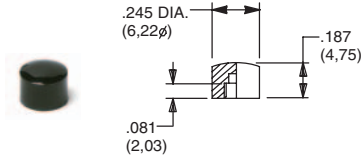
Cap, KM33 models**PART NO.**

785101000 WHITE
785102000 BLACK
785103000 RED

Material: Nylon
Finish: Gloss

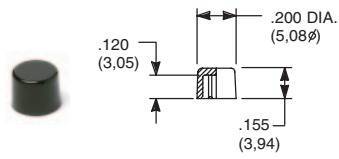
Cap, KM11 and KM12 models**PART NO.**

708901000 WHITE
708902000 BLACK
708903000 RED

Material: Nylon
Finish: Gloss

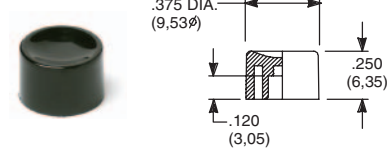
Cap, KM11 and KM12 models**PART NO.**

752701000 WHITE
752702000 BLACK
752703000 RED

Material: Nylon
Finish: Gloss

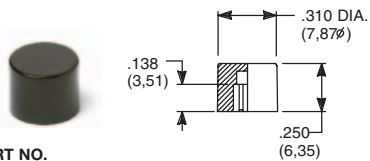
Cap, KM11 and KM12 models**PART NO.**

801801000 WHITE
801802000 BLACK
801803000 RED

Material: Nylon
Finish: Gloss

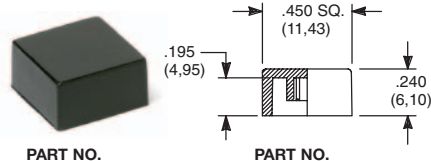
Cap, KM11 models**PART NO.**

484601000 WHITE
484602000 BLACK
484603000 RED

Material: Nylon
Finish: Gloss

PART NO.

798201000 WHITE
798202263 BLACK
798203000 RED

Material: Nylon
Finish: Matte

NOTE: Other cap colors available, consult Customer Service Center.

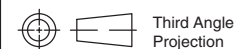

Dimensions are shown: Inches (mm)
Specifications and dimensions subject to change