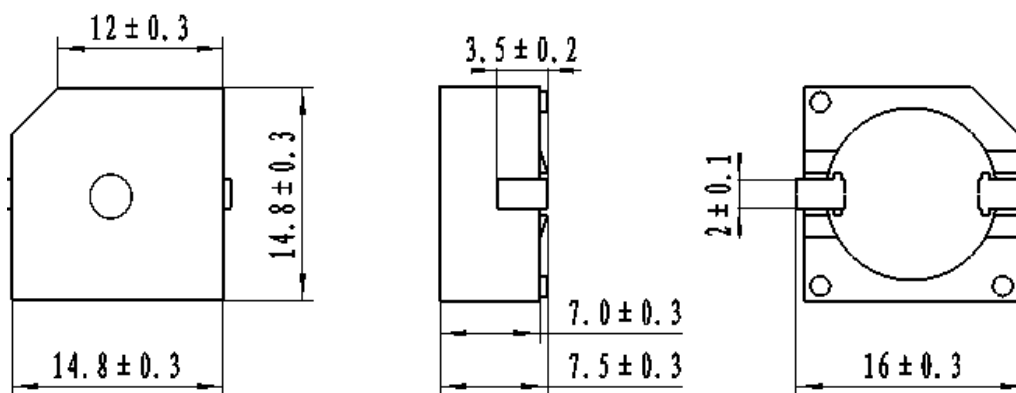
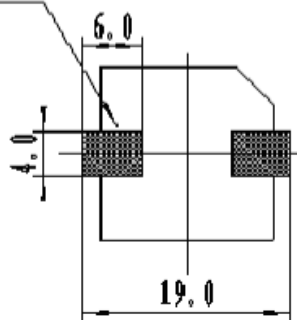

**Sales Outline Drawing**

Revision

**D****Specifications:**

|                                    |                                   |
|------------------------------------|-----------------------------------|
| Oscillation Frequency (Hz)         | $3650 \pm 500$                    |
| Operating Voltage (Vp-p)           | 1 ~ 30                            |
| Rated Voltage (Vp-p)               | 7.0                               |
| Current Consumption Max. (mA)      | 5 at Rated Voltage                |
| Sound Pressure Level (dB/min)      | 85 at 10cm at Rated Voltage       |
| Capacitance (pF)                   | $15,000 \pm 30\%$ at 120 Hz       |
| Operating Temperature (°C)         | -30 ~ +85                         |
| Storage Temperature (°C)           | -40 ~ +85                         |
| Type of Connection Terminal        | SMD                               |
| Housing                            | PPS plastic resin (Color : Black) |
| Weight (Grams)                     | 1.9                               |
| Condition by reflow soldering (°C) | $255 \pm 5$ / within 5 sec        |
| Condition by hand soldering (°C)   | $350 \pm 20$ / within 5 sec       |
| Options                            | For other options contact factory |

**Dimensions:** (units: mm)**RoHS Compliant****Suggested Pad PCB-Layout****Packaging:**

Parts are supplied on Cut-Tape.

Units do not come with wash label and are not appropriate for aqueous wash.

## **Direct Drive Transducer Operation:**

Direct drive transducer devices do not have any included DC circuitry, so the user must apply a sine or square wave with the appropriate rated frequency. A square wave will typically result in more sound level than a sine wave. The higher the peak-to-peak voltage applied (up to the maximum rated voltage), the higher the resulting sound level.

## **Frequency Response:**

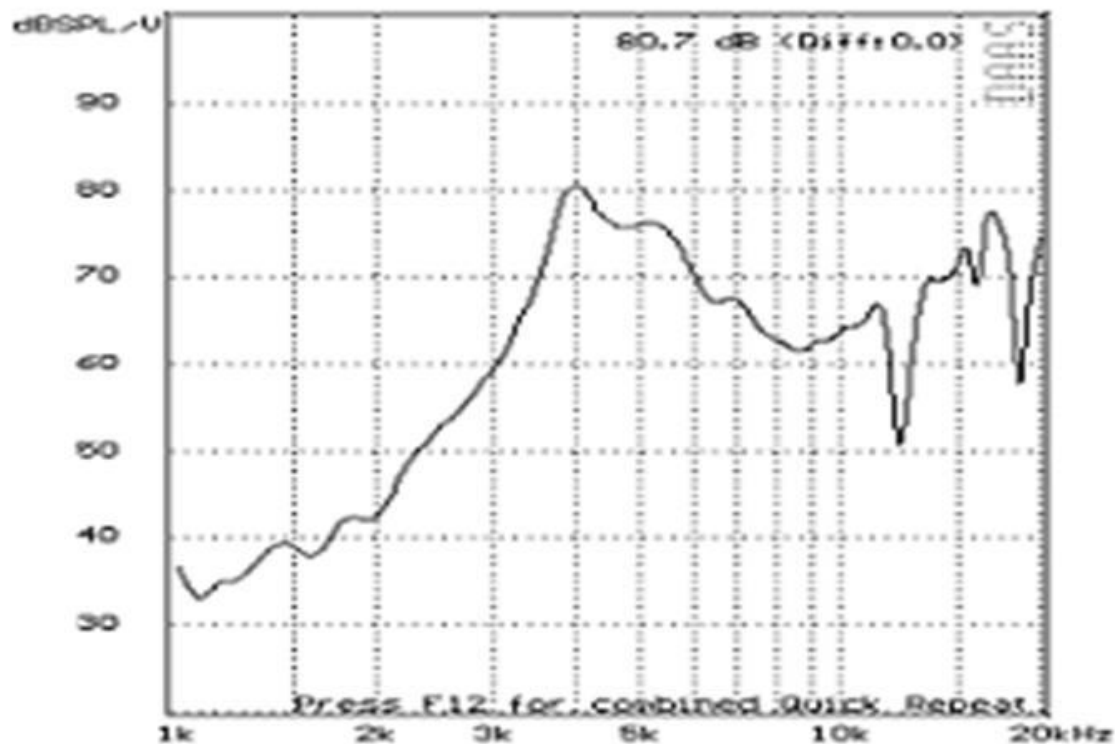

# Mouser Electronics

Authorized Distributor

Click to View Pricing, Inventory, Delivery & Lifecycle Information:

[Mallory Sonalert:](#)

[AST1575BMAQ](#)