

MICRO PINS



- Precision engineered and manufactured
- Space saving design for high density packaging
- Micro pins are available in .017 (.43) to .080 (2.03) diameters
- Ideal for mating with our standard line of micro jacks
- Available for press-fit, swage or solder mounting
- Custom micro pins manufactured to your specifications
- Other platings available upon request

SPECIFICATIONS

Material: Brass, ASTM-B16

Plating:

Gold: .000010 per MIL-G-45204

Tin: .000200 to .000300 per

MIL-F-10727, Type 1

RoHS (RoHS Compliant)

DASH NUMBERS (L Dimension)

- 1 for .032 (.81) thick Board
- 2 for .062 (1.57) thick Board
- 3 for .093 (2.36) thick Board
- 4 for .125 (3.2) thick Board

Example: 1967-1 for .032 (.81) thick Board
1967-2 for .062 (1.57) thick Board

.017 (.43) PIN - SWAGE MOUNT

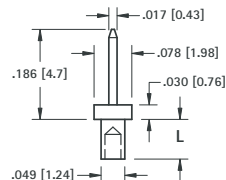

GOLD	TIN	L	Mtg. Hole
CAT. NO.	CAT. NO.	Length	Dia.
1967-1	1968-1	.051 (1.3)	.052 (1.32)
1967-2	1968-2	.082 (2.0)	

.017 (.43) PIN - SOLDER MOUNT

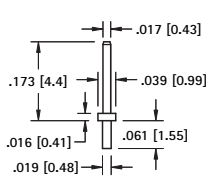

GOLD	TIN	Mtg. Hole
CAT. NO.	CAT. NO.	Dia.
1378-1	1379-1	.022 (.56)

.018 (.46) PIN - PRESS-FIT

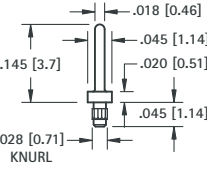

GOLD	TIN	Mtg. Hole
CAT. NO.	CAT. NO.	Dia.
1986-1	1987-1	.026 (.66)

.018 (.46) PIN - PRESS-FIT

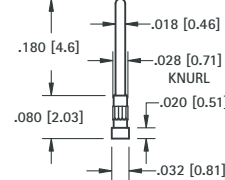

MATERIAL: Phosphor Bronze

GOLD	TIN	Mtg. Hole
CAT. NO.	CAT. NO.	Dia.
1990-2	1991-2	.026 (.66)

.018 (.46) PIN - PRESS-FIT

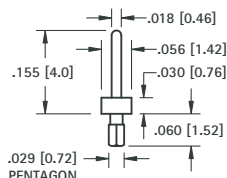

GOLD	TIN	Mtg. Hole
CAT. NO.	CAT. NO.	Dia.
1992-2	1994-2	.026 (.66)
1988-2	1989-2	

.018 (.46) PIN - PRESS-FIT

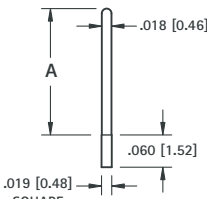

GOLD	TIN	A	Mtg. Hole
CAT. NO.	CAT. NO.	Dim.	Dia.
1992-2	1994-2	.243 (6.2)	.022 (.56)
1993-2	1995-2	.140 (3.6)	

.020 (.51) PIN - PRESS-FIT

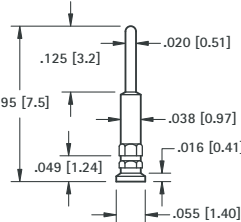

GOLD	TIN	Mtg. Hole
CAT. NO.	CAT. NO.	Dia.
1996-2	1997-2	.040 (1.01)

.020 (.51) PIN - SOLDER MOUNT

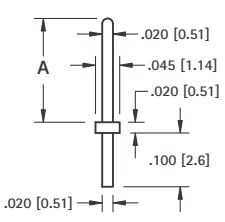

GOLD	TIN	A	Mtg. Hole
CAT. NO.	CAT. NO.	Dim.	Dia.
1998-3	2000-3	.250 (6.4)	.024 (.61)
1999-3	2001-3	.425 (10.8)	

.020 (.51) PIN - SWAGE MOUNT

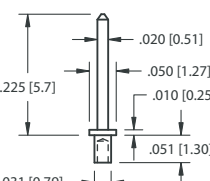

GOLD	TIN	Mtg. Hole
CAT. NO.	CAT. NO.	Dia.
1366-1	1367-1	.035 (.89)

.020 (.51) PIN - SWAGE MOUNT

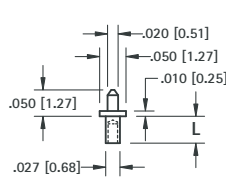

GOLD	TIN	L	Mtg. Hole
CAT. NO.	CAT. NO.	Length	Dia.
1372-1	1373-1	.051 (1.3)	.031 (.78)
1372-2	1373-2	.082 (2.1)	

.024 (.61) PIN - SWAGE MOUNT

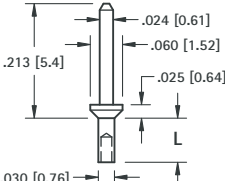

GOLD	TIN	L	Mtg. Hole
CAT. NO.	CAT. NO.	Length	Dia.
1406-1	1426-1	.047 (1.2)	.035 (.89)
1406-2	1426-2	.078 (1.9)	

.025 (.64) PIN - SWAGE MOUNT

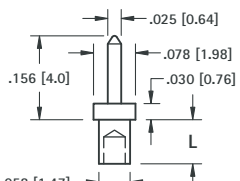

GOLD	TIN	L	Mtg. Hole
CAT. NO.	CAT. NO.	Length	Dia.
1408-1	1428-1	.062 (1.6)	.062 (1.57)
1408-2	1428-2	.094 (2.4)	

.025 (.64) PIN - SWAGE MOUNT

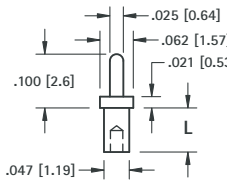

GOLD	TIN	L	Mtg. Hole
CAT. NO.	CAT. NO.	Length	Dia.
1404-1	1424-1	.051 (1.3)	.052 (1.32)
1404-2	1424-2	.082 (2.1)	

.025 (.64) PIN - SWAGE MOUNT

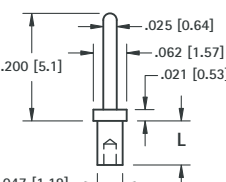

GOLD	TIN	L	Mtg. Hole
CAT. NO.	CAT. NO.	Length	Dia.
1407-1	1427-1	.051 (1.3)	.052 (1.32)
1407-2	1427-2	.082 (2.1)	

.025 (.64) PIN - SWAGE MOUNT

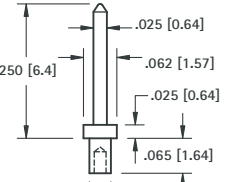

GOLD	TIN	Mtg. Hole
CAT. NO.	CAT. NO.	Dia.
1401-1	1421-1	.043 (1.09)

.025 (.64) PIN - SWAGE MOUNT

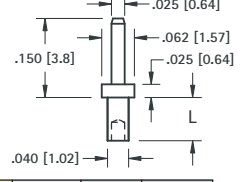

GOLD	TIN	L	Mtg. Hole
CAT. NO.	CAT. NO.	Length	Dia.
1368-1	1369-1	.051 (1.3)	.043 (1.09)
1368-2	1369-2	.082 (2.1)	
1368-3	1369-3	.113 (2.9)	

Mouser Electronics

Authorized Distributor

Click to View Pricing, Inventory, Delivery & Lifecycle Information:

[Keystone Electronics:](#)

[1428-1](#) [1408-1](#) [1967-1](#) [1989-2](#) [1993-2](#) [1997-2](#)