

THIS DRAWING IS UNPUBLISHED.

RELEASED FOR PUBLICATION

20

© COPYRIGHT 20

BY -

ALL RIGHTS RESERVED.

REVISIONS

P	LTR	DESCRIPTION	DATE	DWN	APVD
	C7	PART STATUS UPDATED	11JAN2018	RK	PS

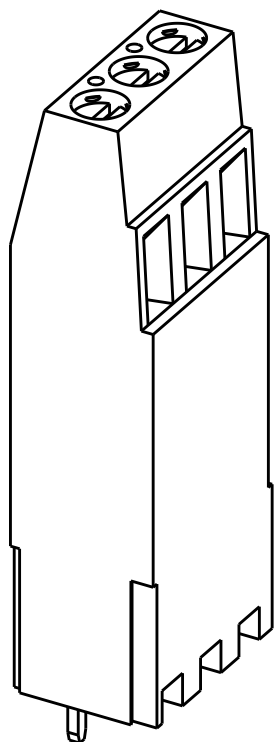
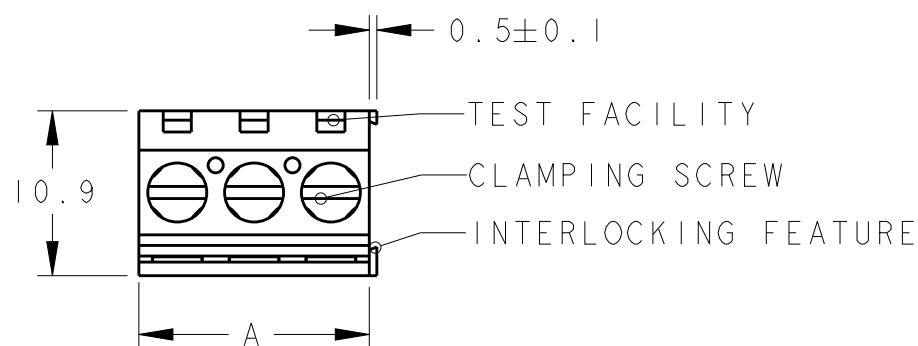

282925-3 AS SHOWN

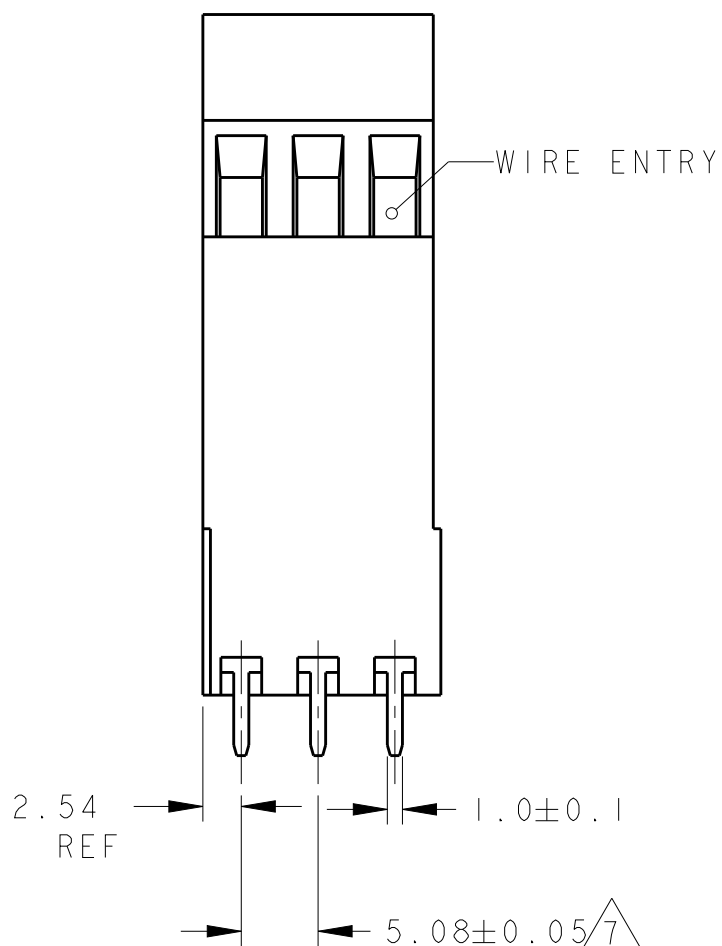
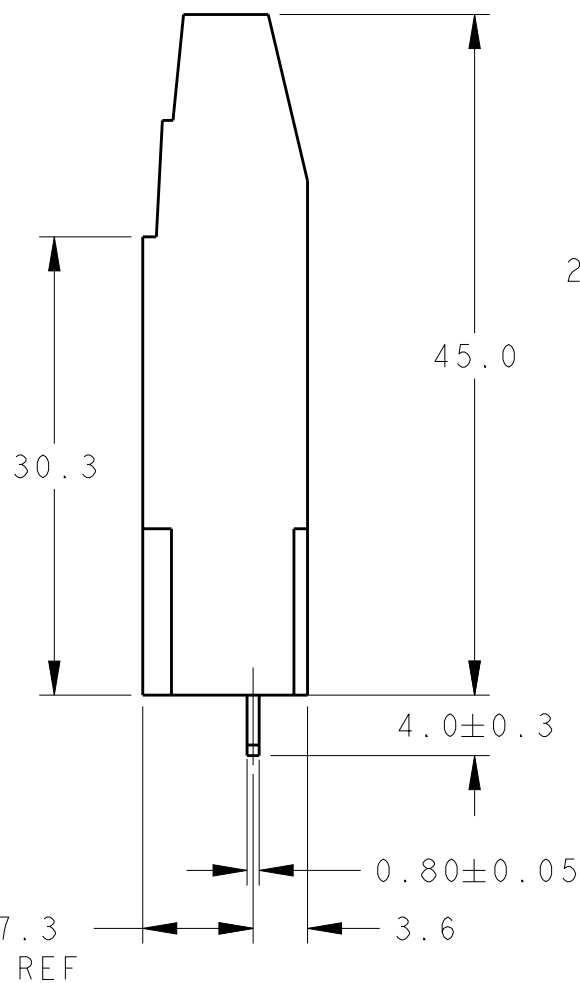

RECOMMENDED PC BOARD LAYOUT

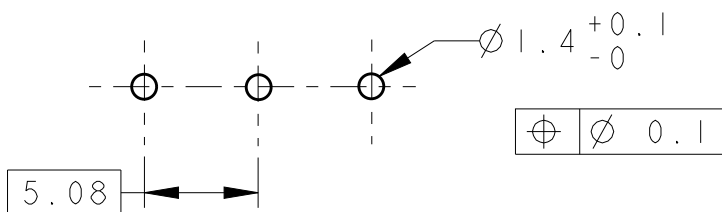

MATERIALS AND FINISH

HOUSING: PA 6-6, UL 94-V0, COLOR GREEN.

CLAMP: BRASS, NICKEL PLATED.

TERMINAL: BRASS, TIN PLATED.

CLAMPING SCREW: M3, BRASS, NICKEL PLATED.

2 SUITABLE FOR 1,6-2,4mm PC BOARD THICKNESS.

3 END-TO-END STACKABLE W/INTERLOCK WITHOUT LOSS OF CENTERLINE SPACING.

4 WIRE SIZE RANGE: 12 - 30 AWG

5 RECOGNIZED UNDER THE COMPONENT PROGRAM OF UNDERWRITERS LABORATORIES INC. FILE NO E60677.

6 IMQ CERTIFICATE WITH SURVEILLANCE IMQ IN CONFORMITY WITH IEC 998-1/998-2-1.



NOT CUMULATIVE TOLERANCE.



8 P/N 1-282925-0 IS A KIT PACKAGE COMPRISED OF THE FOLLOWING: (3) OF 25 POS. GLUED ASSEMBLIES AND (4) OF 22 POS. GLUED ASSEMBLIES. EACH GLUED ASSEMBLY IS PACKAGED SEPERATLY IN A UNIT BOX.



9 INK MARKING, BLACK COLOR.

NUMERICAL SEQUENCE: FROM LEFT TO RIGHT FOR EACH GLUED ASSEMBLY.



10 INK MARKING, BLACK COLOR. SEE DETAIL FOR MARKING.



11 PARTS TO BE SHIPPED WITH CAGES IN THE CLOSED POSITION WITH SCREW TORQUE TO 3 IN-lbs MIN.



12 PRELIMINARY PART NUMBER



13 SECTIONS GLUED USING CYANOLIT 241F OR TE ENGINEERING APPROVED EQUIVALENT.

12	10	SEE DETAIL F	60.96	12	2-282925-3
12	10	SEE DETAIL E	76.20	15	2-282925-2
13	11	SEE DETAIL D	106.68	21	2-282925-1
13	11	SEE DETAIL C	76.20	15	1-282925-5
13	10	SEE DETAIL B	60.96	12	1-282925-2
8	9		828.04	163	1-282925-0
OBSOLETE			15.24	3	282925-3
			10.16	2	282925-2

DIM.A NO OF POS. PART NUMBER

THIS DRAWING IS A CONTROLLED DOCUMENT.

DWN 09NOV2001

E. ZANOLINI

CHK 09NOV2001

D. BIEVENOUR

APVD 09NOV2001

D. BIEVENOUR

PRODUCT SPEC

108-20166

APPLICATION SPEC

114-20079

WEIGHT -

CUSTOMER DRAWING

TE

TE Connectivity

NAME
TERMINAL BLOCK, PCB MOUNT
3RD LEVEL
STACKING W/INTERLOCK, 5.08mm PITCH

SIZE CAGE CODE DRAWING NO RESTRICTED TO

A300779C-282925

SCALE 2:1

SHEET 1 OF 3

REV C7

THIS DRAWING IS UNPUBLISHED.

RELEASED FOR PUBLICATION

20



COPYRIGHT 20

BY -

ALL RIGHTS RESERVED.

REVISIONS

P	LTR	DESCRIPTION	DATE	DWN	APVD
	-	SEE SHEET 1	-	-	-

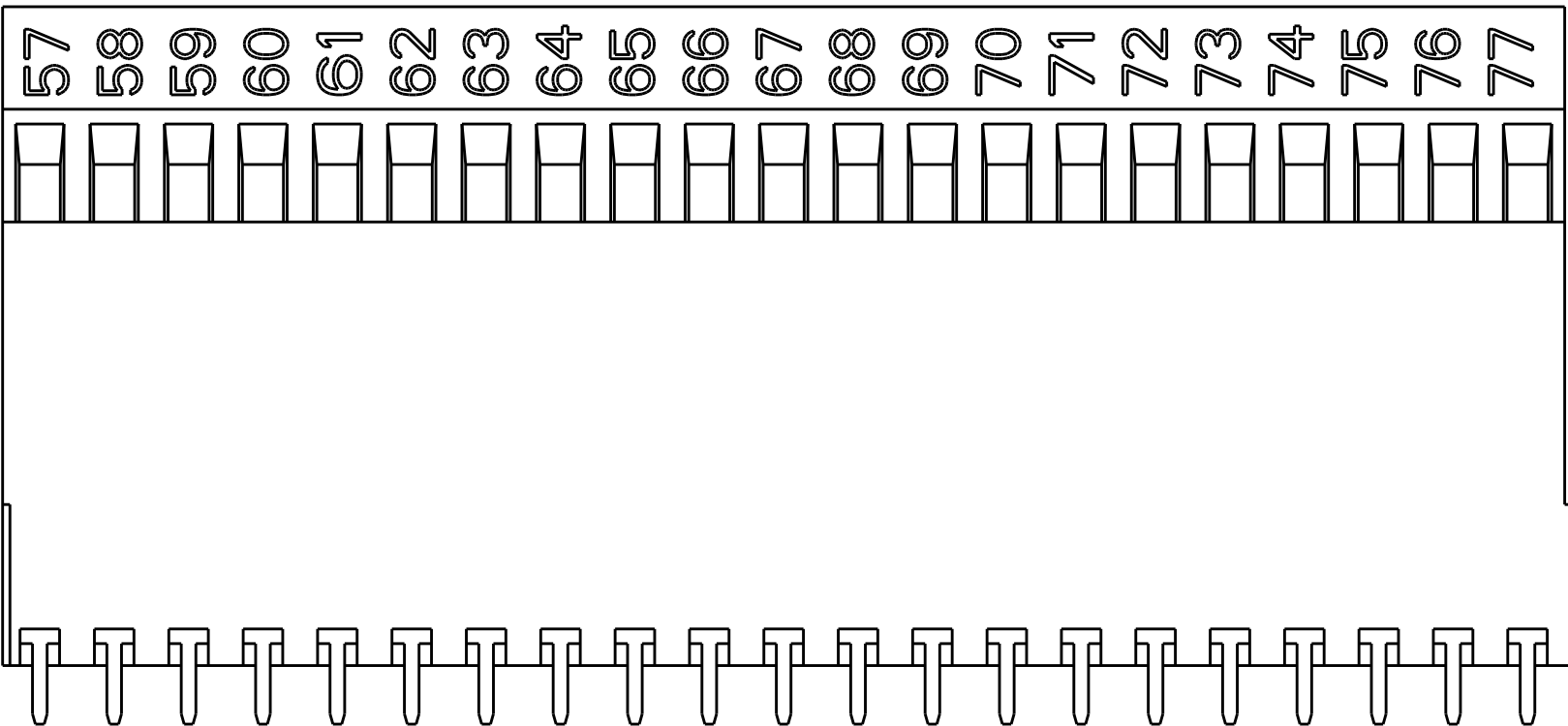

DETAIL D
SCALE 2:1

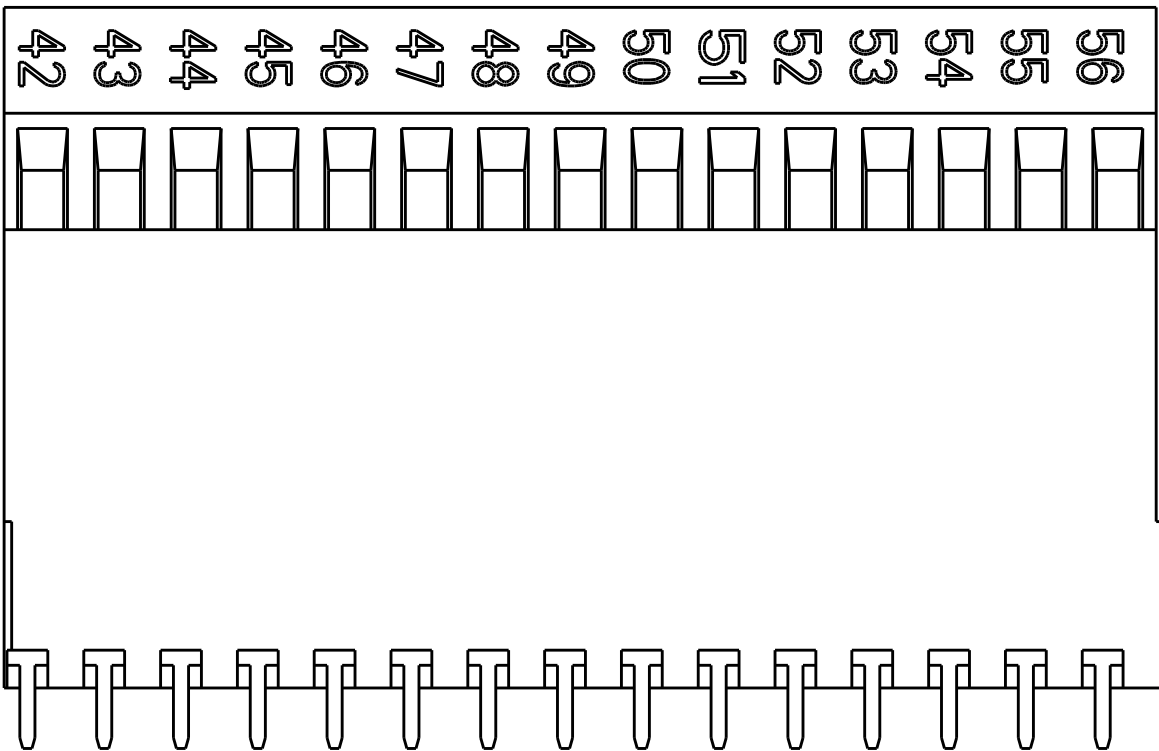

DETAIL C
SCALE 2:1

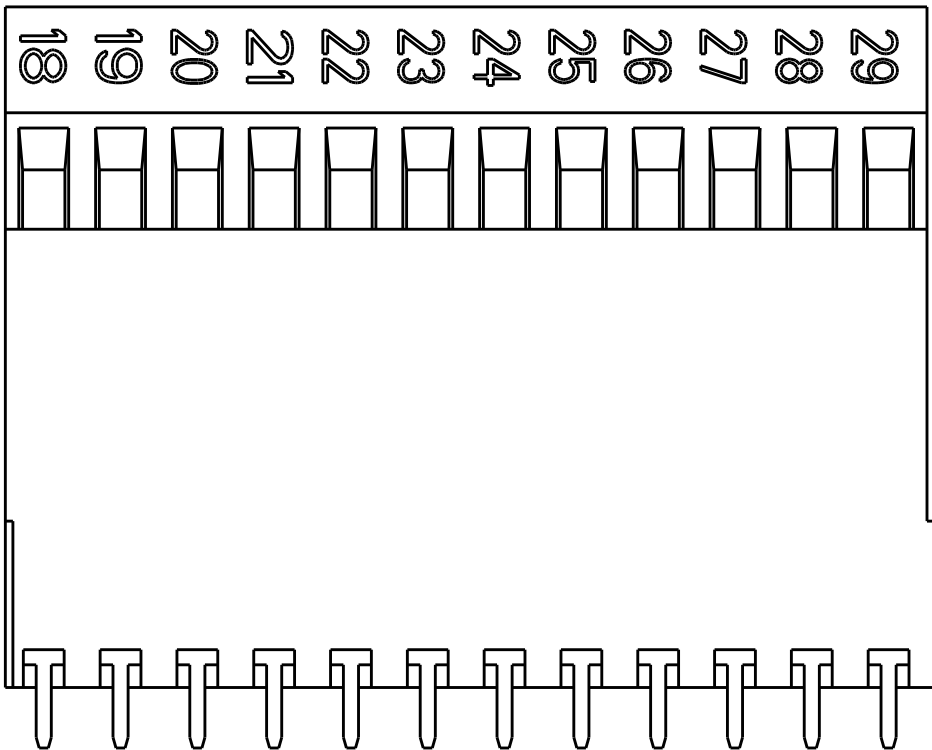

DETAIL B
SCALE 2:1

THIS DRAWING IS A CONTROLLED DOCUMENT.

DIMENSIONS:

mm

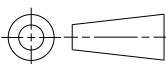

TOLERANCES UNLESS OTHERWISE SPECIFIED:

0 PLC ±.3
1 PLC ±.3
2 PLC ±.25
3 PLC ±.
4 PLC ±.
ANGLES ±2

MATERIAL



FINISH



DWN 09NOV2001

E. ZANOLINI

CHK 09NOV2001

D. BIEVENOUR

APVD 09NOV2001

D. BIEVENOUR

PRODUCT SPEC

108-20166

APPLICATION SPEC

114-20079

WEIGHT

-

CUSTOMER DRAWING



TE Connectivity

NAME
TERMINAL BLOCK, PCB MOUNT
3RD LEVEL
STACKING W/INTERLOCK, 5.08mm PITCH

SIZE

CAGE CODE

DRAWING NO

RESTRICTED TO

A300779C-282925

-

SCALE

2:1

SHEET

2 OF 3

REV

C7

4

3

2

1

THIS DRAWING IS UNPUBLISHED.

RELEASED FOR PUBLICATION

20



COPYRIGHT 20

BY -

ALL RIGHTS RESERVED.

REVISIONS

P	LTR	DESCRIPTION	DATE	DWN	APVD
	-	SEE SHEET 1	-	-	-

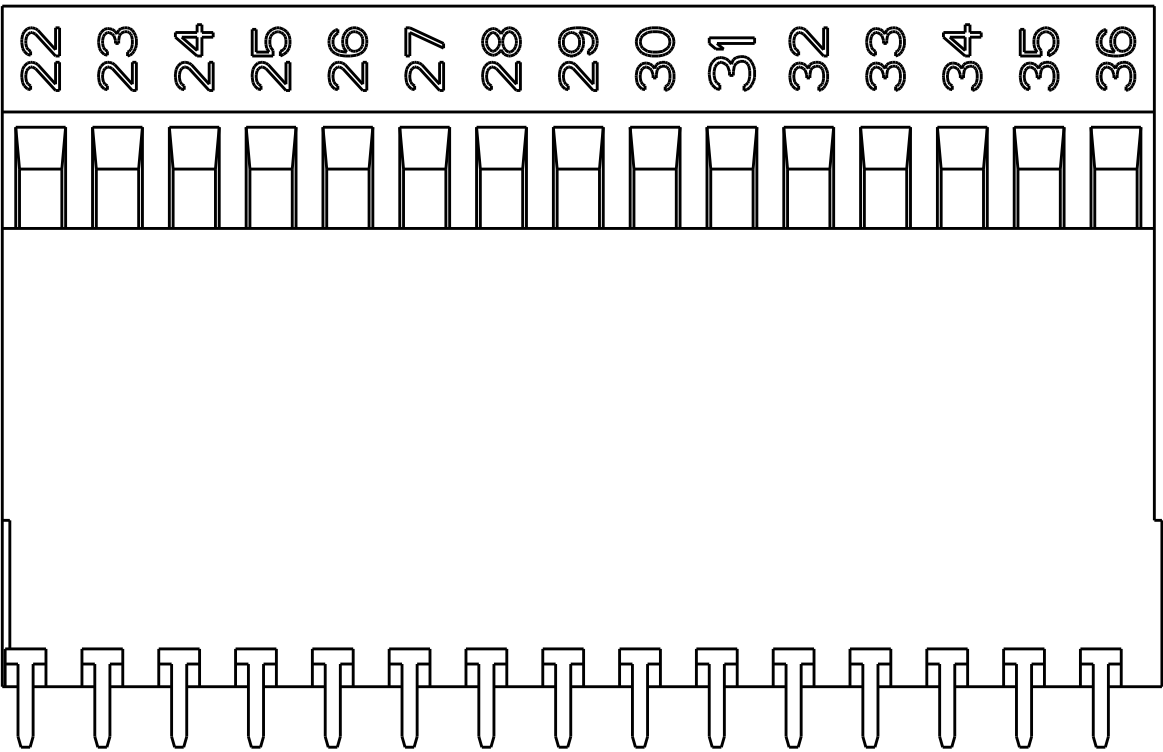

DETAIL E
SCALE 2:1

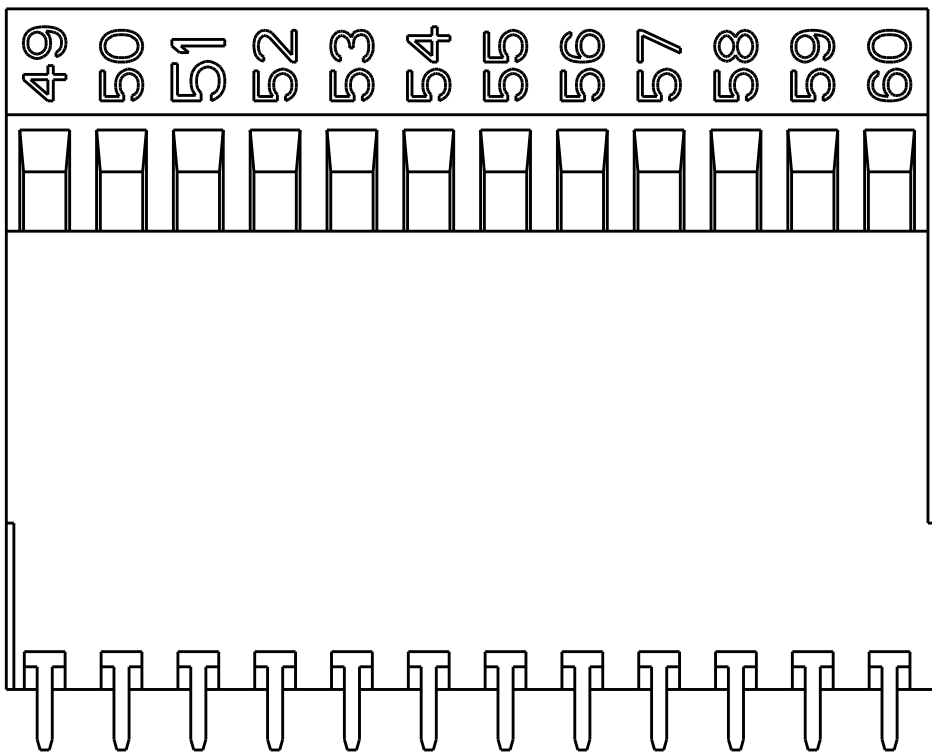

DETAIL F
SCALE 2:1

THIS DRAWING IS A CONTROLLED DOCUMENT.

DIMENSIONS:

mm

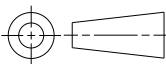

TOLERANCES UNLESS OTHERWISE SPECIFIED:

0 PLC ±
1 PLC ±.3
2 PLC ±.25
3 PLC ±
4 PLC ±
ANGLES ±2

MATERIAL

FINISH

DWN 09NOV2001

E. ZANOLINI

CHK 09NOV2001

D. BIEVENOUR

APVD 09NOV2001

D. BIEVENOUR

PRODUCT SPEC

108-20166

APPLICATION SPEC

114-20079

WEIGHT

-

CUSTOMER DRAWING



TE Connectivity

NAME
TERMINAL BLOCK, PCB MOUNT
3RD LEVEL
STACKING W/INTERLOCK, 5.08mm PITCH

SIZE

CAGE CODE

DRAWING NO

RESTRICTED TO

A3

00779

C-282925

-

SCALE

2:1

SHEET

3 OF 3

REV

C7