

TL-127 Key Switch



Characteristic

Room saving design with its less extrusion or intrusion appearance.
Since microswitch is unified with the body, installation can be made as simple as with a nut.

Application

Measuring instruments /
Office automation appliances /
Information devices

Model No.	Key No.	Net Weight (g)	Code No.
TL-127	127	112.6	1256

Parts List

No.	Part Name	Material	Finish	Quantity
1	Key	C3713	Ni	2
2	Lock Body	C3604	Cr	1
3	Set Nut		Ni	1
4	Microswitch	—	—	1
5	Pan Headed Screw	S	Zn	2
6	Washer			2

General Properties of Microswitch

Product Name	Matsushita Electric Works FS-T-Type Microswitch AVL-3225
Type	Single Pole Switching
Terminal	Plate Solder Terminal
Rating	AC250V 5A DC 30V 5A (Resistance Load) DC125V 0.4A (COS $\phi \approx 1.0$)
Mechanical Life Expectancy	10,000,000 Operations Min. (60 Operations/Min)
Electrical Life Expectancy	50,000 operations Min. (20 Operations/Min) (Rated Load)
Insulation Resistance	100M Ω Min. (at 500V DC) with Insulation-Resistance Tester
Dielectric Strength	1,000V AC for 1Min Between Non-Continuous Terminals. 1,500V AC for 1 Min Between Each Terminal and Terminal on Non-Current-Carrying Metal. 1,500V AC for 1 Min Between Current-Carrying Metal Part and Ground.
Contact Resistance	Initial Value 50m Ω Max. (6 to 8V DC 1A with Voltage Drop Method)
Ambient Temperature Operating	-25°C to 80°C (with No Icing)
Ambient Humidity Operating	85% Max.

Position	Contact Form
A	
B	

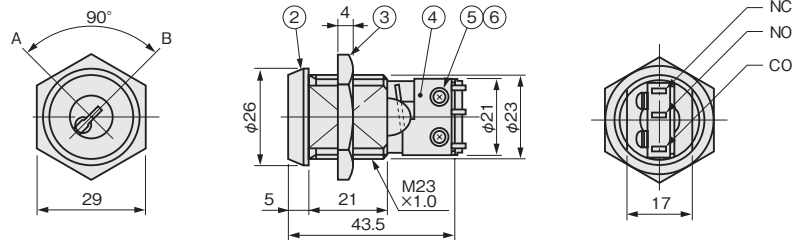

※Key can be inserted or removed at points A and B.

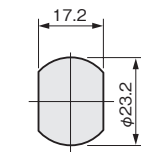
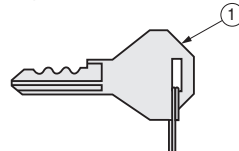

Layout of Hole for Installation