

Molding Type Power Inductor

ASPI-0630HI



RoHS
Compliant



7.2 x 6.65 x 3.0 mm

FEATURES:

- High saturation current.
- Low loss due to low DC resistance.
- Frequency application up to 3MHz.
- Low profile with max thickness 3.0mm.
- 100% lead free and metted RoHS standard.
- Suitable for reflow soldering.
- High reliable SMD package

APPLICATIONS:

- DC/DC converters in Notebook, Netbook, desktop and server
- Low profile, high current power supplies.

STANDARD SPECIFICATIONS

| | |
|-----------------------------------|---|
| Abrakon P/N: | ASPI-0630HI Series |
| Operating Temperature & Humidity: | -55°C to +125°C (Including self generated heat) |
| Storage Temperature & Humidity: | +25°C to +35°C, 45% to 85% RH |

| Part Number | Inductance | Tolerance | DCR Typ | DCR Max | Saturation Current | Temperature Rise Current |
|-----------------|------------|-----------|---------|---------|--------------------|--------------------------|
| Units | μH | % | mΩ | mΩ | A | A |
| Symbol | L | M | | | Isat | Irms |
| ASPI-0630HI-1R0 | 1.0 | M | 9.0 | 10.0 | 20.5 | 11.0 |
| ASPI-0630HI-1R5 | 1.5 | M | 14.0 | 15.0 | 17.0 | 9.0 |
| ASPI-0630HI-2R2 | 2.2 | M | 18.0 | 20.0 | 14.0 | 8.0 |
| ASPI-0630HI-3R3 | 3.3 | M | 28.0 | 30.0 | 13.5 | 6.8 |
| ASPI-0630HI-4R7 | 4.7 | M | 37.0 | 40.0 | 10.0 | 5.5 |
| ASPI-0630HI-6R8 | 6.8 | M | 54.0 | 60.0 | 8.0 | 4.5 |
| ASPI-0630HI-100 | 10.0 | M | 102.0 | 105.0 | 7.0 | 3.0 |

Test Conditions

Inductance is measured in HP-4285A Precision LCR Meter.

RDC is measured in HP-4338B milli ohm meter.(or equivalent).

Isat: Based on inductance change ($\Delta L/L_0 : \leq -20\%$)

Irms: Based on temperature rise ($\Delta T : 40^\circ\text{C TYP.}$)

ELECTRICAL CHARACTERISTIC CU

ASPI-0630HI-1R0

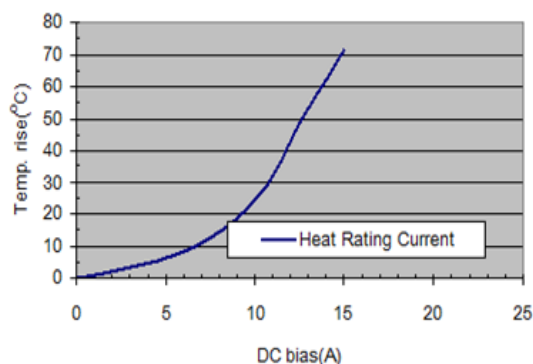
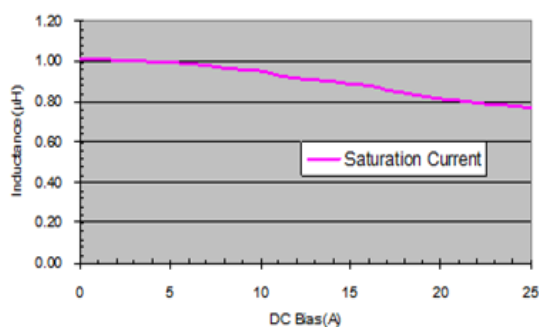

Molding Type Power Inductor

ASPI-0630HI



RoHS
Compliant



7.2 x 6.65 x 3.0 mm

ELECTRICAL CHARACTERISTIC CURVES

ASPI-0630HI-1R5

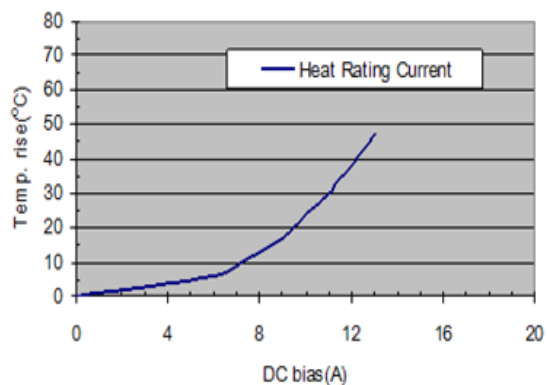
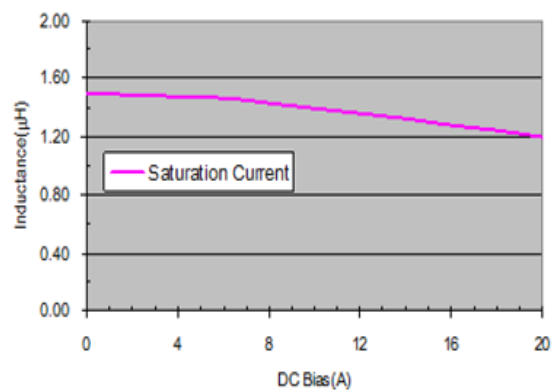

ASPI-0630HI-2R2

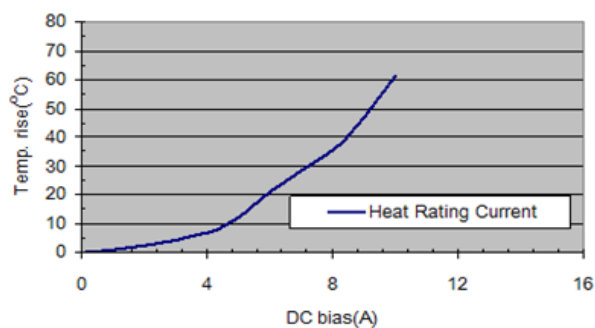
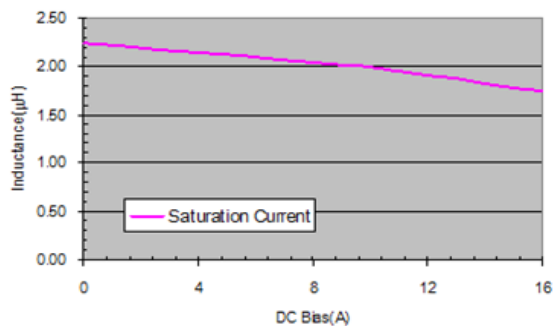

ASPI-0630HI-3R3

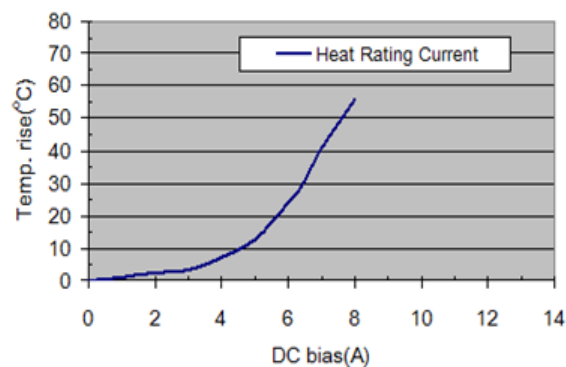
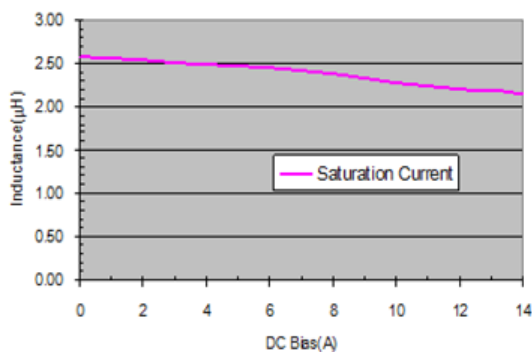

Molding Type Power Inductor

ASPI-0630HI



RoHS
Compliant



7.2 x 6.65 x 3.0 mm

ELECTRICAL CHARACTERISTIC CURVES

ASPI-0630HI-4R7

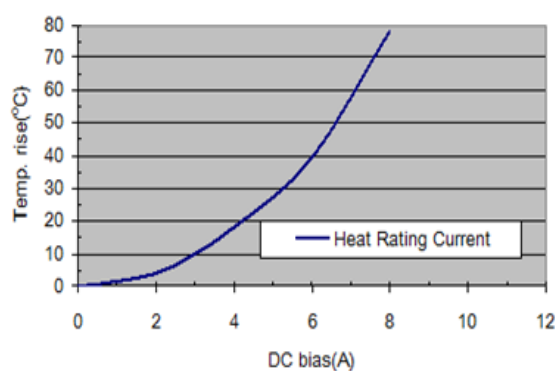
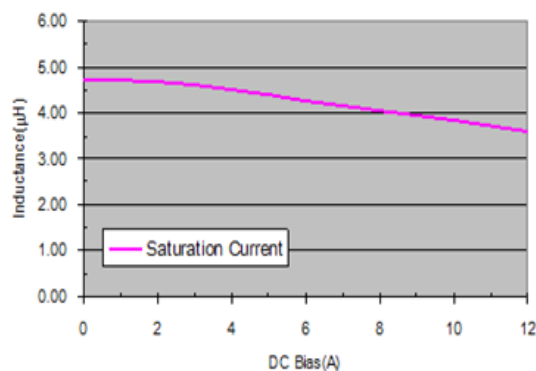

ASPI-0630HI-6R8

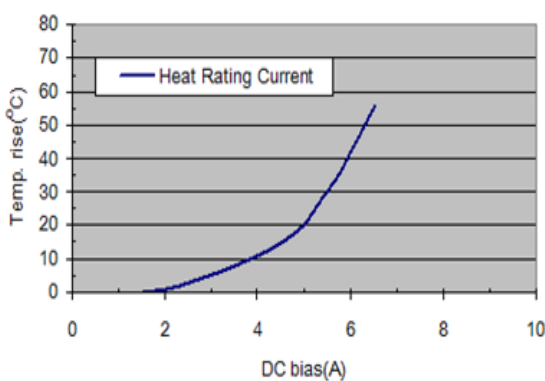
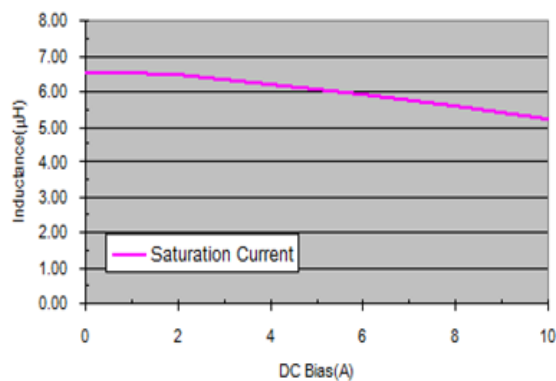

ASPI-0630HI-100

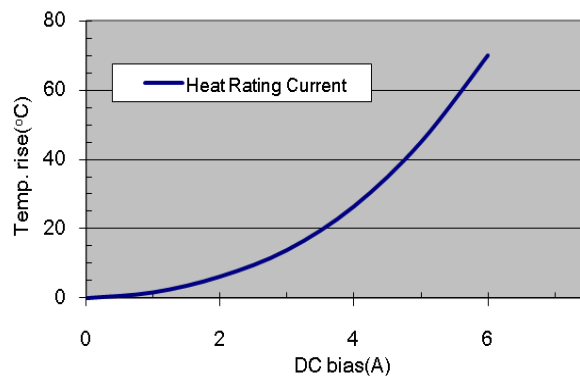
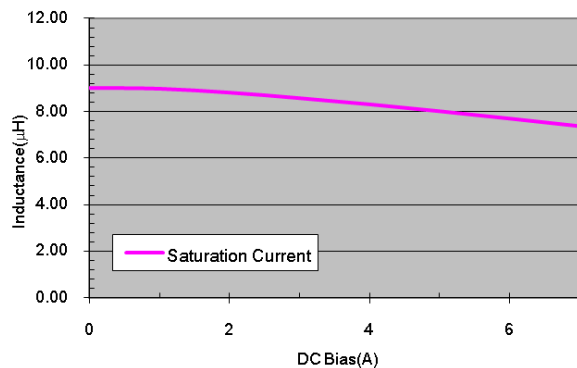

Molding Type Power Inductor

ASPI-0630HI



RoHS
Compliant



7.2 x 6.65 x 3.0 mm

PART NUMBER IDENTIFICATION

ASPI-0630HI- -

Inductance Code

Please refer to the
Electrical Spec Table

Tolerance

M: $\pm 20\%$

Packaging

T15: Tape and Reel (1.5kpcs /
reel)

OUTLINE DRAWING:

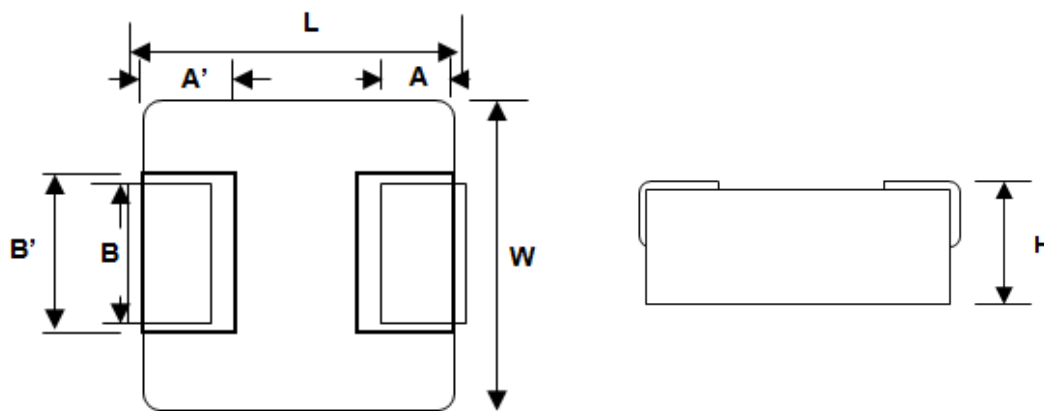

| A | A' | B | B' | L | W | H max |
|---------------|---------------|---------------|---------------|---------------|----------------|-------|
| 1.6 ± 0.4 | 2.0 ± 0.1 | 3.0 ± 0.3 | 3.4 ± 0.2 | 7.2 ± 0.3 | 6.65 ± 0.2 | 3.0 |

Recommended Land Pattern

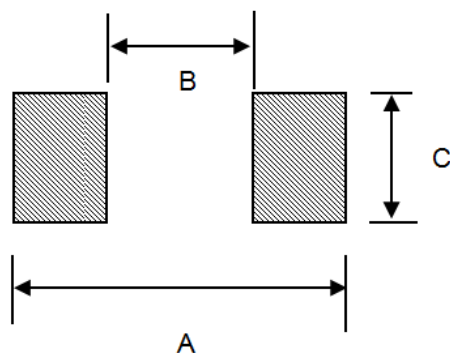

| A | B | C |
|-----|-----|-----|
| 8.4 | 3.7 | 3.4 |

Dimension: mm



Molding Type Power Inductor

ASPI-0630HI



RoHS
Compliant



7.2 x 6.65 x 3.0 mm

TAPE & REEL:

T1: 1,500pcs / reel

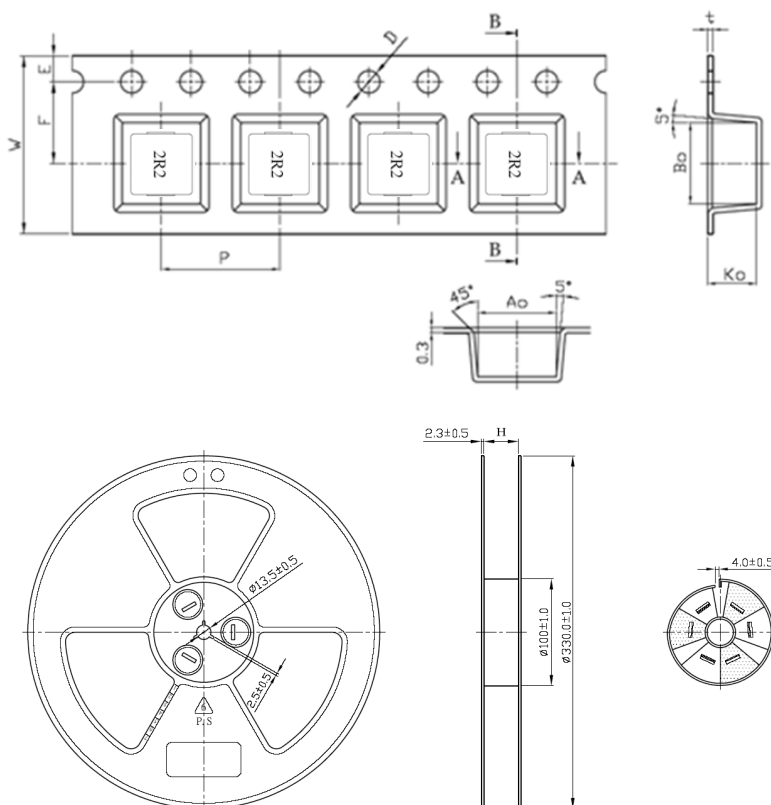

| | |
|----|------|
| A0 | 7.2 |
| B0 | 7.5 |
| K0 | 3.6 |
| P | 12.0 |
| t | 0.3 |
| W | 16 |
| E | 1.75 |
| F | 7.5 |
| D | 1.5 |

Dimension: mm

REFLOW PROFILE:

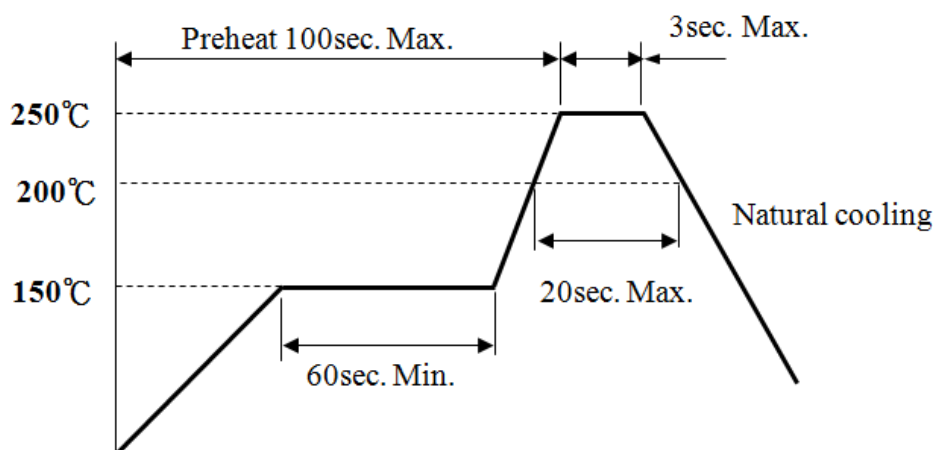

ATTENTION: Abracon Corporation's products are COTS – Commercial-Off-The-Shelf products; suitable for Commercial, Industrial and, where designated, Automotive Applications. Abracon's products are not specifically designed for Military, Aviation, Aerospace, Life-dependant Medical applications or any application requiring high reliability where component failure could result in loss of life and/or property. For applications requiring high reliability and/or presenting an extreme operating environment, written consent and authorization from Abracon Corporation is required. Please contact Abracon Corporation for more information.

ABRACON IS
ISO 9001:2008
CERTIFIED



Visit www.abracon.com for Terms & Conditions of Sale

30332 Esperanza, Rancho Santa Margarita, California 92688
tel 949-546-8000 | fax 949-546-8001 | www.abracon.com

Revised: 11.17.11