

# THA-301J Lever Handle Latch Application Submitted for a Utility Model



## THA-301J-1K (with key)

Japan Electric Association

Conformed Product of Approval Standard for Cubicle Type Private Incoming Facilities for Emergency Power

Conformed Product of Recommendation Standard for Cubicle Type Incoming Facilities for High-Voltage Power

## Characteristic

With modified slide cap design, safety and operability have been increased. Having size of large, medium, and small, with key or without key, select one for your application.

## Application

Distribution boards / Distribution panels / Control boards / Various types of boxes

## Specification

Can be set on left side or right side, and the making the change can be done easily. All keys have the same key No. Cylinder locks by 180-degree turn clockwise. Insert or taking off the key can be done at both lock and unlock positions. Waterproof specification using an O-ring.

Model No.	Key No.	Net Weight(g)	Code No.	
THA-301J-1K	No.2200	474	3799	
THA-301J-1	Without Key	489	3800	
THA-301J-2K	No.2200	340	3729	
THA-301J-2	Without Key	336	3730	
THA-301J-3K	No.2200	296	3815	
THA-301J-3	Without Key	292	3816	

※No.200 and No.2000 keys are available.

## Parts List

No.	Part Name	Material	Finish	Quantity
1	Body	ZDC	Cr	1
2	Receiver			1
3	Packing	CR	Black	1
4	Slotted Washer	S	Zn	1
5	Nut	ZDC		1
6	Square Hole Washer	SPCC		1
7	Square Hole Washer			1
8	Flat Washer			1
9	Hexagon Bolt	S		1
10	Cap	ZDC	Cr	1
11	Rotor	ZDC/SUS	Zn	1
12	Key	BSP	Ni	2

## Size List

Model No.	A	B	B1	B2	C	D1	D2	E	F	G	H	J
THA-301J-1K	120	27	34	φ 60	48.5	22.5	8	35	40	φ 8.5	16	□10
THA-301J-1												
THA-301J-2K	100	25	32	φ 48	44.5	14.3	5	30	32	φ 8.0	15	□8
THA-301J-2												
THA-301J-3K	80	23	30	φ 46		14.8					12	
THA-301J-3												

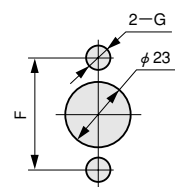

THA-301J-1K and -1

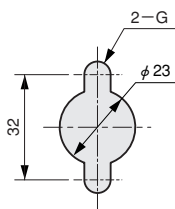

THA-301J-2K, -2,  
THA-301J-3K, and -3

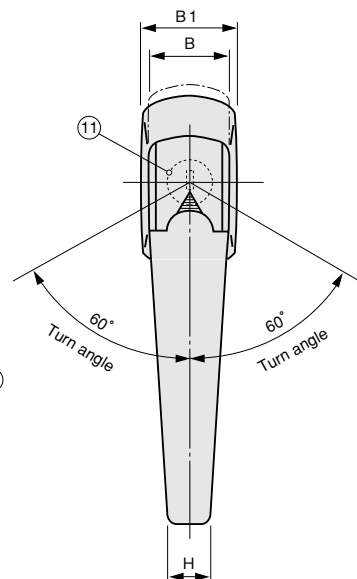
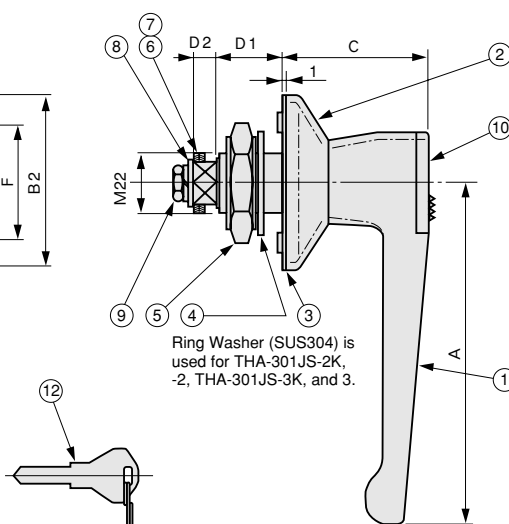
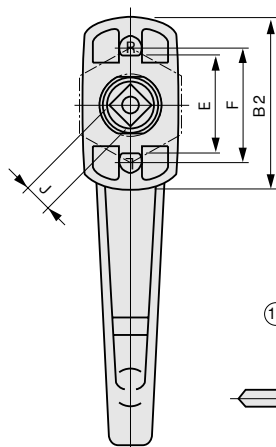

●The figures shows THA-301J-1K.