

1. MATERIALS AND FINISHES (PLATING THICKNESS IN MICROINCHES):	
BODY ASSEMBLY	- BRASS, GOLD PLATING (50 MIN THICK)
CAP	- BRASS, GOLD PLATING (50 MIN THICK)
LOOSE CONTACT	- BeCu, GOLD PLATING (50 MIN THICK)
& ASSEMBLED CONTACT	
GASKET	- SILICONE RUBBER
RETAINGING RING	- BeCu
COUPLING NUT	- BeCu, GOLD PLATING (50 MIN THICK)
OUTER FERRULE	- COPPER, GOLD PLATING (50 MIN THICK)
HEAT SHRINK TUBING	- POLYOLEFIN
ASSEMBLED CONTACT	- BRASS, GOLD PLATING (50 MIN THICK)
INSULATORS	- PTFE

2. ELECTRICAL:
A. IMPEDANCE: 50 OHM

3. MECHANICAL:
A. DURABILITY: 500 CYCLES MIN.
B. TEMPERATURE RANGE: -65° C TO +165° C

4. PACKAGING:
A. QUANTITY: SINGLE PACK
B. MARKING: BAG TO BE MARKED
"AMPHENOL, 901-148-15, AND DATE CODE"

5. CABLE ASSEMBLY INSTRUCTIONS

- A. TRIM CABLE AS SHOWN.
- B. SOLDER CABLE CENTER CONDUCTOR TO CONTACT.
- C. INSERT CABLE WITH PTFE INSULATOR ENTERING CONNECTOR AND BRAID OVER KNURL.
- D. CRIMP FERRULE WITH AMPHENOL TOOL 227-944 AND DIE SET 227-1221-57 CLOSURE 'A', .213" HEX DIE. USE M22520/1-15 POSITIONER.

6

$\varnothing 0.220$

HEAT SHRINK TUBING

OUTER FERRULE

$\varnothing .016$ MIN
3 SAFETY WIRE HOLES

3 SAFETY WIRE HOLES

THIS CONNECTOR IS COVERED BY U.S. PATENT 3,439,294.

CUSTOMER OUTLINE DRAWING

ALL OTHER SHEETS ARE FOR INTERNAL USE ONLY

REVISIONS

REV	DESCRIPTION	DATE	ECO	APPR
--	OFFICIAL ENG. RELEASE TO MFG.	-----	-----	
AA	REDRAWN IN PRO E & ADDED COD	9/20/13	49679	KR
AB	ADDED VIEW FOR WIRE HOLES	3/19/14	49912	CPM

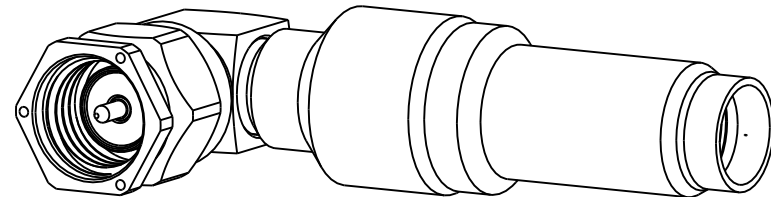

SCALE 2.500

RECOMMENDED CABLE STRIPPING DIMENSIONS

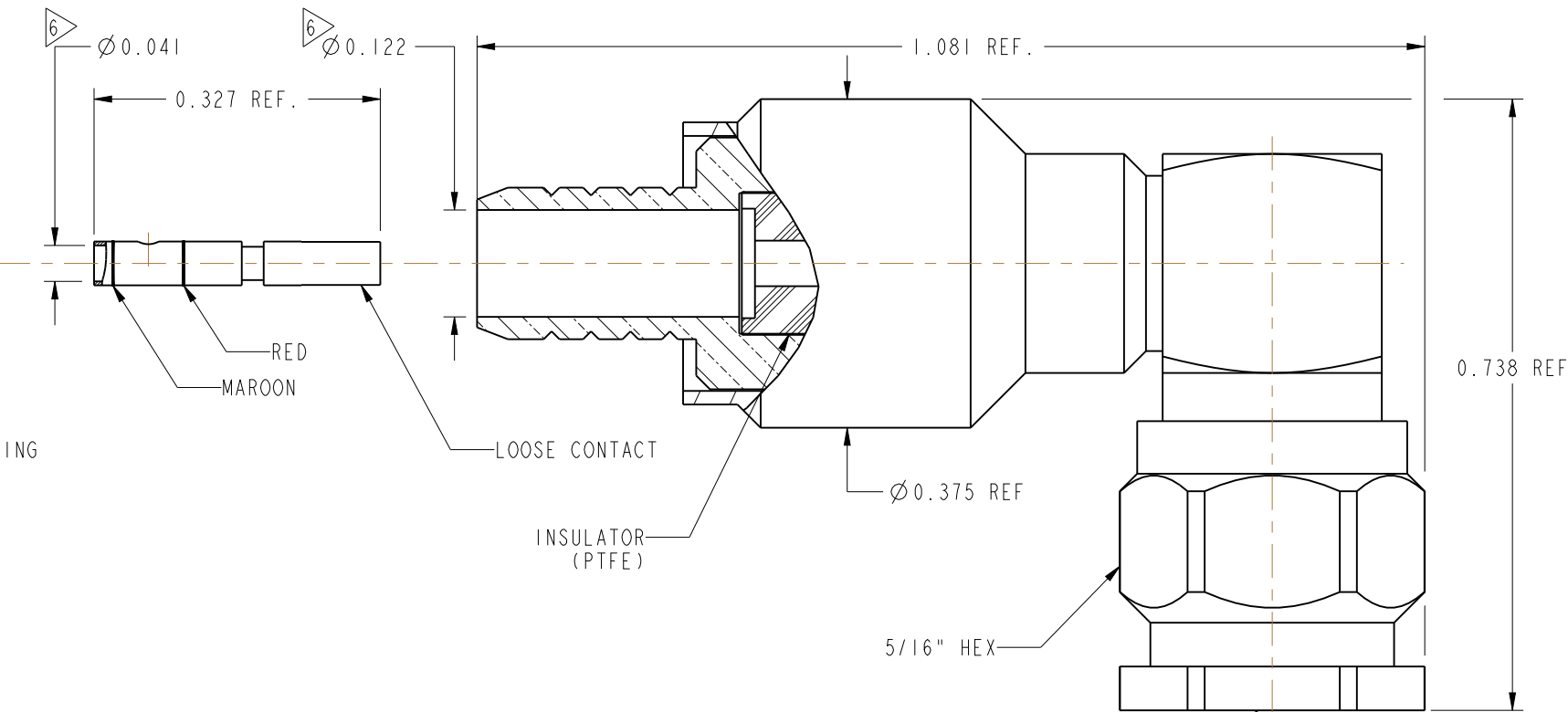

INTERFACE PER -
MIL-STD-348
SMA SERIES

UNLESS OTHERWISE SPECIFIED, DIMENSIONS ARE IN INCHES AND TOLERANCES ARE: 2 PLACE DECIMAL 3 PLACE DECIMAL ANGLES $\pm .015$ (0,381 mm) $\pm .005$ (0,127 mm) $\pm 1^\circ$ NOTICE - These drawings, specifications, or other data (1) are, and remain the property of Amphenol corp. (2) must be returned upon request; and (3) are confidential and not to be disclosed to any person other than those to whom they are given by Amphenol Corp. the furnishing of these drawings, specifications, or other data by Amphenol Corp., or to any other person to anyone for any purpose is not to be regarded by implication or otherwise in any manner licensing, granting rights to permitting such holder or any other person to manufacture, use or sell any product, process or design, patented or otherwise, that may in any way be related to or disclosed by said drawings, specifications, or other data.	MATERIAL SEE NOTES	DRAWN KARTHIK R	DATE 12-Aug-13	TITLE SMA 90° PLUG CRIMP TYPE FOR RG-400/U & 142/U CABLE	Amphenol RF www.amphenolrf.com	
		ENGINEER ABR	DATE 09-Jul-80		DRAWING NO. 901-148-15	
		REFERENCE DOR 312191-51 M39012/56-4502	APPROVED K. CAPOZZI	DATE 9/20/13	SCALE: 5.0:1.0	SHEET 2 OF 2
		FINISH	CAD FILE	DWG SIZE B	REV AB	ITEM NO. 901-148-15 PART NO. 901-148-15

Mouser Electronics

Authorized Distributor

Click to View Pricing, Inventory, Delivery & Lifecycle Information:

[Amphenol:](#)

[901-148-15](#)