



- Ⓢ POTS CPE Splitter Filter Module for standard ADSL and ADSL+ VOIP applications
- Ⓢ Complies with ITU G.992.1 Annex E2 standard for applications in Korea/Asia
- Ⓢ Footprint is compatible with a range of Pulse Splitter Filter Modules
- Ⓢ RoHS-6 compliant

Electrical Specifications @ 25°C

DC Characteristics	
DC Resistance from tip to ground and from ring to ground / tip-to-ring	$\geq 5\text{M}\Omega / \leq 25\Omega$
DC Feeding Current	0 to 100mA
DC POTS tip-to-ring voltages / Ringing Signals at 20Hz to 30Hz	0 to -60V / < 103Vrms
Voice Band Insertion Loss at 1kHz	
Short Loop / Long Loop	< 1.0dB / < 0.75dB
Voice Band Attenuation Distortion at 1kHz	
Between 0.2 and 3.4kHz (short loop) / (long loop)	+1.5 to -1.5dB / +0.5 to -1.5dB
Between 3.4 and 4.0kHz (short loop) / (long loop)	+2.0 to -2.0dB / +1.0 to -1.5dB
Voice Band Delay Distortion	
Between 0.6 and 3.2kHz (short and long loops) / Between 0.2 and 4.0kHz	< 200 μ s / < 250 μ s
Voice Band Return Loss	
ERL / SRL-L	> 6dB / > 5dB
SRL-H (single freq.)	> 3 dB (> 2 dB)
Intermodulation Distortion at -9Bm	
Second Order / Third Order	$\geq 57\text{dB} / \geq 60\text{B}$
Longitudinal Balance per IEEE Method (2-port testing technique)	
Between 200 Hz and 1 kHz / Between 1 kHz and 3 kHz	> 58 dB / > 53 dB
Capacitance	
Tip-to-ring without modem / Capacitance to ground	20 to 115nF / < 1.0nF
DSL Stop Band Attenuation with input level of 10dBm	
Between 32 and 300kHz / Between 300kHz and 15MHz	> 65dB / > 55dB
DSL Insertion Loss from 30kHz to 2.2MHz with input level of -10dBm	
	$\leq 0.25\text{dB}$

Notes: For VDSL2 (30MHz) compatible version, refer to BX8214V.

ADSL POTS CPE Splitter

BX8270NL

Smart Series

Mechanical

BX8270NL

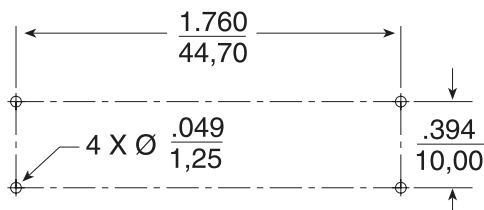
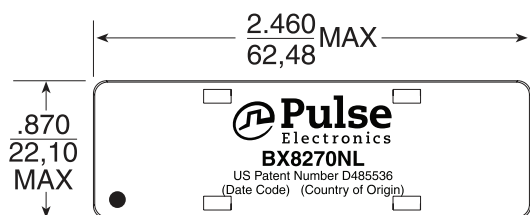

SUGGESTED BOARD LAYOUT

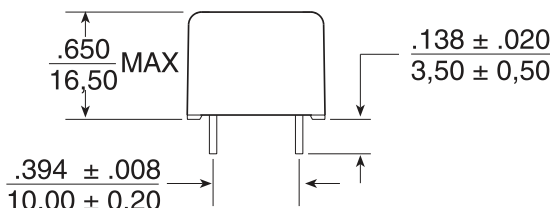
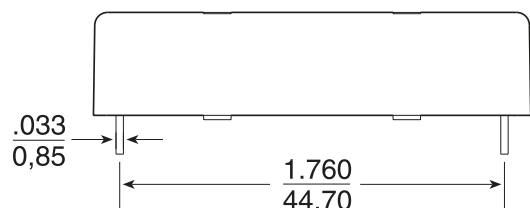

Weight15 grams

Tray35/tray

Dimensions: $\frac{\text{Inches}}{\text{mm}}$

Unless otherwise specified,
all tolerances are $\pm \frac{.010}{0,25}$

Schematic

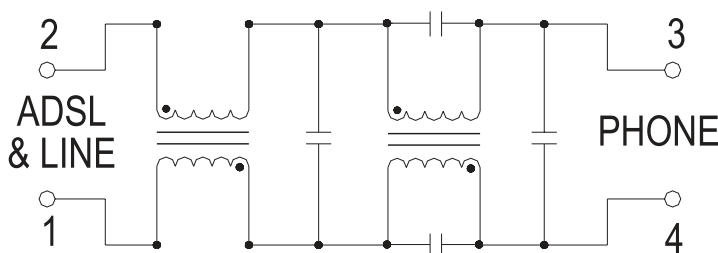

For More Information

Pulse Worldwide Headquarters

12220 World Trade Drive
San Diego, CA
92128
U.S.A.

Tel: 858 674 8100
Fax: 858 674 8262

Pulse Europe

Einsteinstrasse 1
D-71083 Herrenberg
Germany

Tel: 49 7032 78060
Fax: 49 7032 7806 135

Pulse China Headquarters

B402, Shenzhen Academy of
Aerospace Technology Bldg.
10th Kejinan Road
High-Tech Zone
Nanshan District
Shenzhen, PR China
518057
Tel: 86 755 33966678
Fax: 86 755 33966700

Pulse North China

Room 2704/2705
Super Ocean Finance Ctr.
2067 Yan An Road
West
Shanghai 200336
China

Tel: 86 21 62787060
Fax: 86 2162786973

Pulse South Asia

135 Joo Seng Road
#03-02
PM Industrial Bldg.
Singapore 368363

Tel: 65 6287 8998
Fax: 65 6287 8998

Pulse North Asia

3F, No. 198
Zhongyuan Road
Zhongli City
Taoyuan County 320
Taiwan R. O. C.

Tel: 886 3 4356768
Fax: 886 3 4356823 (Pulse)
Fax: 886 3 4356820 (FRE)

Performance warranty of products offered on this data sheet is limited to the parameters specified. Data is subject to change without notice. Other brand and product names mentioned herein may be trademarks or registered trademarks of their respective owners. © Copyright, 2012. Pulse Electronics, Inc. All rights reserved.