

Date	SYM	REVISION RECORD	AUTH	DR.	CK.
1/07/06	A	ADDED "ROHS COMPLIANT"	T.B.	B.S.	
2/04/06	B	ADDED CHAMFERS	T.B.	B.S.	
10/10/08	C	UPDATED PCB LAYOUT	T.B.	B.S.	
11/14/14	D	UPDATED TO ROHS 2 COMPLIANT	T.B.	B.S.	

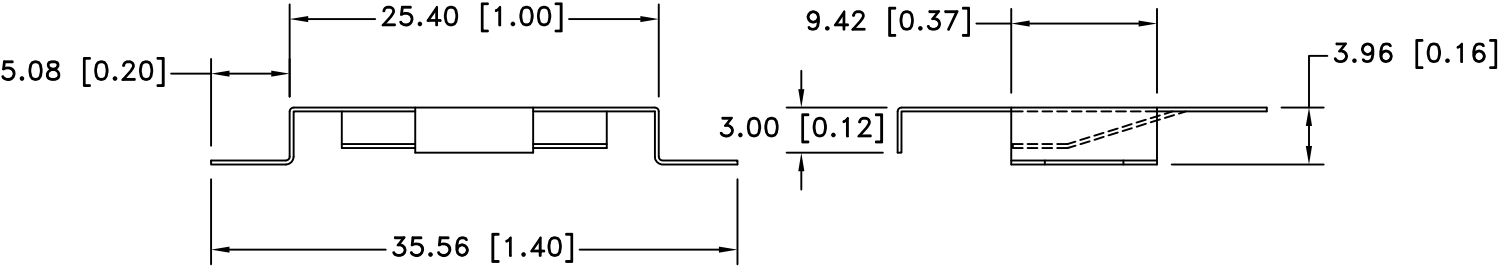
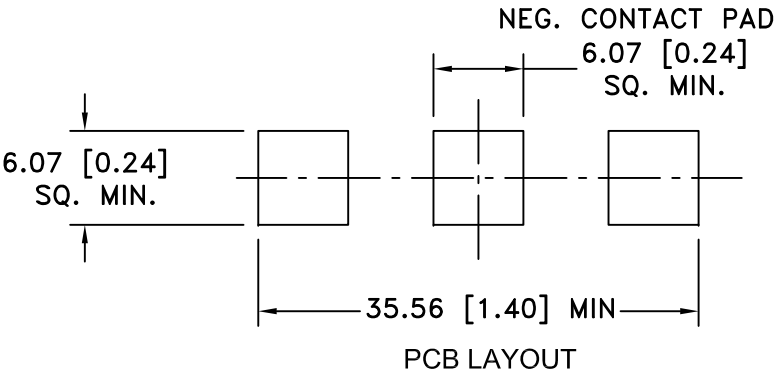
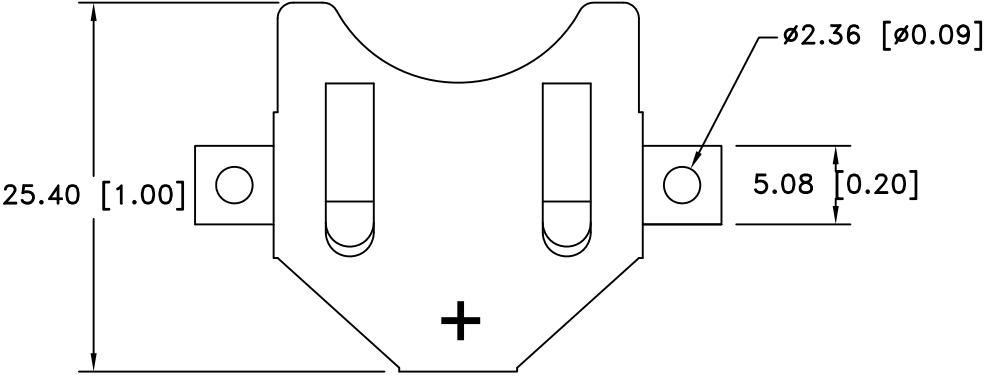

NOTES:
 1. MATERIAL:
 0.25mm PHOSPHOR BRONZE, NICKEL PLATED.
 2. ROHS 2 COMPLIANT

CELL SIZE	RETAINS BATTERY NUMBERS
24mm	CR2430, DL2430

Tolerance (Except as noted)	<div><div><div><div></div><div></div><div></div><div></div></div><div>MPD</div></div><div>Memory Protection Devices, Inc</div><div>200 Broad Hollow Road, Farmingdale, New York 11735</div></div>		
decimal ±.5 (.020)		Scale	Drawn By B.S.
Fractional ± .8 (.030)			Approved By T.B.
Angular ± 3°	Title COIN CELL RETAINER FOR 24mm DIA. BATTERIES		
	Date 11/14/14	Drawing Number BK-886	