

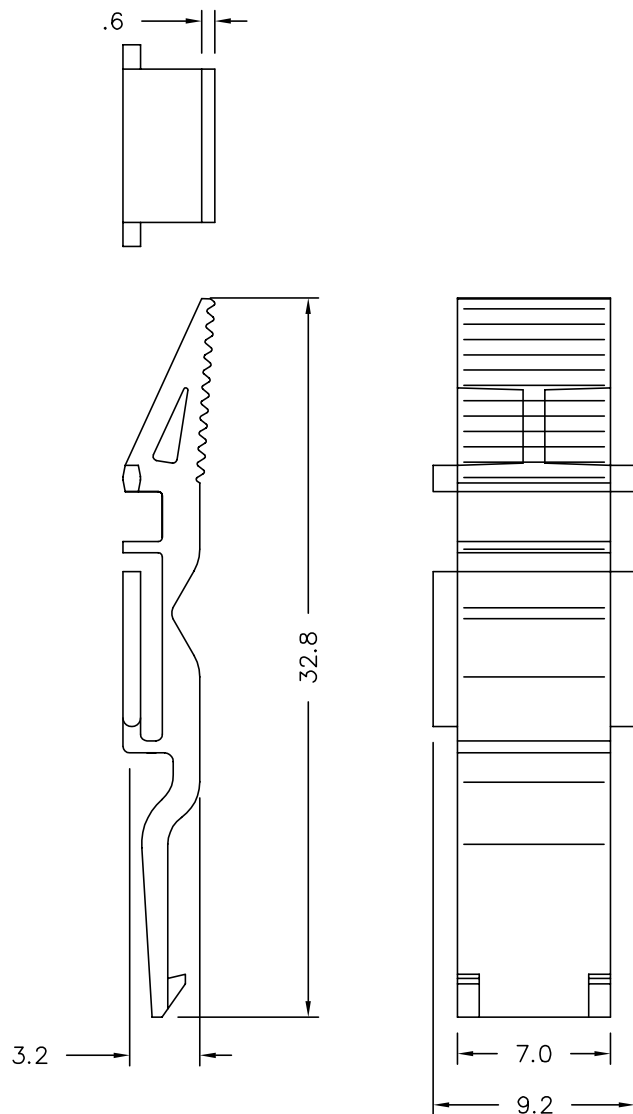

Copyright FCI.



#### NOTES:

1. SEE APPLICATION SPECIFICATIONS GS-20-002 & GS-20-003 FOR INSTRUCTION ON WIRE INSERTION AND ASSEMBLY OF COMPONENTS FOR CONNECTORS USING THESE LATCH FINGERS.
2. PART NUMBERS -0021 TO -0071 HAVE LIMITED AVAILABILITY. PLEASE CONSULT YOUR FCI REPRESENTATIVE BEFORE ORDERING.
3. MATERIAL:  
ULTEM 1010, FLAME RETARDANT UL-94-V0.
4. THE PRODUCTS WHERE THE PART NUMBER ENDS IN LF MEET THE EUROPEAN UNION DIRECTIVES AND OTHER COUNTRY REGULATIONS AS DESCRIBED IN GS-22-008.
5. THESE PRODUCTS LISTED ON THIS DRAWING WILL NOT WITHSTAND WAVE SOLDER OR REFLOW OPERATIONS.
6. FOR LEAD FREE PART NUMBERS, ADD AN 'LF' SUFFIX. EXAMPLE 72389-0011LF.

\* SEE NOTE 2

PART NUMBER	COLOR
72389-0011LF	BLACK
* 72389-0021LF	WHITE
* 72389-0031LF	ORANGE
* 72389-0041LF	GREEN
* 72389-0051LF	BLUE
* 72389-0061LF	BROWN
* 72389-0071LF	GRAY

rev	ecn no	dr	date
D	V05-0594	VS	2005-08-08
E	V06-0613	JRV	2006-06-22
F	N11-0090	AZH	2011-04-07

www.fciconnect.com			surface ISO 1302	tolerance ISO 406 ISO 1101	projection ISO 10	MM
			TOLERANCES UNLESS OTHERWISE SPECIFIED		size A4	Scale 1:1
Dr	J.R.VOLSTROF	1997-11-05	ANGULAR 0° ±2.0°	0.X ± 0.10	ECN N11-0090	
Eng	J.R.VOLSTROF	1997-11-05		0.XX ± 0.05		
Chr	J.R.VOLSTROF	1997-11-05		0.XXX ± 0.02		
Appr	J.R.VOLSTROF	1997-11-05	Product family		METRAL	Spec ref
			title		dwg no	Rev.
			SHORT LATCH FINGER 4 & 5 ROW METRAL		72389	F
			catalog no		CUSTOMER	sheet 1 of 1