

DEE/U 104 Multipole Receptacles

Contact polarity A

Contact polarity Z

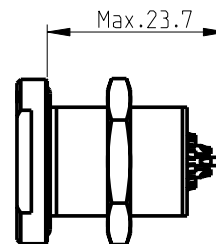
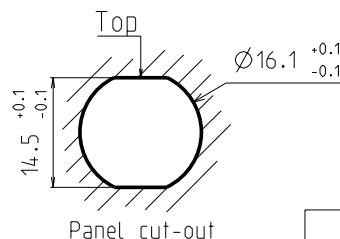

Solder (-x30/-x40)

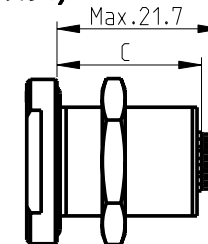

PCB (-x39/-x49)

All dimensions see note 1)

Panel:
Min.0
Max.15

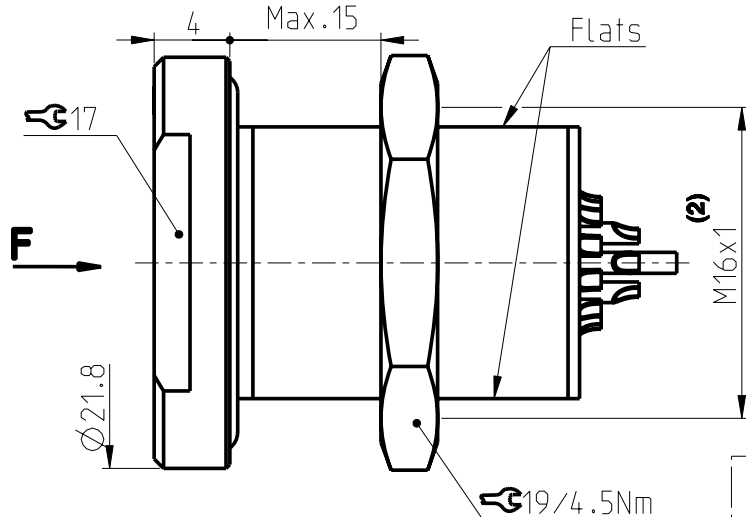

CONTACT CONFIGURATION	Contacts	Solder cup ϕ		C	PIN ϕ
104 A Z 051	2	1.86		-	-
104 A Z 040	3	1.86		-	-
104 A Z 037	4	1.18		-	-
104 A Z 087	4	0.79/2.48		19.4 18.9	0.50/1.60 0.70/1.07
104 A Z 053	5	1.18		-	-

Pin layout / PCB hole pattern for polarity A - View from F (3)

040

037

087

053

(4)

(4)

(4)

(4)

Keying codes (View from F)

Code 1
(-1xx)

Code 2
(-2xx)

Code 3
(-3xx)

Guide mark

Guide mark

Guide mark

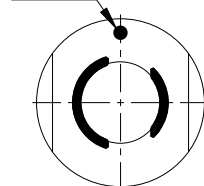
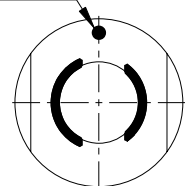
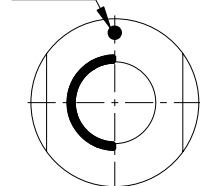

(4)

(4)

(4)

(4)

Polarity Z - View from F

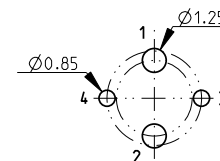
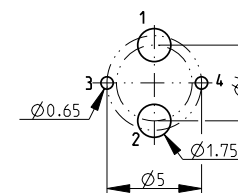

All dimensions in mm

600539

Rev.

1

Pages

1/3

Notes :

1) All tolerances resulting from connector assembly are typically ± 0.3 mm
2) If receptacle is screwed directly into threaded hole, oversize thread by $+0.05$ mm

3) Recommended PCB hole dimensions may be adjusted to application

4) Please contact us

Part number example : DEE 104 A092-130

fischer

www.fischerconnectors.com

Information provided herein is believed to be accurate at time of publishing. Fischer Connectors reserves the right to make modifications on products for continuous improvement without prior notice.

DEE/U 104 Multipole Receptacles

Contact polarity A

Contact polarity Z



Panel:
Min.0
Max.15

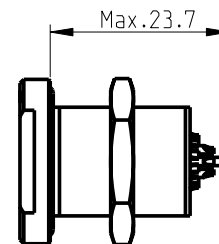
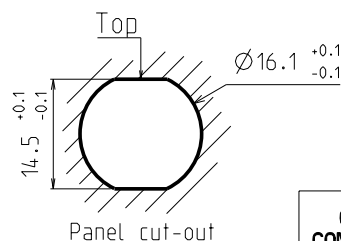

Solder (-x30/-x40)

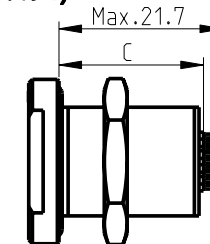

PCB (-x39/-x49)

All dimensions see note 1)

CONTACT CONFIGURATION	Contacts	Solder cup Ø		C	PIN Ø
104 A 065	6	0.79		19.4 19.1	0.50 0.63
104 A 054	7	0.79		-	-
104 A 066	8	0.79		19.4 -	0.50 -
104 A 055	9	0.79/1.18		-	-
104 A 056	11	0.79		19.4 19.1	0.50 0.63

Pin layout / PCB hole pattern for polarity A - View from F (3)

054

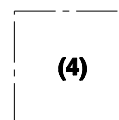

066

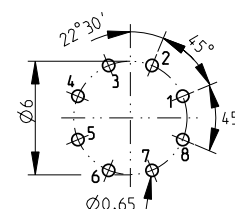

055

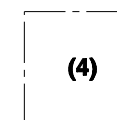

056

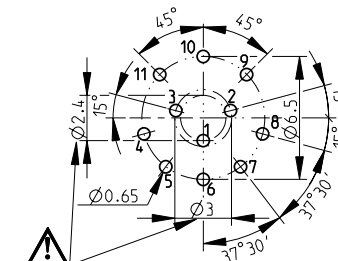

Polarity Z - View from F

(4)

(4)

(4)

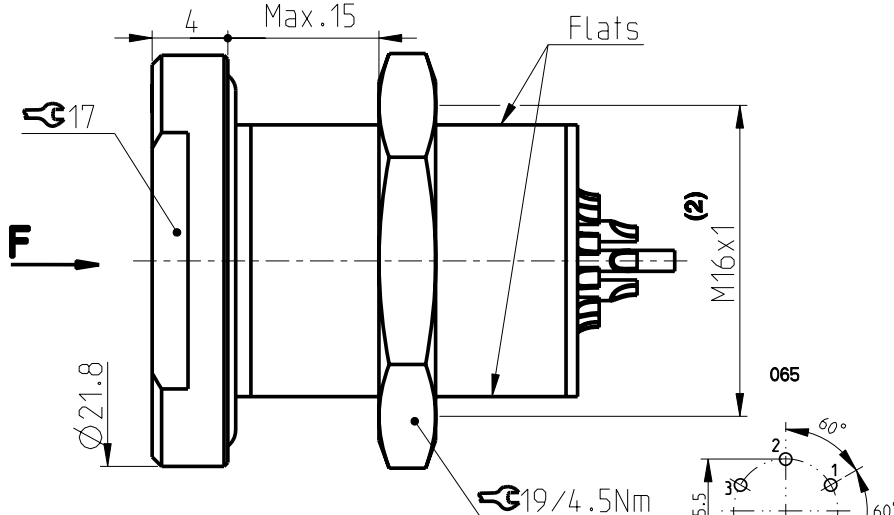
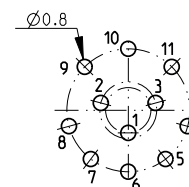

Keying codes (View from F)

Code 1 (-1xx)

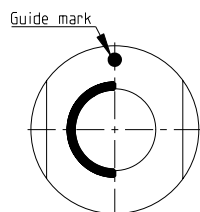

Code 2 (-2xx)

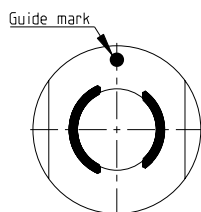

Code 3 (-3xx)

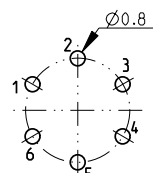
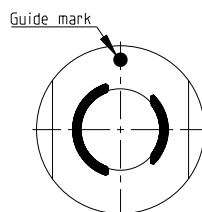

All dimensions in mm

600539

Rev.

1

Pages

2/3

Notes :

- 1) All tolerances resulting from connector assembly are typically $\pm 0.3\text{mm}$
- 2) If receptacle is screwed directly into threaded hole, oversize thread by $+0.05\text{mm}$

3) Recommended PCB hole dimensions may be adjusted to application

4) Please contact us

Part number example : DEE 104 A092-130



www.fischerconnectors.com

DEE/U 104 Multipole Receptacles

Contact polarity A

Contact polarity Z

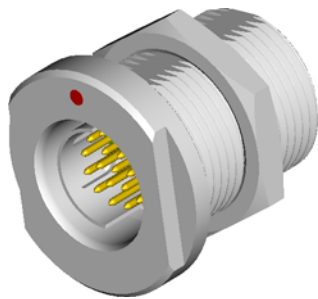

Panel:
Min.0
Max.15

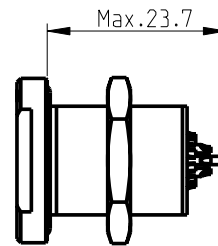
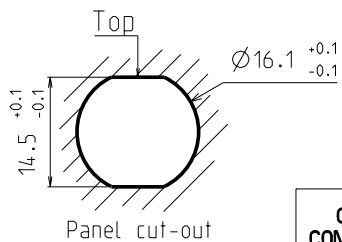

Solder (-x30/-x40)

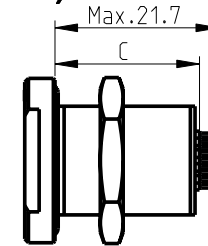

PCB (-x39/-x49)

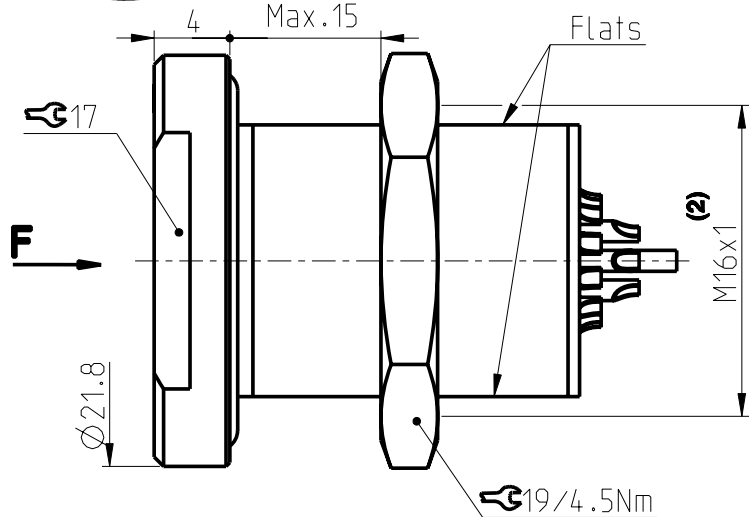

Keying codes (View from F)

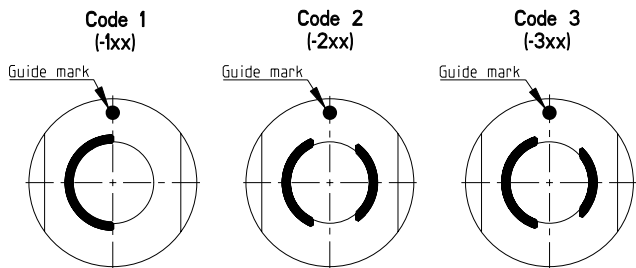

CONTACT CONFIGURATION			Contacts	Solder cup ϕ		C	PIN ϕ
104	A Z	086	16	0.79		19.4 -	0.5
104	A Z	092	19	0.79		-	-
*104	A	124	27	-		-	-

***Please contact us for additional information**

Pin layout / PCB hole pattern for polarity A - View from F ⁽³⁾

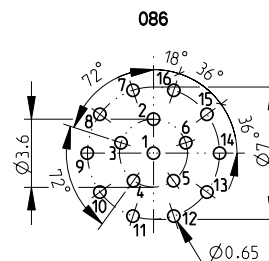

Polarity Z - View from F

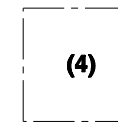
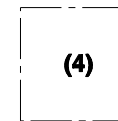
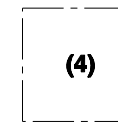
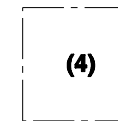
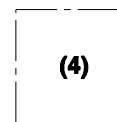

All dimensions in mm

600539

Rev.

1

Pages

3/3

Notes :

Notes :

- 1) All tolerances resulting from connector assembly are typically $\pm 0.3\text{mm}$
- 2) If receptacle is screwed directly into threaded hole, oversize thread by $+0.05\text{mm}$

3) Recommended PCB hole dimensions may be adjusted to application

4) Please contact us

Part number example : DEE 104 A092-130



www.fischerconnectors.com

Information provided herein is believed to be accurate at time of publishing. Fischer Connectors reserves the right to make modifications on products for continuous improvement without prior notice.