

Ring Terminal - insulated

Part No: FVL2216-5R2

STUD SIZE #10

SYM.	CHANGES	BY	DATE

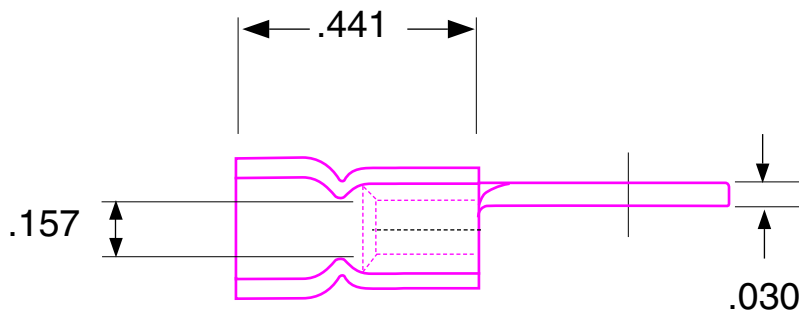
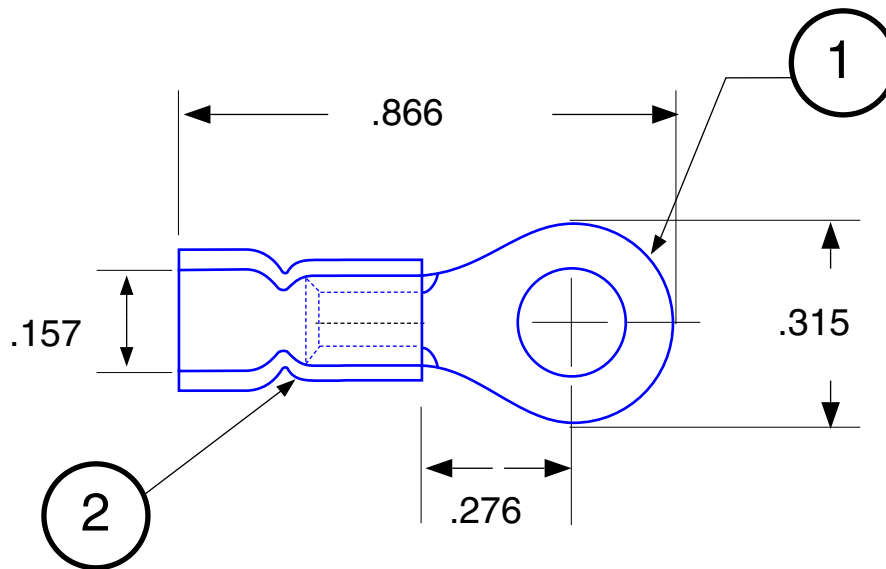

Max Electric Current: 22-16 AWG : 19 Amp
 Max Electric Rating: 75° C / 600 V Max
 Tolerance $\pm .020$



HOFFMAN PRODUCTS

20700 Hubbell Avenue, Oak Park, MI 48237

Tel: 1-800-645-2014 • Fax: 1-800-908-1295

Web: www.hoffmanproducts.com

NO.	1	2	3
NAME	TERMINAL	INSULATOR	FUNNEL ENTRY
MAT'L. / SPEC	COPPER	VINYL	
REMARKS	TIN-PLATED	RED	
APPROVED BY:	CHECKED BY:	DRAWN BY:	

DATE:	TITLE: Ring Terminal Vinyl Insulated	
SCALE: FREE	PART NO. FVL2216-5R2	
DRAWING NO. H1506	PART NAME	ISSUE

HOFFMAN CADFILE