



REVERSING CONTACTOR COMBINATION AC-3 18.5
KW/400V,
SIZE S2 AC 110 V 50 HZ/120 V 60HZ

General details:

Product function		reversing contactor
Size of the contactor		S2
Width	mm	120
Height	mm	133
Depth	mm	115
Item designation		
• according to DIN EN 61346-2		Q
• according to DIN 40719 extendable after IEC 204-2 / according to IEC 750		K

Control circuit:

Type of voltage / of the controlled supply voltage		AC
Control supply voltage / 1		
• at 50 Hz / for AC		
• rated value	V	120
• at 60 Hz / for AC		
• rated value	V	120
Control supply voltage frequency		
• 1 / rated value	Hz	60
• 2 / rated value	Hz	60

Main circuit:**Operating current / at AC-3 / at 400 V**

- rated value

A

40

Service power / at AC-3 / at 400 V

- rated value

kW

18.5

Auxiliary circuit:**Number of NC contacts / for auxiliary contacts / per direction of rotation**

0

Number of NO contacts / for auxiliary contacts / per direction of rotation

0

Connection type:**Design of the electrical connection / for main current circuit**

screw-type terminals

Type of mounting

screw and snap-on mounting onto 35 mm standard mounting rail according to DIN EN 50022

Ambient conditions:**Ambient temperature**

- during operating

°C

-25 ... +60

Protection class IP / on the front

IP20

Certificates/approvals:**General Product Approval****Declaration of Conformity****Shipping Approval****Shipping Approval** other
[Confirmation](#)
[other](#)
Further information:**Information- and Downloadcenter (Catalogs, Brochures,...)**
<http://www.siemens.com/industrial-controls/catalogs>
Industry Mall (Online ordering system)
<http://www.siemens.com/industrial-controls/mall>
CAX-Online-Generator
<http://www.siemens.com/cax>

NSK00777

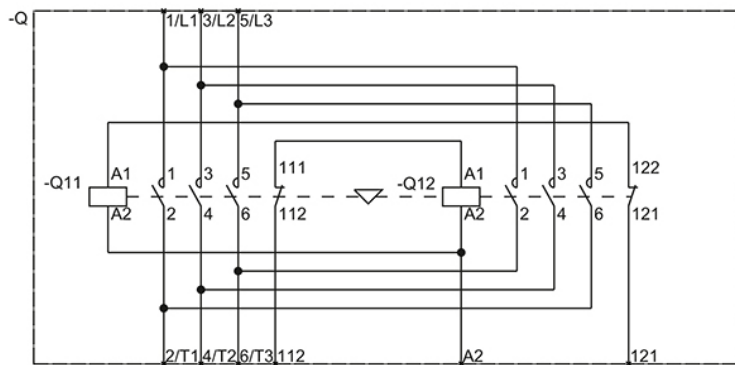
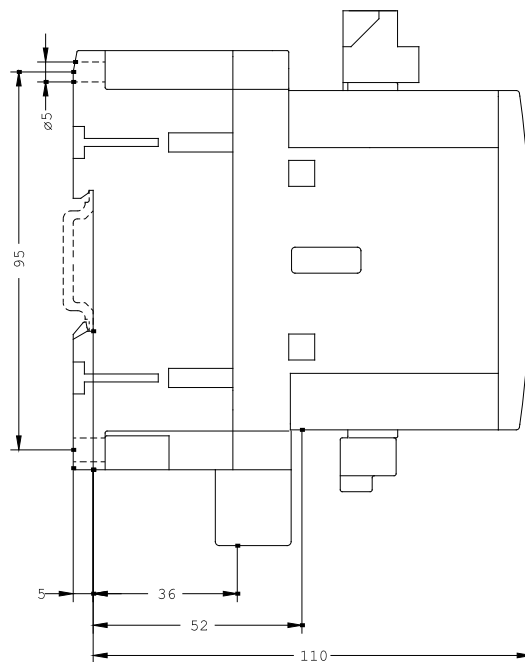
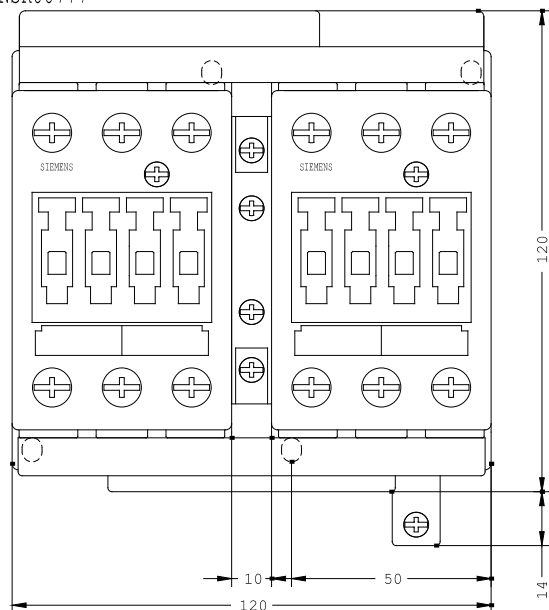

last change:

Apr 13, 2012