

Materials and Finish

Housing Material-
Hight Temp material
UL 94V-0 Rated
Color: Black

Reflow Process Compatible

Contact Material-
Phosphor Bronze

Contact Plating Options-
Standard: 0.0001" Nickel
Plating, Selective Plating
0.000015" Gold on Contact
Area tin on termination end

50: 0.0001" Nickel Plating,
Selective Plating 0.000050"
Gold on Contact Area to
Comply with FCC Requirements
Under No. 47 C.F.R. Part 68,
Subpart F tin on termination end

Electrical Characteristics

Current Rating-
1.0 Amps

Voltage Rating-
125V DC

Insulation Resistance-
500 Megohms Min.

Dielectric Withstanding Voltage-
1000V rms, 60Hz

Contact Resistance-
20 milliohms Max.

Operating Temperature-
-40°C to +85°C

Durability Rating-
500 mating cycles min.

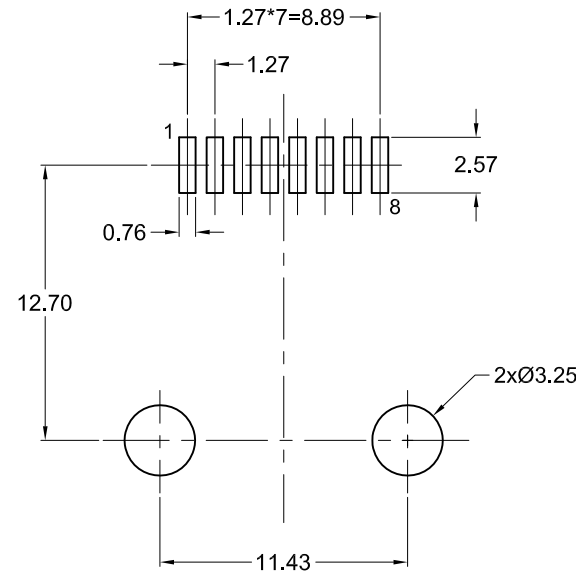
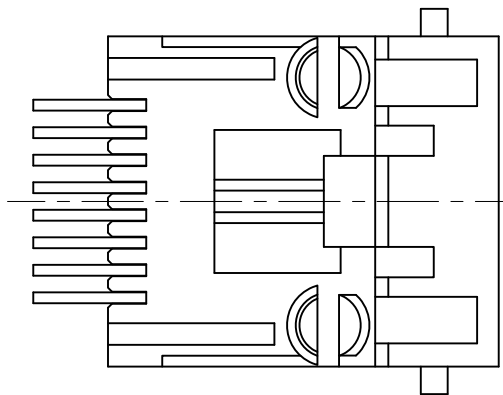

Recommended PCB Layout
(Top View)

Part Number	Contact Area Plating Finish
GDLX-SMT-A-88	15u" Gold (standard)
GDLX-SMT-A-88-50	50u" Gold (50 option)

RoHS COMPLIANT
EU Directive 2002/95/EC

UL
E134345

CS
LR78160

Tolerances
X.X ± 0.25
X.XX ± 0.15
Unless Stated Otherwise

REV.	DATE	DESCRIPTION	REV. BY	CHK. BY	DRAWN BY	DATE
A1	07/08/05	New Drawing	R. Aguirre	H. MA	R. Aguirre	05/19/05
A2	05/03/10	ECO #10-020	S. Vien	H. MA		
A3	10/23/12	ECO #12-065	S. Vien	P. DalCanto		
A4	11/06/13	ECO #13-084	W. Cook	H. MA		

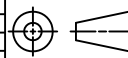

UNITS
mm

GDLX-SMT-A-88

Modular Jack, Right Angle, SMT, RoHS Compliant

8 Positions, 8 Contacts, Non-Shielded



Mouser Electronics

Authorized Distributor

Click to View Pricing, Inventory, Delivery & Lifecycle Information:

[Kycon:](#)

[GDLX-SMT-A-88](#) [GDLX-SMT-A-88-50](#)