

DCP #	REV	DESCRIPTION	DRAWN	DATE	CHECKD	DATE	APPRVD	DATE
1269	A	RELEASED	JWM	12/2/02	HO	12/2/02	DJC	12/2/02
1811	B	RoHS ADDED	DCM	12/22/05	JWM	12/22/05	JWM	12/22/05

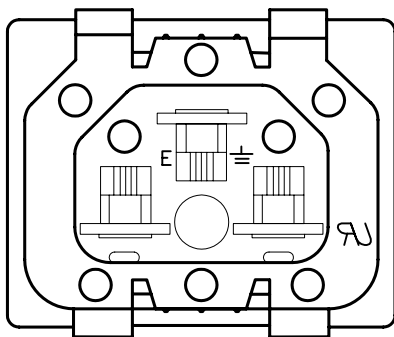
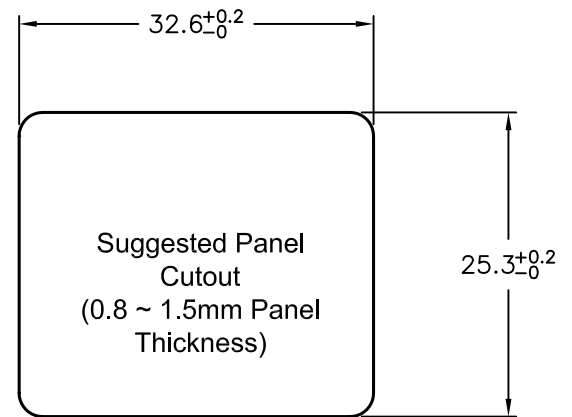
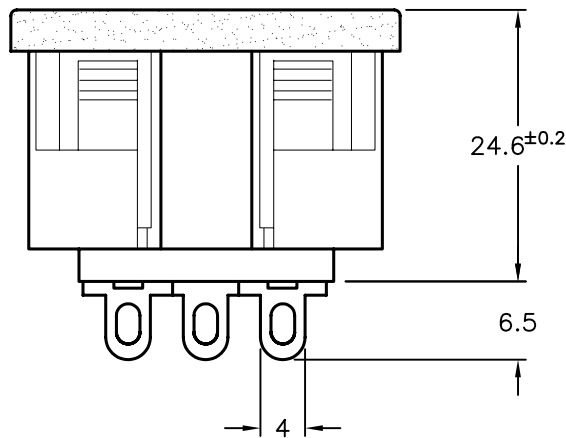
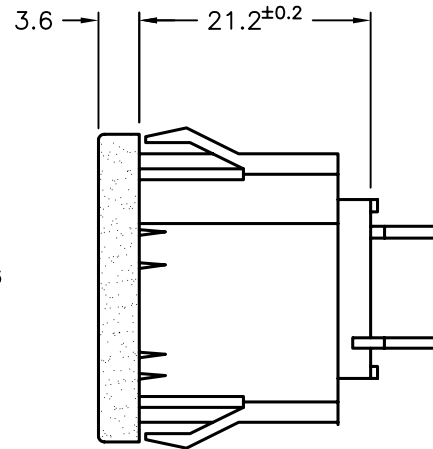
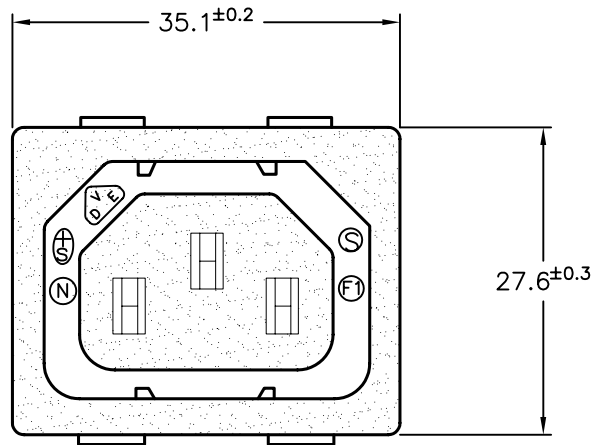

## Material:

Housing: Thermoplastic  
Terminal: Copper Alloy

## Characteristics:

Rating: 15A 250V AC  
Insulation Resistance: Over 100 MegOhm 500VDC  
Dielectric Strength: 2000VAC One Minute  
Approvals: UL, CSA  
Rating: 10A, 250VAC  
VDE, SEMKO, DEMKO,  
NEMKO, SETI, CB and SEV, FIMKO

SPC-F004.DWG

TOLERANCES:  UNLESS OTHERWISE SPECIFIED, DIMENSIONS ARE FOR REFERENCE PURPOSES ONLY.	DRAWN BY:	DATE:	DRAWING TITLE:			
	Jeff McVicker	12/2/02	Snap-In AC Power Outlet IEC 320 - C13			
	CHECKED BY:	DATE:	SIZE	DWG. NO.	ELECTRONIC FILE	REV
	Hisham Odish	12/2/02	A	2155	92N4158	B
	APPROVED BY:	DATE:	SCALE: NTS		U.O.M.: INCHES [mm]	SHEET: 1 OF 1
	Daniel Carey	12/2/02				