

| DCP # | REV | DESCRIPTION         | DRAWN | DATE    | CHECKD | DATE     | APPRVD | DATE     |
|-------|-----|---------------------|-------|---------|--------|----------|--------|----------|
| 1199  | B   | Redrawn and renamed | JWM   | 11/9/01 | JC     | 11/26/01 | JC     | 11/26/01 |
| 1745  | C   | UL No. Corrected    | JWM   | 7/6/05  | HO     | 7/6/05   | HO     | 7/6/05   |

### NOTES:

1. MATERIAL: ELECTRO-TIN PLATED COPPER  
WITH NYLON 6/6 FULL SLEEVE.
2. FLAMMABILITY: UL94V-2
3. VOLTAGE RATING: 600 V
4. OPERATING TEMP: -40°F to 221°F (-40°C ~ 105°C)

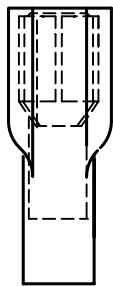

Style 1

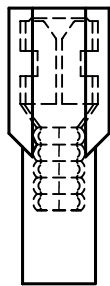

Style 2



OSHA  
Acceptable

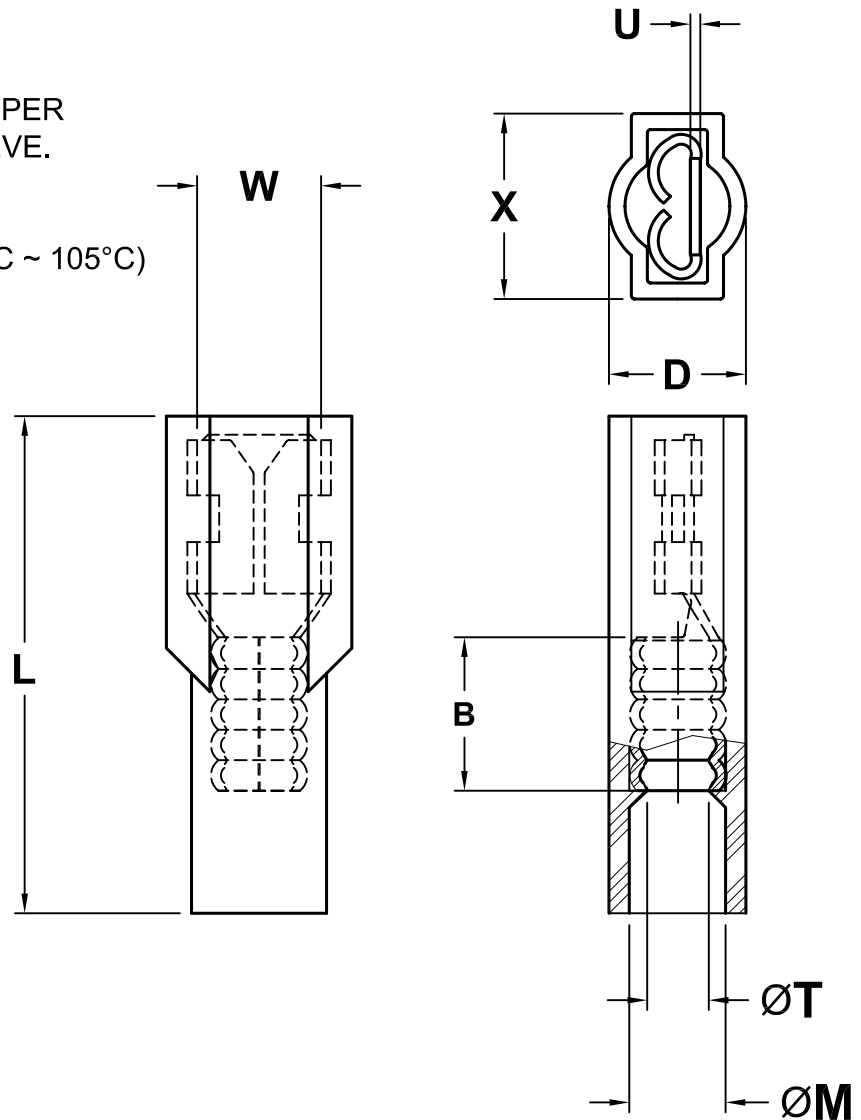

| PART NUMBER   | WIRE RANGE (AWG) | MATES WITH MALE TAB WIDTH (W') X THICKNESS | L   | X   | D   | B   | T    | M    | U    | COLOR  | STYLE |
|---------------|------------------|--|-----|-----|-----|-----|------|------|------|--------|-------|
| CFS-TF-1025   | 12-10            | .250 x .032                                | .99 | .39 | .32 | .25 | .148 | .250 | .020 | YELLOW | 1     |
| CFS-TF-1418   | 16-14            | .187 x .020                                | .81 | .30 | .23 | .25 | .085 | .145 | .020 | BLUE   | 2     |
| CFS-TF-1425   | 16-14            | .250 x .032                                | .91 | .37 | .23 | .25 | .080 | .170 | .020 | BLUE   | 1     |
| CFS-TF-1818   | 22-18            | .187 x .020                                | .81 | .30 | .23 | .25 | .085 | .145 | .020 | RED    | 2     |
| CFS-TF-1825   | 22-18            | .250 x .032                                | .91 | .37 | .23 | .25 | .080 | .170 | .020 | RED    | 1     |
| CFS-TF-2012 † | 26-20            | .110 x .020                                | .66 | .22 | .15 | .13 | .055 | .093 | .012 | YELLOW | 1     |

SPC-F004.DWG

† NOT UL LISTED OR CSA CERTIFIED

|  |              |          |  |          |                     |                 |     |
|--|--------------|----------|--|----------|---------------------|-----------------|-----|
| TOLERANCES:<br><br>Tolerances: Unless<br>Otherwise Specified:<br>.X = ±.015<br>.XX = ±.010<br>.XXX = ±.005 | DRAWN BY:    | DATE:    | DRAWING TITLE:                                 |          |                     |                 |     |
|  | JC           | 3/11/91  | Fully Insulated Butted Seam Female Disconnects |          |                     |                 |     |
|  | CHECKED BY:  | DATE:    | SIZE   | DWG. NO. |                     | ELECTRONIC FILE | REV |
|  | JOHN COLE    | 12/10/91 | A  | TA-443   |                     | TA-443.dwg      | C   |
|  | APPROVED BY: | DATE:    | SCALE: NTS                                     |          | U.O.M.: INCHES [mm] | SHEET: 1 OF 1   |     |
|  | John Liska   | 12/10/91 |  |          |                     |                 |     |

ALL RIGHTS RESERVED. NO PORTION OF THIS PUBLICATION, WHETHER IN WHOLE OR IN PART CAN BE REPRODUCED WITHOUT THE EXPRESS WRITTEN CONSENT OF SPC TECHNOLOGY. DISCLAIMER: ALL STATEMENTS AND TECHNICAL INFORMATION CONTAINED HEREIN ARE BASED UPON INFORMATION AND/OR TESTS WE BELIEVE TO BE ACCURATE AND RELIABLE. SINCE CONDITIONS OF USE ARE BEYOND OUR CONTROL, THE USER SHALL DETERMINE THE SUITABILITY OF THE PRODUCT FOR THE INTENDED USE AND ASSUME ALL RISK AND LIABILITY WHATSOEVER IN CONNECTION THEREWITH.