

PRODUCT



Keyhole is set on bottom side to prevent a picking of key. Master key or standard key of Japan Vending Machine Manufactures Association can be set as a custom made product.

Vending machines / Exchange machines

Operational angle of key is 90-degree between point A and point B.
Key can be inserted or taken off at point A only, 1-point take off.

Available with different key No product only, however, the key No can not be specified.

The lock bolt shall be come out by inserting the key and turning it right 90-degree to make it unlock. After the unlock operation, the key can be taken off by turning it back. The lock bolt should be pressed in securely until the end to make it lock. Single touch mechanism makes no key operation necessary to make it lock.

Model No.	Net Weight (g)	Code No.	
TL-328		1945	

No.	Part Name	Material	Finish	Quantity
1	Body (1)	SCS13	Electrolytic Polishing	1
2	Body (2)			1
3	Lock Bolt	SUS303	—————	1
4	Back Plate	SPCC	Zn	2
5	Packing	PP	Black	2
6	Set Screw with Hexagon Hole	S	Zn (Black)	4
7	Hexagon Nut	SWRM	Zn	4
8	Spring Washer	S		4
9	Lock	BSBM/SPCC	Cr/Zn	1
10	Key	BSP	Ni	2

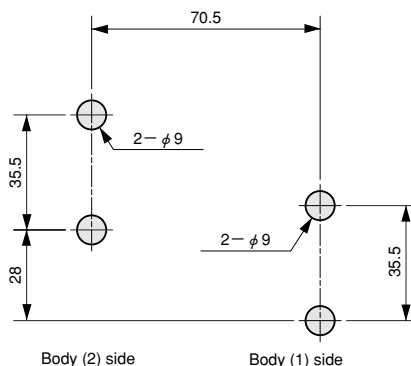
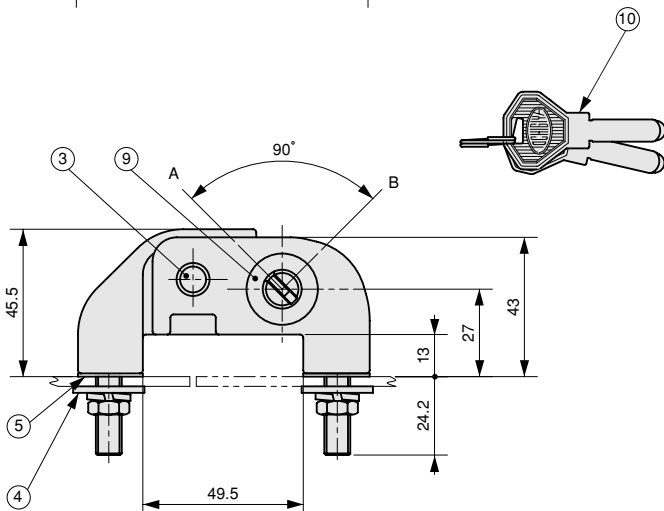
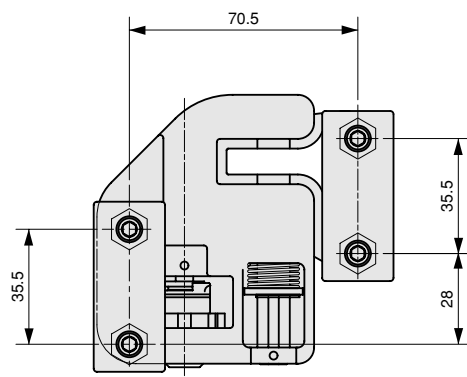
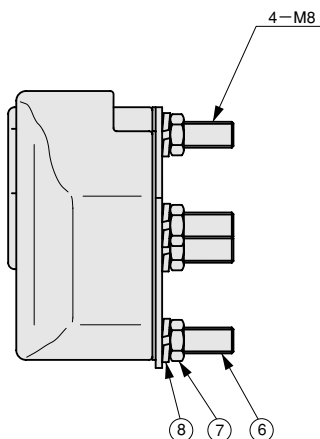
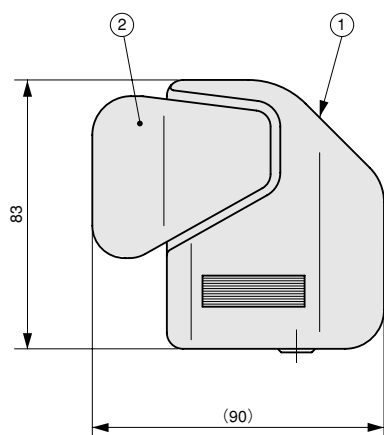
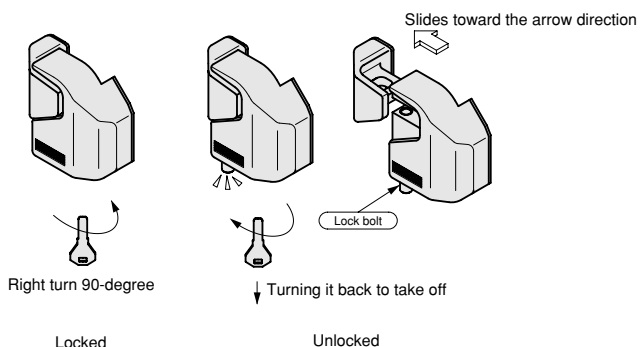

Layout of Holes for Installation